

Street: ~~SE~~ LENOX AVE
 X-Street: ~~DATA~~ AVE
 OFFICIAL USE ONLY

HISTORICAL DATA FB 553/12511	SWING TIES	OPEN FRY THORP MUSSELL NEA JUN 2, 1972 FB 553/173
FB 953/12511		FB 950/78

- LEGEND**
- ① FD. NAIL AND CITY ENGR. TAG IN E-SEIN. REF FB 553/111
 - ② FD. NAIL AND CITY ENGR. TAG FLUSH. REF FB 553/111
 - ③ FD. NAIL AND CITY ENGR. TAG FLUSH. REF FB 553/111
 - ④ FD. NAIL AND CITY ENGR. TAG FLUSH OVER 2" R2 AND TAG
2.5" BGC ON 1/2" SEE FB 553/111

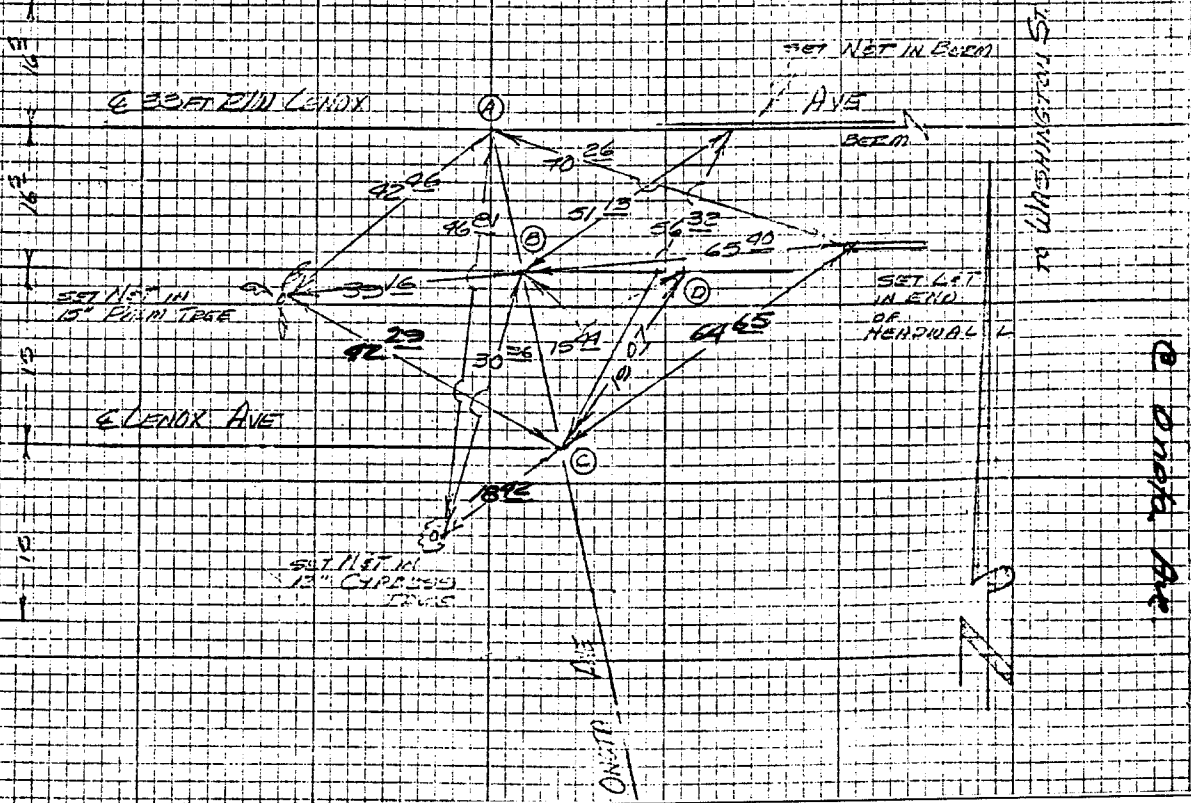

- ✕ FD. Ramset Nail on T/C
- FD. LD. & TK. on T/C
- FD. "C" Nail on T/C
- Set LD. & TK. on T/C

Scale:
 Date:
 Drawn by:
 W.O.:
 F.B.:

OFFICIAL TIE PLAT

CITY OF RIVERSIDE

These ties are for the purpose of perpetuating the found monumentation. No claim is made as to the relationship of the points or lines shown hereon to true boundary locations.

Sheet 1 of 1
 File No.: