

HISTORICAL DATA

A.A. WEBB
FB 1032/189
TRACT 5677-2

TRANSIT TIES

MB 84/76-78

CREW

AGUILERA
EVANS
DUNHAM
12-2-76

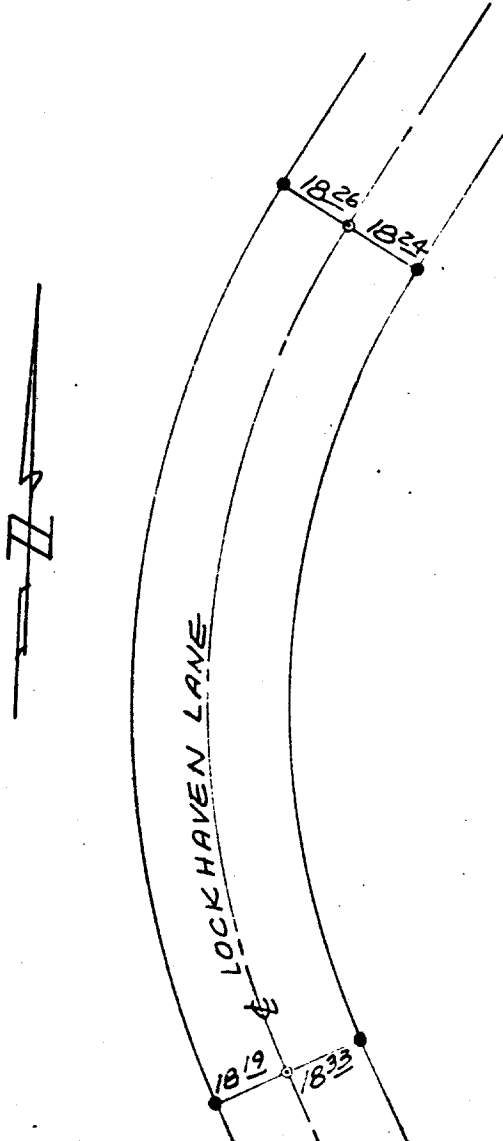

- SET 1" IP-FLUSH TAGGED RCE 9876
- SET STUD & TAG RCE 9876 1/4" TOP OF CURB

BET MIDLAND & CULLEN

- ✕ FD. Ramset Nail on T/C
- FD. "C" Nail on T/C

- FD. LD. & TK. on T/C
- Set LD. & TK. on T/C

Street: LOCKHAVEN LN.
X-Street: EC & BC Btw Midland & Cullen
OFFICIAL USE ONLY

Scale:
Date:
Drawn by:
W.O.:
F.B.:

OFFICIAL TIE PLAT

CITY OF RIVERSIDE

These ties are for the purpose of perpetuating the found monumentation. No claim is made as to the relationship of the points or lines shown hereon to true boundary locations.

Sheet 1 of 1
File No.: