

SWING TIES

X-STREET 2ND BC WLY OF CHEQUES CT  
OFFICE USE ONLY  
STREET LYNDHURST DRIVE

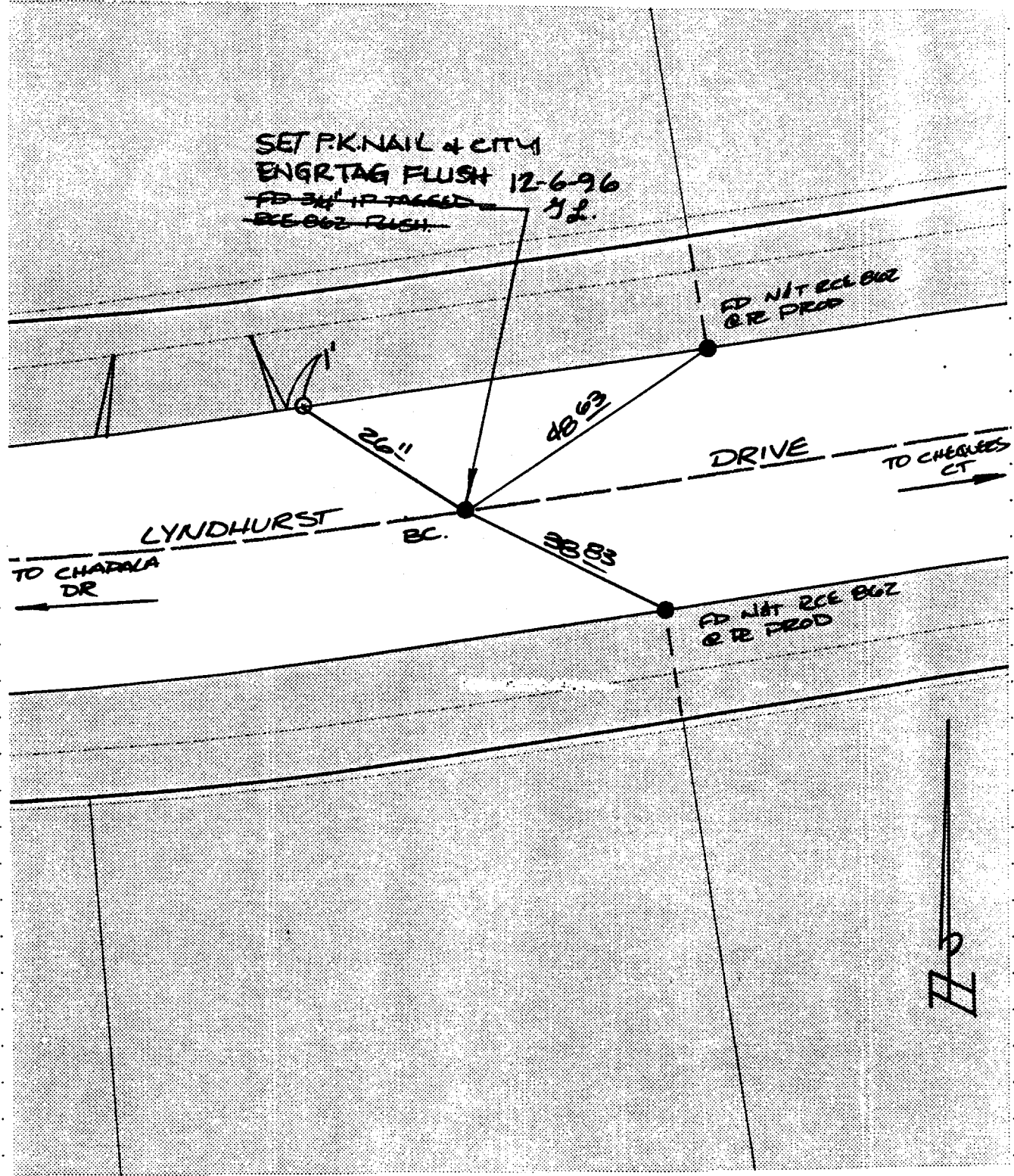

- ✕ FD. Ramset Nail on T/C
- FD. LD. & TK. on T/C
- FD. "C" Nail on T/C
- SET LD. & TK. On T/C

SCALE: 1" = 20'  
 DATE: 7/12/96  
 DR. BY: Cuet  
 W.O.:  
 F.B.:

**OFFICIAL TIE PLAT**  
 CITY OF RIVERSIDE

*These ties are for the purpose of perpetuating the found monumentation. No claim is made as to the relationship of the points or lines shown hereon to true boundary locations.*

SHEET  
 /  
 OF / SHEETS  
 FILE NO.: