

SWING TIES

STREET LYNDHURST DR. X-STREET 2ND E.C. N/4Y OF BLAKEWOOD ST
 OFFICE USE ONLY

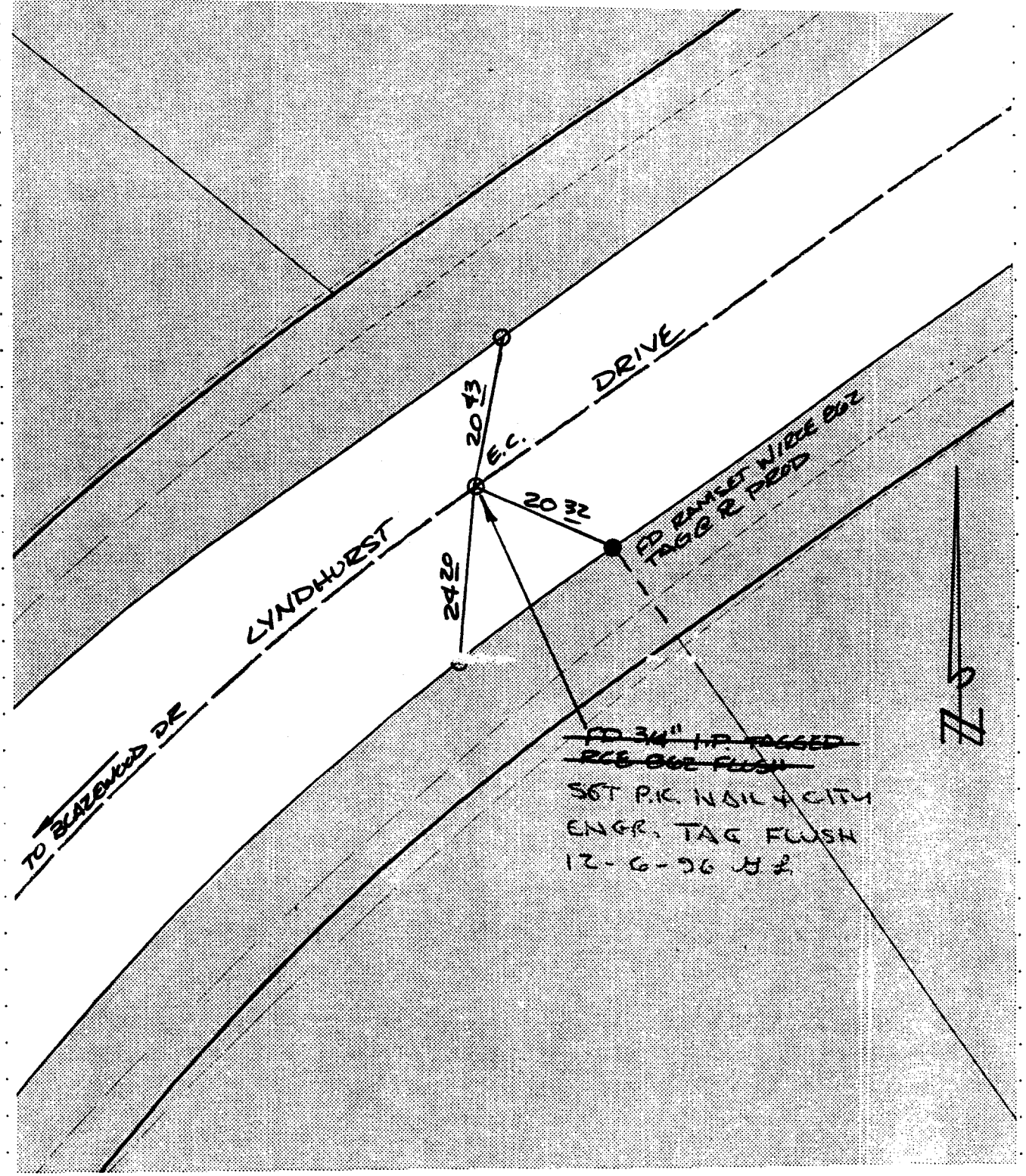

- ✕ FD. Ramset Nail on T/C
- FD. LD. & TK. on T/C
- FD. "C" Nail on T/C
- SET LD. & TK. On T/C

FD 3/4" I.P. TAGGED
 PCE 862 FLUSH
 SET P.K. NAIL & CITY
 ENGR. TAG FLUSH
 12-6-96 JZ

ZS

SCALE: 1" = 20'
 DATE: 7/11/96
 DR. BY: Cuet
 W.O.:
 F.B.:

OFFICIAL TIE PLAT
 CITY OF RIVERSIDE

These ties are for the purpose of perpetuating the found monumentation. No claim is made as to the relationship of the points or lines shown hereon to true boundary locations.

SHEET
 OF SHEETS
 FILE NO.: