

4829.TIF

Street: LIME ST.

X-Street: FIRST ST & POPLAR
OFFICIAL USE ONLY

HISTORICAL DATA	TRANSIT TIES	CREW
MS 7/11 FB 1033/12 FB 1033/16		GARCIA CONNER CRONIN 2071
		FEB. 4, 1983
		FB 1037/62

● INDICATES SET 60° SPV & CITY ENGR TAG
FLUSH W/ X-TIES, PER. TIE SH. FB 1033/66

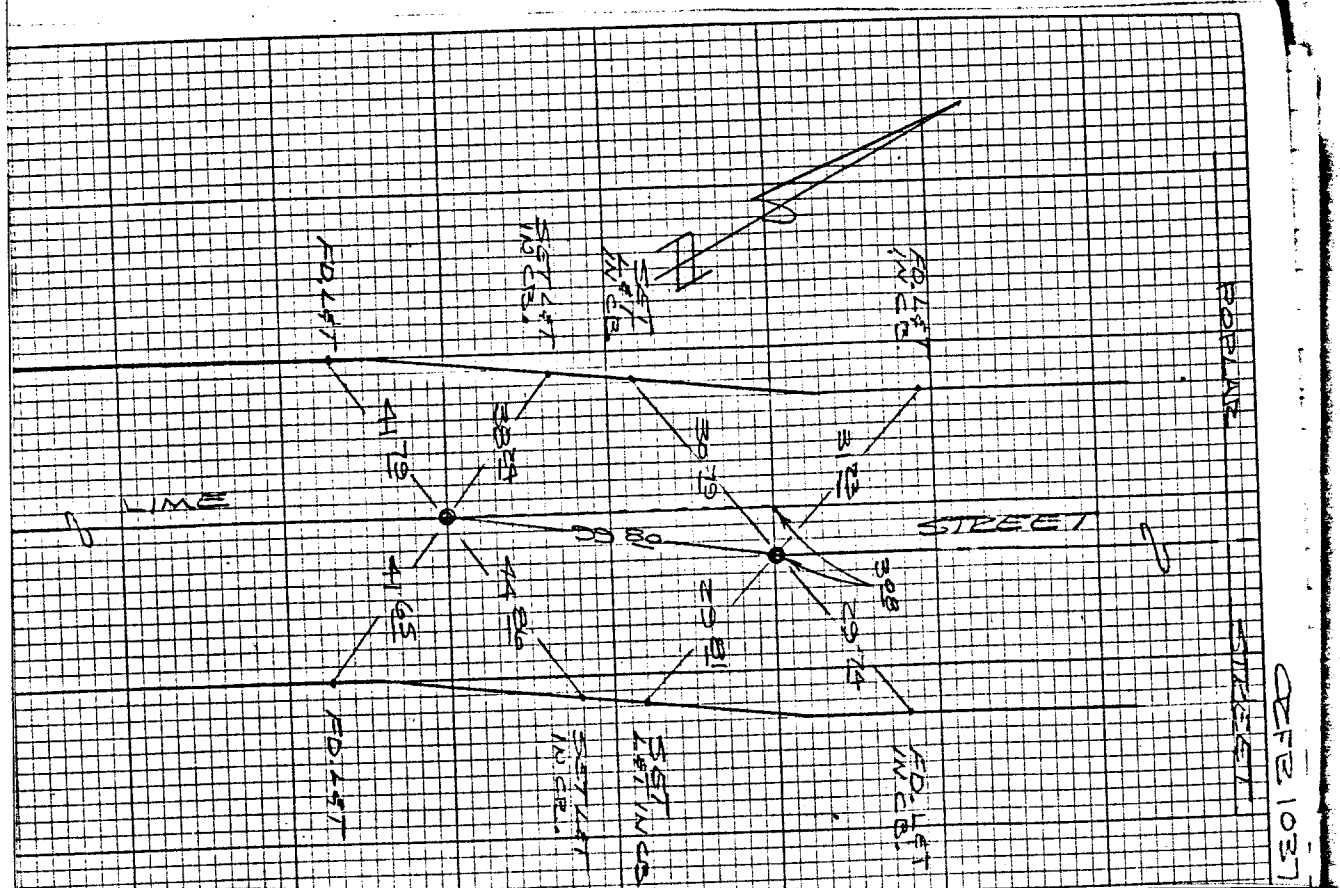

- ✕ FD. Ramset Nail on T/C
- FD. LD. & TK. on T/C
- FD. "C" Nail on T/C
- Set LD. & TK. on T/C

Scale:
Date:
Drawn by:
W.O.:
F.B.:

OFFICIAL TIE PLAT
CITY OF RIVERSIDE

These ties are for the purpose of perpetuating the found monumentation. No claim is made as to the relationship of the points or lines shown hereon to true boundary locations.

Sheet 1 of 1
File No.: