

4839, TIF

Street: LIME ST.

X-Street: 11 TH ST.  
OFFICIAL USE ONLY

HISTORICAL DATA FB 926/62	TRANSIT TIES	CREW: STEELE FRYC NEW SEPT 1, 71 ES
------------------------------	--------------	--

CRFB 952/53 SEPT 1, 1971

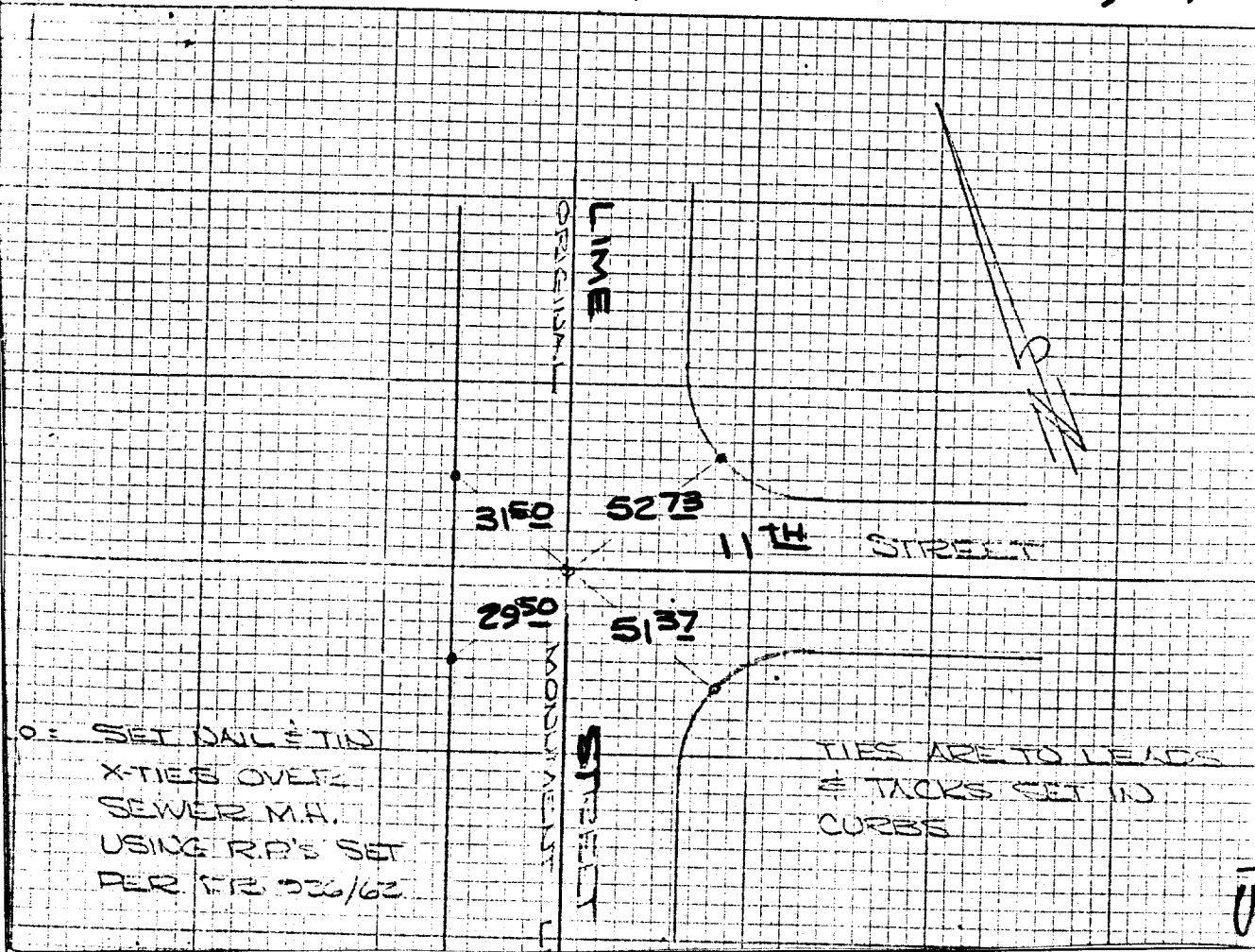

Scale:  
Date:  
Drawn by:  
W.O.:  
F.B.:

## OFFICIAL TIE PLAT CITY OF RIVERSIDE

*These ties are for the purpose of perpetuating the found monumentation. No claim is made as to the relationship of the points or lines shown hereon to true boundary locations.*

Sheet 1 of 1  
File No.: