

Street: KELLY ST X-Street: ARLINGTON AVE  
 OFFICIAL USE ONLY

KELLY ST  
 @ ARLINGTON AVE  
 - TIE SHEET -

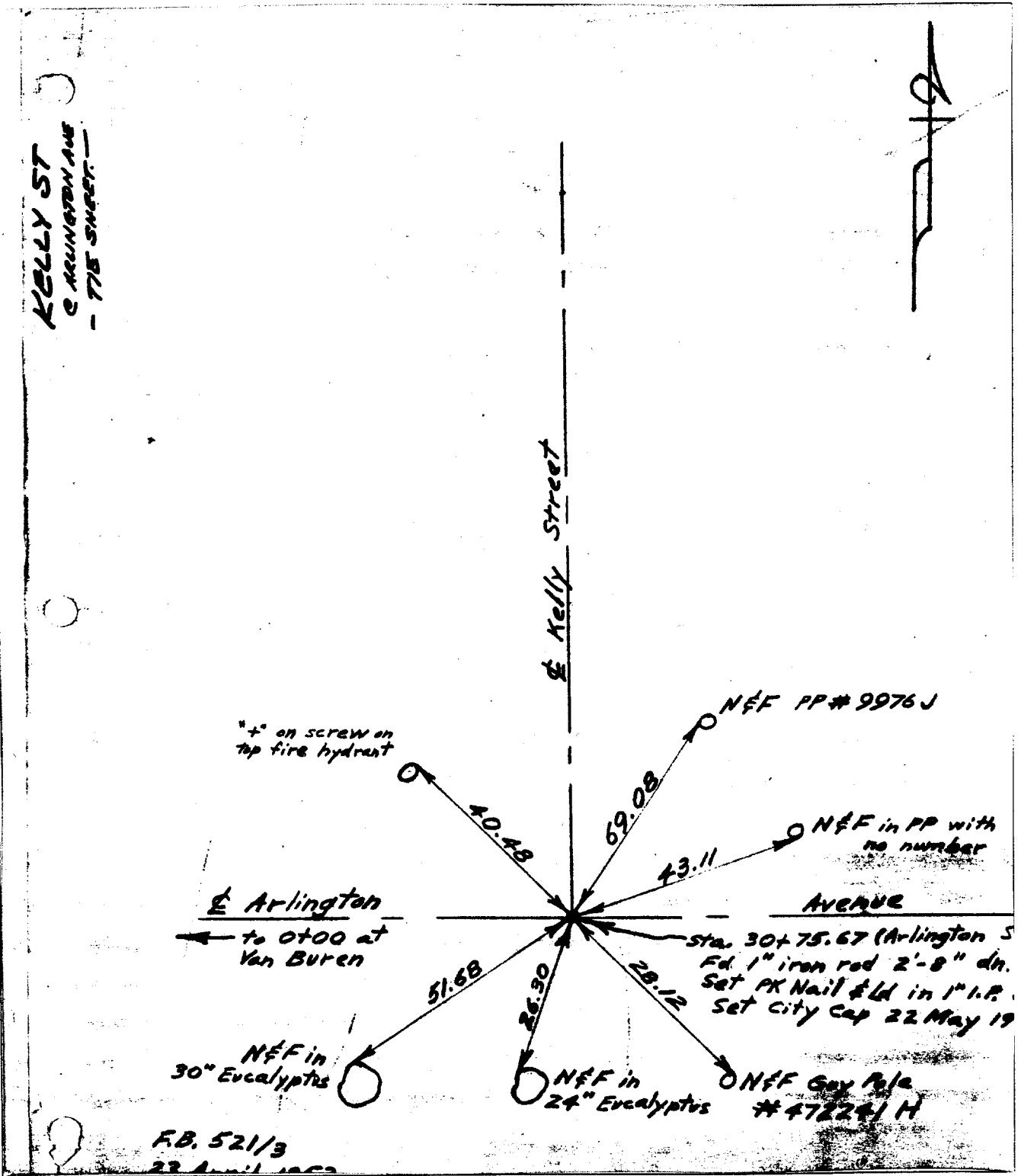

F.B. 521/3  
 23 April 1952

- ✕ FD. Ramset Nail on T/C
- FD. LD. & TK. on T/C
- FD. "C" Nail on T/C
- Set LD. & TK. on T/C

Scale:  
 Date: APRIL 23 1952  
 Drawn by:  
 W.O.:  
 F.B.: 521/3

## OFFICIAL TIE PLAT

### CITY OF RIVERSIDE

*These ties are for the purpose of perpetuating the found monumentation. No claim is made as to the relationship of the points or lines shown hereon to true boundary locations.*

Sheet 1 of 1  
 File No.: