

5245.TIF

SWING TIES

HISTORICAL DATA  
CRFB 615/20  
FAGG SUB. MB. 34/20

Street:

MELROSE ST.  
CAL-DE-SAC R.P.

X-Street: OFFICIAL USE ONLY

S.E. OF CALIFORNIA AVE.

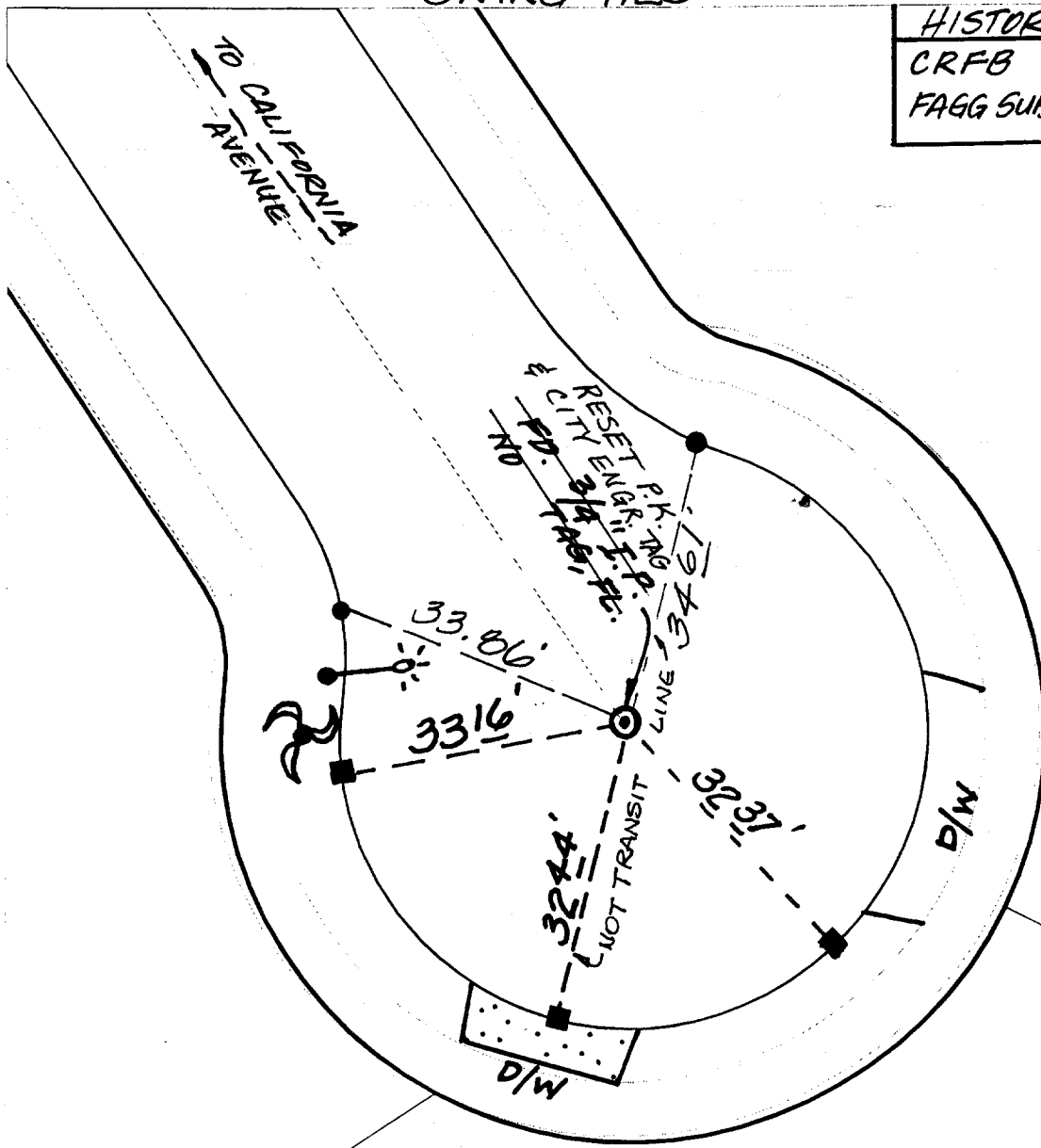

- × FD. Ramset Nail on T/C
- FD. LD. & TK. on T/C
- FD. "C" Nail on T/C
- Set LD. & TK. on T/C

Scale: 1" = 20'  
 Date: 08/23/99  
 Drawn by: L. Harris, KGE  
 W.O.:  
 F.B.:

## OFFICIAL TIE PLAT

### CITY OF RIVERSIDE



*These ties are for the purpose of perpetuating the found monumentation. No claim is made as to the relationship of the points or lines shown hereon to true boundary locations.*

Sheet of  
File No.: