

5252.T1R

J. F. DAVIDSON ASSOCIATES  
CIVIL ENGINEERS • SURVEYORS • PLANNERS

F.B. 9219/600

SURVEY OF 6-7185

FOR CONCORDIA TR. 20312

W.O.No. 9219

DATE 10-14-87

SURVEY PARTY SEPULVEDA STEAD HERGERA

REF.

A.M.

SURVEY NO. 101

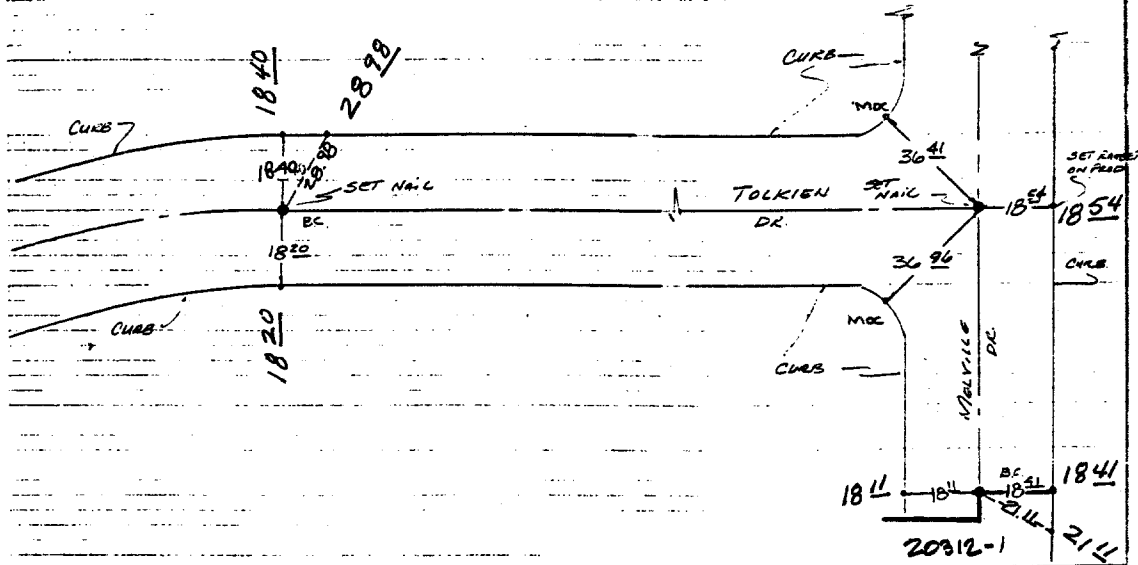

- SET 1" I.P. STAMPED LS 3018 FLUSH.
- SET RAMPET ON T.C.

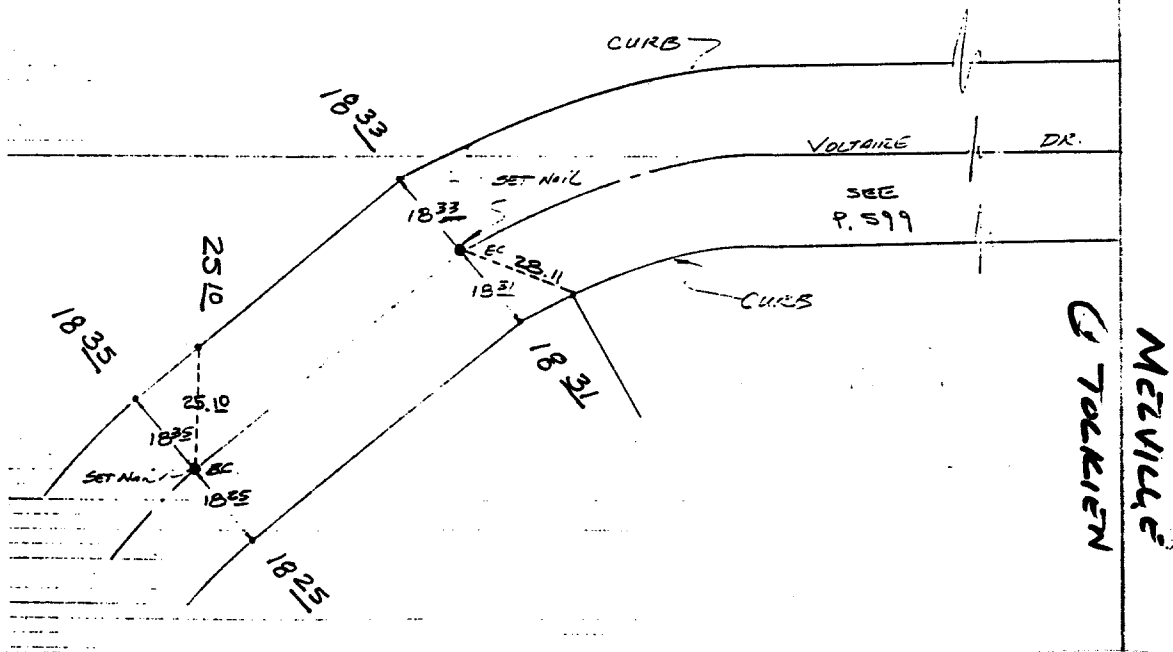

- ✕ FD. Ramset Nail on T/C
- FD. "C" Nail on T/C

- FD. LD. & TK. on T/C
- Set LD. & TK. on T/C

Street: MELVILLE DR.  
X-Street: TOLKIEN & VOLTAIRE  
OFFICIAL USE ONLY

Scale:  
Date:  
Drawn by:  
W.O.:  
F.B.: 9219/600

### OFFICIAL TIE PLAT CITY OF RIVERSIDE

These ties are for the purpose of perpetuating the found monumentation. No claim is made as to the relationship of the points or lines shown hereon to true boundary locations.

Sheet 1 of 1  
File No.: