

R. L. BROWN & ASSOCIATES, INC.  
1442 Irvine Blvd. Suite 125  
TUSTIN, CALIFORNIA 92680  
(714) 669-0972

JOB TRACT NO. 10604  
SHEET NO. 4 OF 4  
CALCULATED BY \_\_\_\_\_ DATE 11/2/87  
CHECKED BY \_\_\_\_\_ DATE \_\_\_\_\_  
SCALE 1" = 40'

Street: METCALF LANE

X-Street: HALLMARK ST  
OFFICIAL USE ONLY

CENTERLINE TIE NOTES

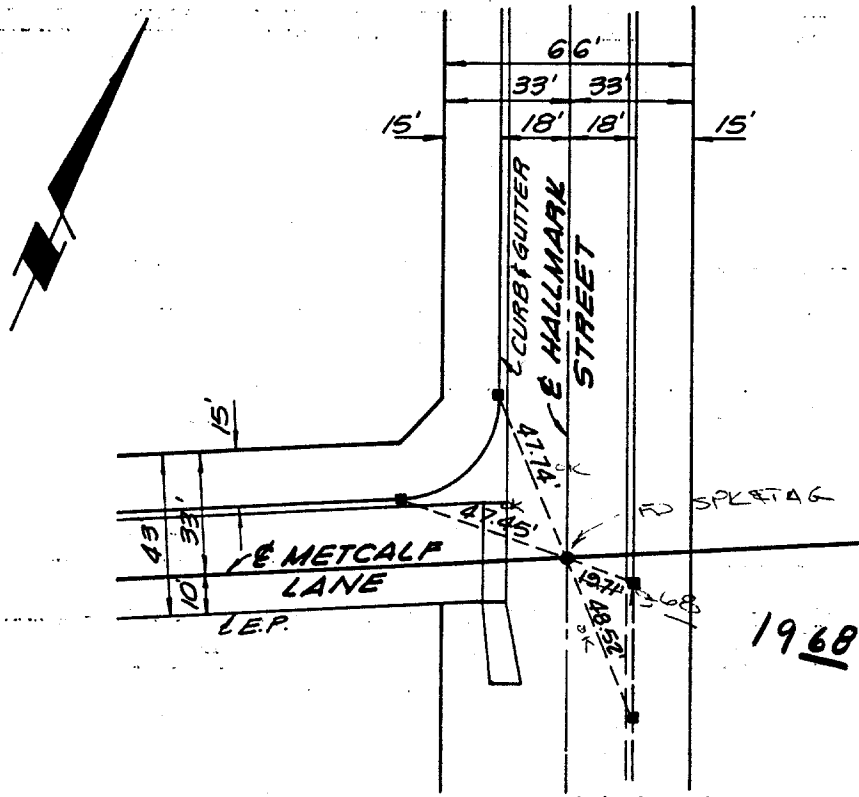

*METCALF LN.  
HALLMARK ST.*

*Richard L. Brown*  
RICHARD L. BROWN  
R.C.E. NO. 16683

- LEGEND**
- LEAD & TACK AS SHOWN
  - 1" I.P. TAGGED R.C.E. 16683

- ✕ FD. Ramset Nail on T/C
- FD. LD. & TK. on T/C
- FD. "C" Nail on T/C
- Set LD. & TK. on T/C

Scale: \_\_\_\_\_  
 Date: \_\_\_\_\_  
 Drawn by: \_\_\_\_\_  
 W.O.: \_\_\_\_\_  
 F.B.: \_\_\_\_\_

**OFFICIAL TIE PLAT**  
CITY OF RIVERSIDE

*These ties are for the purpose of perpetuating the found monumentation. No claim is made as to the relationship of the points or lines shown hereon to true boundary locations.*

Sheet 1 of 1  
File No.: \_\_\_\_\_