

536.72

Street: BANKS DRIVE
X-Street: LOCUST & REDWOOD DR.

BANKS DRIVE
BTW.
LOCUST STREET
REDWOOD DR.

SWING TIES

FAIRMOUNT PARK

6-16-87
POSTS HAVE BEEN
REMOVED. NEW
TIE DISTANCES
ADJ TO NPT'S
SET IN BERM
J.W.S.

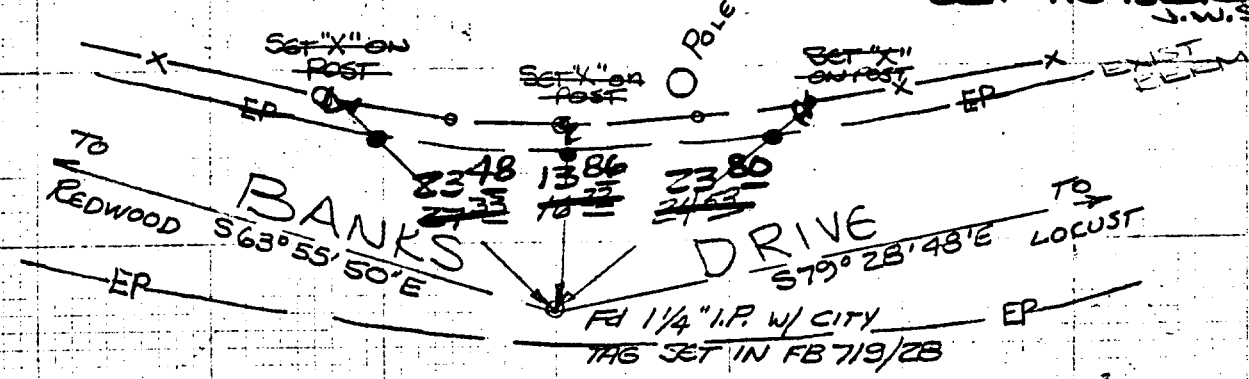

HUTCHINSON OCT 11, 1966
GRANDINETTE
MORGAN FB 719/60

NOTE: THIS POINT IS
THE FIRST P.I. ELY OF
THE WLY LINE OF PARCEL
4-NORTH HILL R/S-UNRECORDED

| ORIGINAL DATA | |
|---------------|----|
| 11/9/28 | 66 |
| | |
| | |

- × FD. Ramset Nail on T/C
- FD. LD. & TK. on T/C
- FD. "C" Nail on T/C
- Set LD. & TK. on T/C

Scale:
Date:
Drawn by:
W.O.:
F.B.:

OFFICIAL TIE PLAT

CITY OF RIVERSIDE

These ties are for the purpose of perpetuating the found monumentation. No claim is made as to the relationship of the points or lines shown hereon to true boundary locations.

Sheet 1 of 1
File No.: