

5376.TIF

J. F. DAVIDSON ASSOCIATES  
CITY ENGINEERS & SURVEYORS & PLANNERS

F.B. 5699/17

SURVEY OF CENTRAL CURVE TIE PLAT  
FOR RECONSTRUCTION OF 1932 W.O. NO. 596 DATE DEC 15 1932  
SURVEY PARTY FLORIAN REF. \_\_\_\_\_ A.M. \_\_\_\_\_

SET RAMSET NAIL TO CURVE FOR E TIES = •

SURVEY NOTES

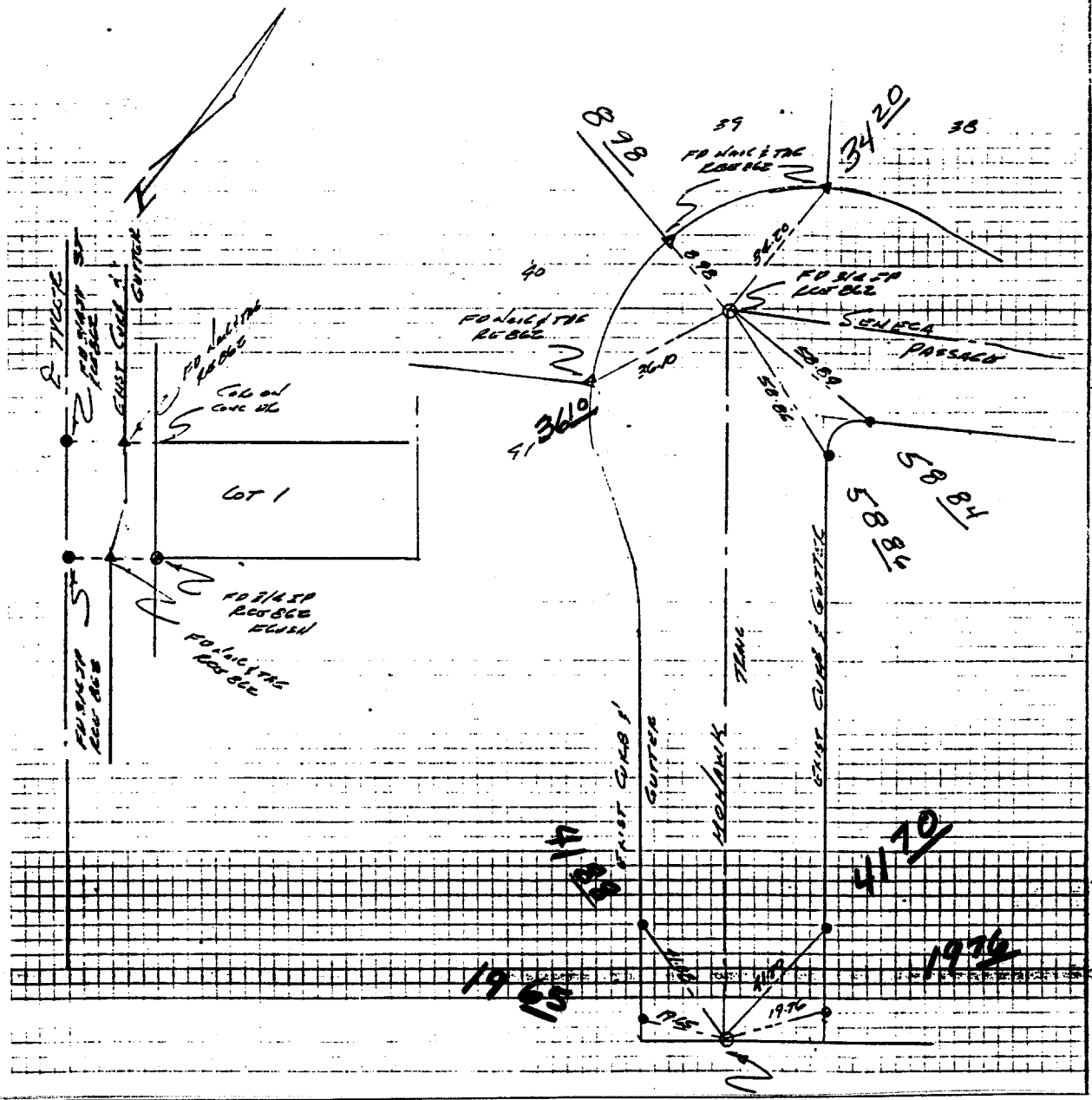

- ✕ FD. Ramset Nail on T/C
- FD. LD. & TK. on T/C
- FD. "C" Nail on T/C
- Set LD. & TK. on T/C

Street: MOHAWK TRAIL E/P X-Street: TYLER  
 OFFICIAL USE ONLY

Scale: \_\_\_\_\_  
 Date: \_\_\_\_\_  
 Drawn by: \_\_\_\_\_  
 W.O.: \_\_\_\_\_  
 F.B.: 5699/17

**OFFICIAL TIE PLAT**  
**CITY OF RIVERSIDE**

*These ties are for the purpose of perpetuating the found monumentation. No claim is made as to the relationship of the points or lines shown hereon to true boundary locations.*

Sheet 1 of 1  
 File No.: \_\_\_\_\_