

HISTORICAL DATA

CRFB 850/47
 " 650/5
 RS 35/18

Street:

HOLE AVENUE

X-Street:

OFFICIAL USE ONLY

DOANE AVENUE
 MINNIER AVE.

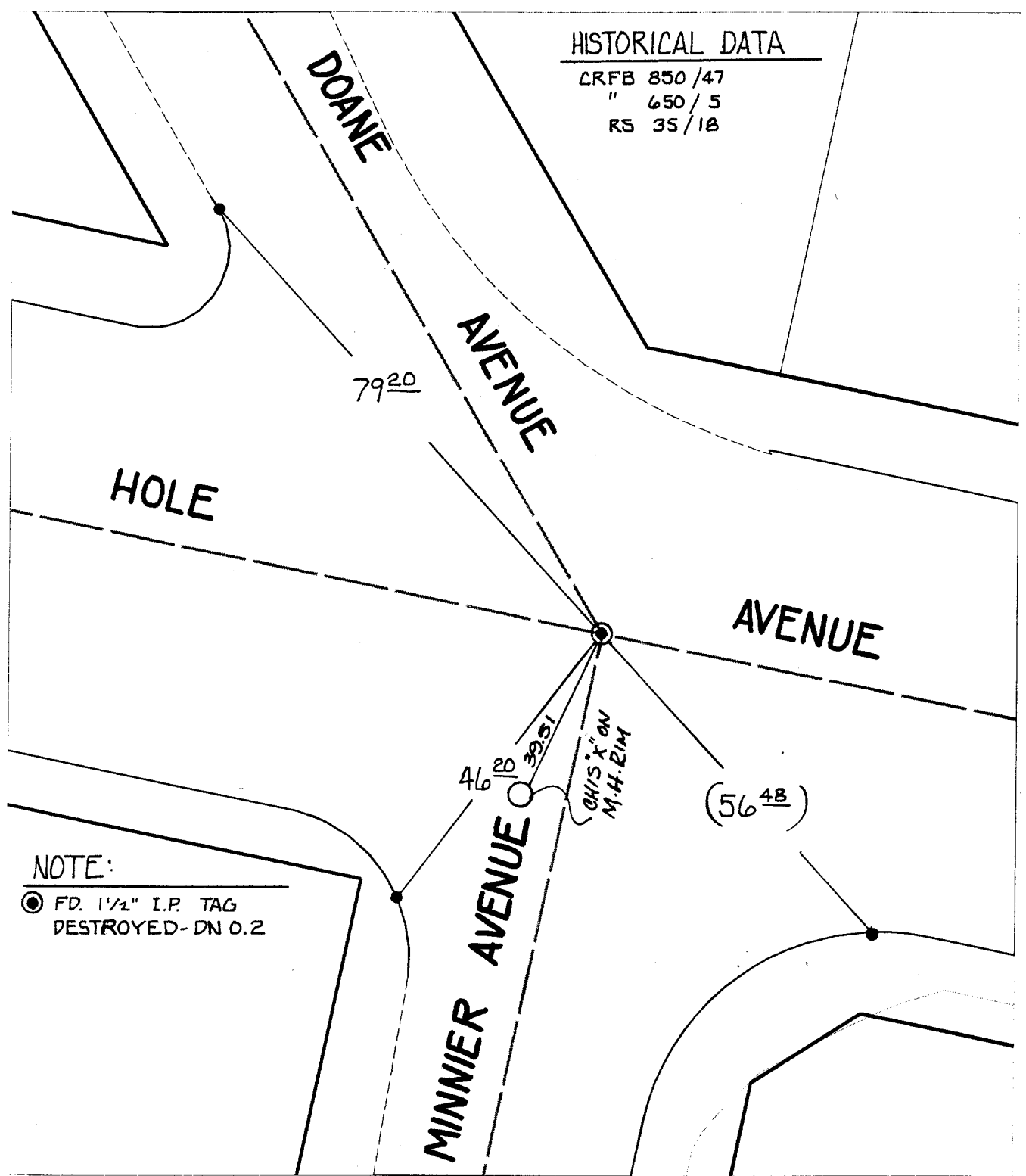

NOTE:
 ● FD. 1 1/2" I.P. TAG
 DESTROYED- DN 0.2

- ✕ FD. Ramset Nail on T/C
- FD. LD. & TK. on T/C
- FD. "C" Nail on T/C
- Set LD. & TK. on T/C

Scale: 1" = 20'
 Date: 12/29/99
 Drawn by: KGE
 W.O.:
 F.B.:

OFFICIAL TIE PLAT
 CITY OF RIVERSIDE

These ties are for the purpose of perpetuating the found monumentation. No claim is made as to the relationship of the points or lines shown hereon to true boundary locations.



Sheet 1 of 1
 File No.: