

5405.T1A

Street: MONTGOMERY ST.

X-Street: _____

TREY

OFFICIAL USE ONLY

MONTGOMERY ST

C TREY
C 206 645

Notes to BRASS DISC
 (32662)
 HUNT HANSON
 32662 Montgomery St
 GRAND MEZE
 GILL

Notes
 TIES ARE TRANSIT TIES

Made for plot
 4-17-62

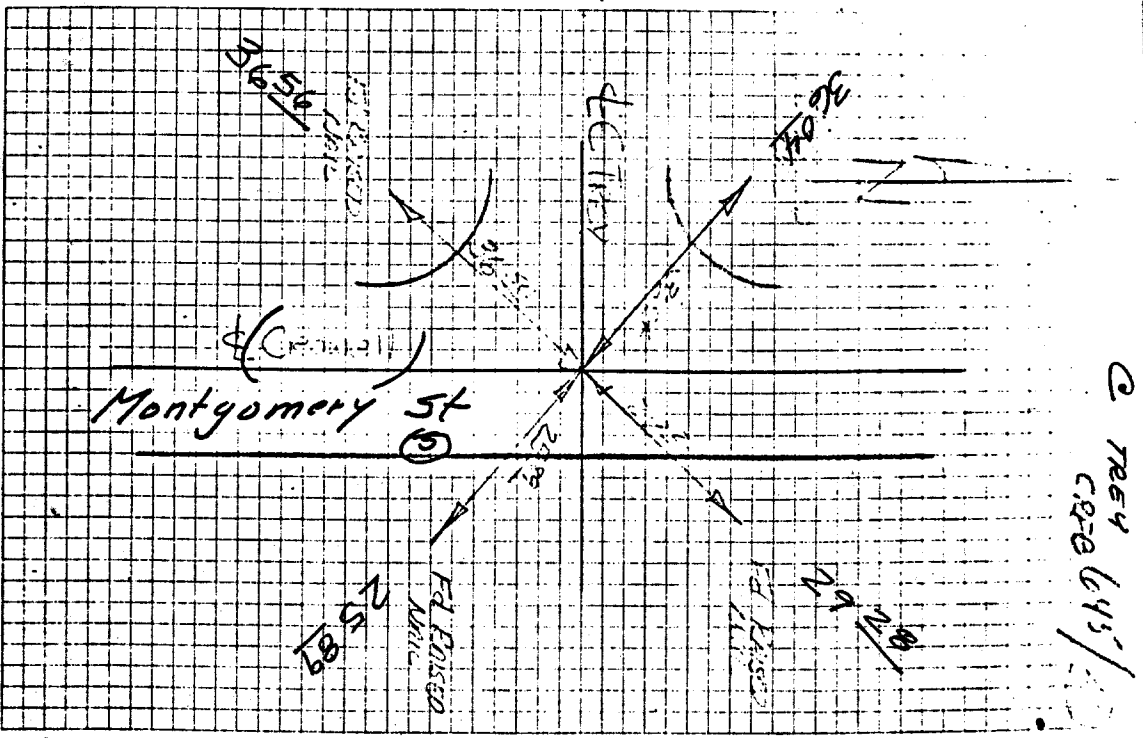

- × FD. Ramset Nail on T/C
- FD. LD. & TK. on T/C
- FD. "C" Nail on T/C
- Set LD. & TK. on T/C

Scale: _____
 Date: _____
 Drawn by: _____
 W.O.: _____
 F.B.: _____

OFFICIAL TIE PLAT
CITY OF RIVERSIDE

These ties are for the purpose of perpetuating the found monumentation. No claim is made as to the relationship of the points or lines shown hereon to true boundary locations.

Sheet 1 of 1
 File No.: _____