

5499.TIF

Street: Magnolia

OFFICIAL USE ONLY

X-Street: Arlington & Palm

MAGNOLIA AVE  
AT  
ARLINGTON &  
PALM

REF. F.B.L. <sup>802</sup> / 27  
"TRANSIT TIE" P

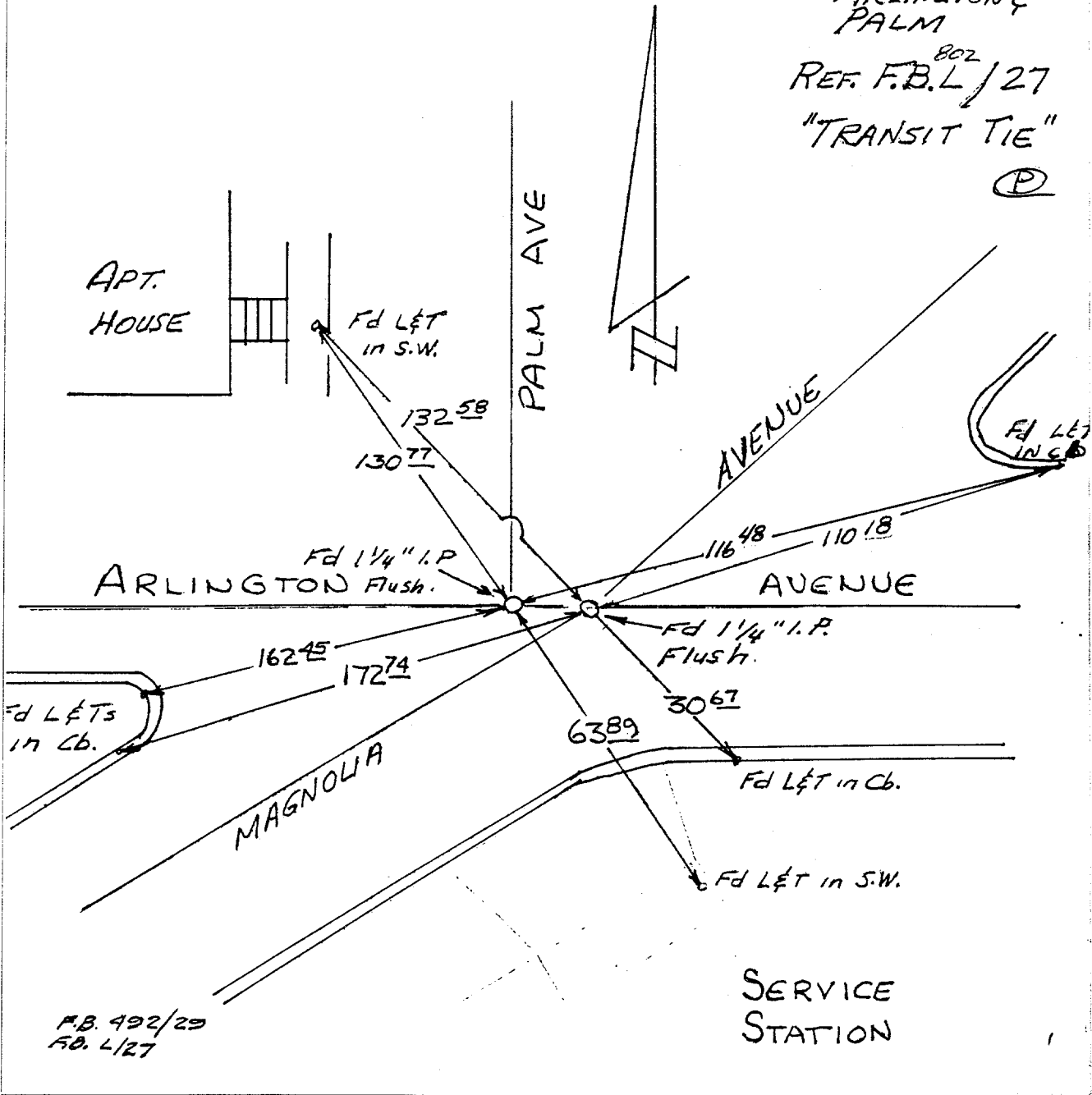

- ✕ FD. Ramset Nail on T/C
- FD. "C" Nail on T/C

- FD. LD. & TK. on T/C
- Set LD. & TK. on T/C

## OFFICIAL TIE PLAT

### CITY OF RIVERSIDE

*These ties are for the purpose of perpetuating the found monumentation. No claim is made as to the relationship of the points or lines shown hereon to true boundary locations.*

Scale:

Date:

Drawn by:

W.O.:

F.B.:

Sheet 1 of 1

File No.: