

5579.TIF

ACT NO. \_\_\_\_\_

DATE 5-14-51

BY JOHN CARNEY  
BROWSEALL

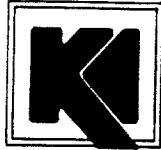

THE  
KEITH  
COMPANIES

Inland Empire, Inc.

FB \_\_\_\_\_ PG. \_\_\_\_\_

JOB NO. 338

SHT. 2 OF \_\_\_\_\_

MAGNOLIA & ROSS

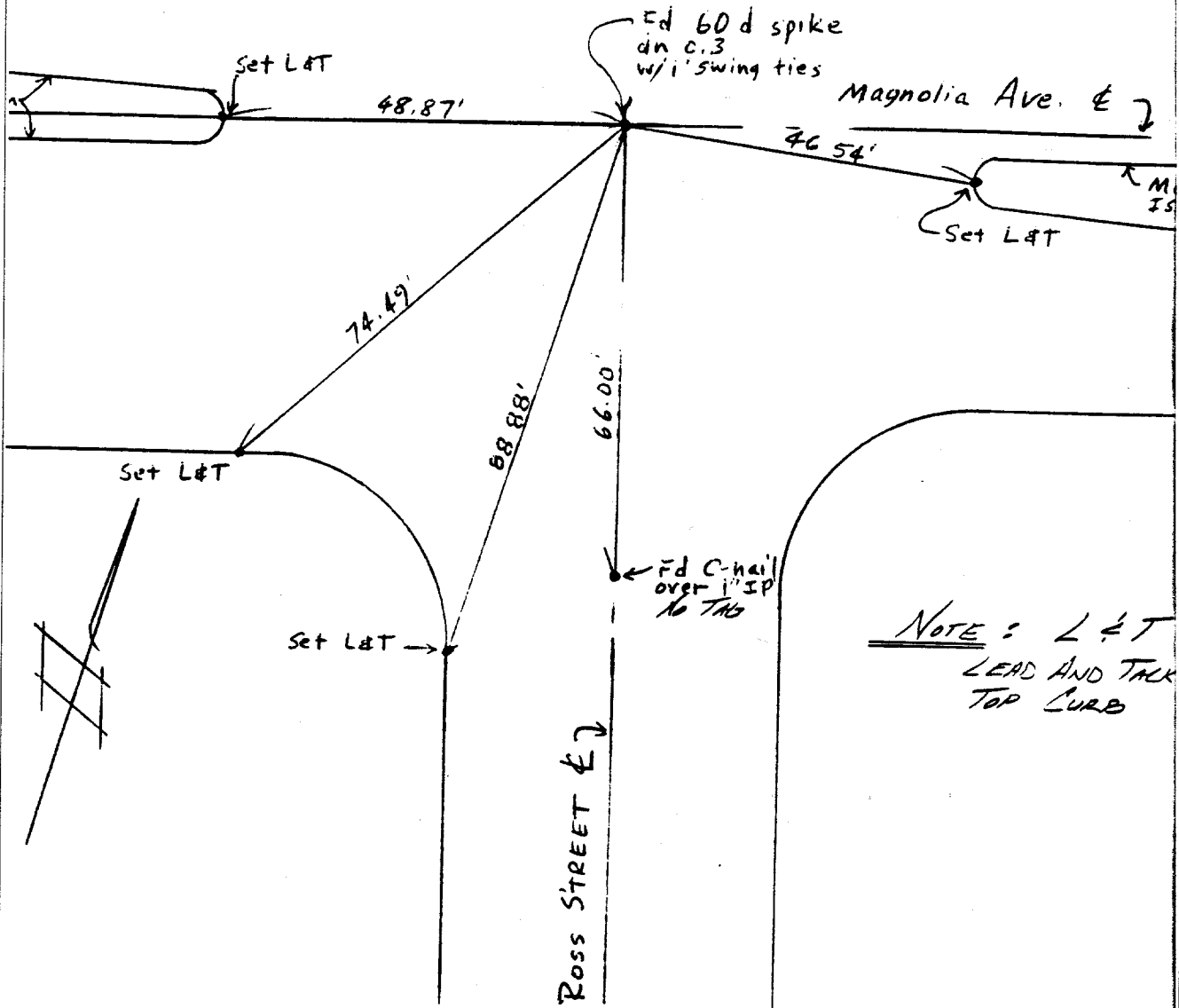

Street: Magnolia Ave

OFFICIAL USE ONLY

X-Street: Ross St

- ✕ FD. Ramset Nail on T/C
- FD. "C" Nail on T/C

- FD. LD. & TK. on T/C
- Set LD. & TK. on T/C

Scale: \_\_\_\_\_  
 Date: \_\_\_\_\_  
 Drawn by: \_\_\_\_\_  
 W.O.: \_\_\_\_\_  
 F.B.: \_\_\_\_\_

**OFFICIAL TIE PLAT**  
**CITY OF RIVERSIDE**

*These ties are for the purpose of perpetuating the found monumentation. No claim is made as to the relationship of the points or lines shown hereon to true boundary locations.*

Sheet 1 of 1  
 File No.: \_\_\_\_\_

71A