

5640.71F

Street: MAIN ST

OFFICIAL USE ONLY

X-Street: Shamrock Ave

MAIN STREET
AT SHAMROCK AVENUE
RESET ORIGINAL 12/W MONUMENT
& MADE TRANSIT TIES

NOTE
MAIN STREET IS A STRAIGHT LINE FROM
STATE HIGHWAY MONUMENT SHOWN IN FB.
841/63 TO P.I. OF MAIN & SHAMROCK AS SHOWN
IN FB. 841/67

CRFB 841/65

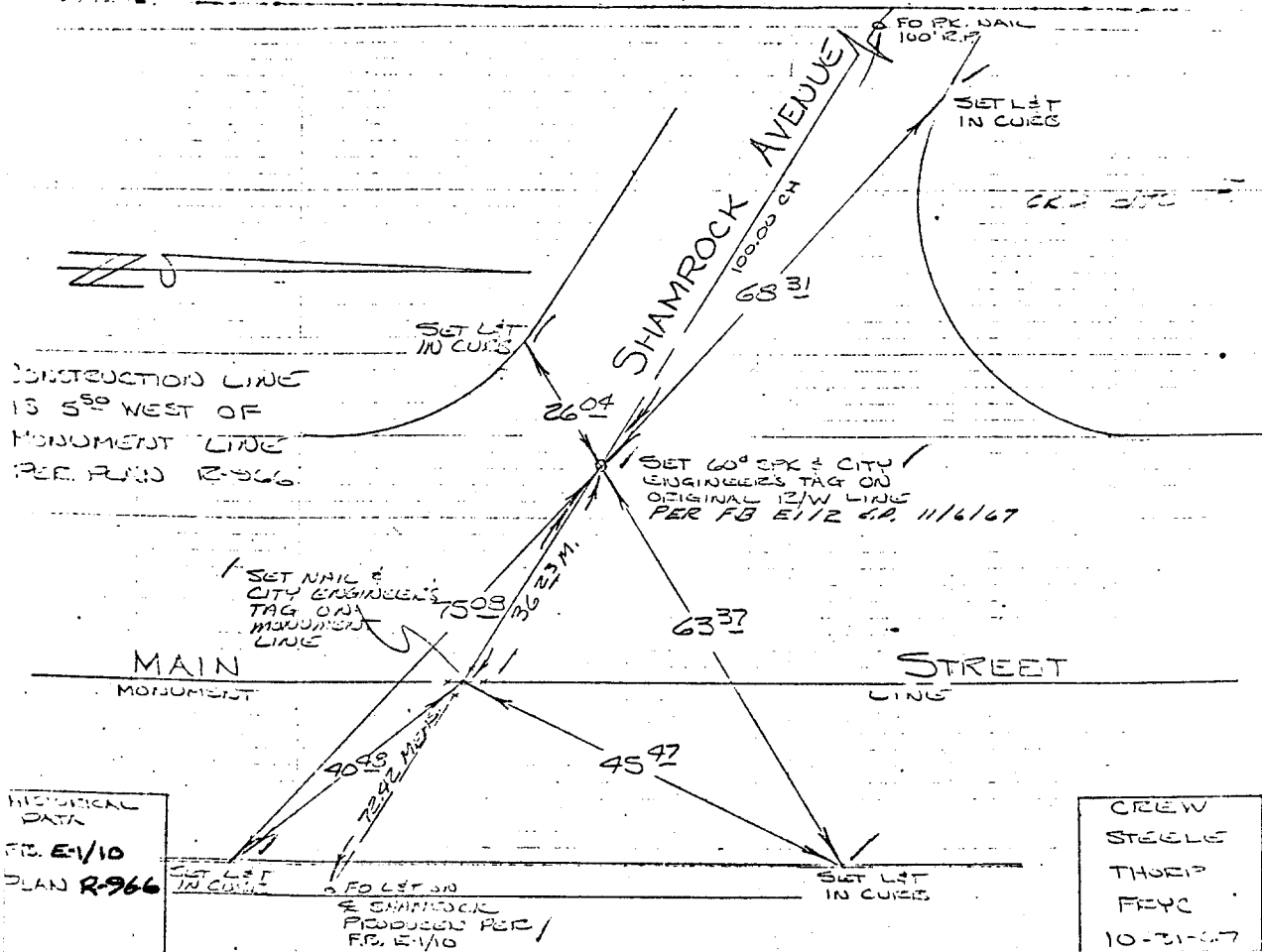

- ✗ FD. Ramset Nail on T/C
- FD. LD. & TK. on T/C
- FD. "C" Nail on T/C
- Set LD. & TK. on T/C

Scale:
Date:
Drawn by:
W.O.:
F.B.:

OFFICIAL TIE PLAT

CITY OF RIVERSIDE

These ties are for the purpose of perpetuating the found monumentation. No claim is made as to the relationship of the points or lines shown hereon to true boundary locations.

Sheet 1 of 1
File No.: