

Street: MAIN ST.

OFFICIAL USE ONLY

X-Street: Stoddard Ave

RESET ORIGINAL R/W MONUMENT
 & MADE TRANSIT TIES

NOTE
 MAIN ST IS A STRAIGHT LINE FROM
 STATE HIGHWAY MONUMENT SHOWN ON
 FTS. 841/63 TO P.I. MAIN & STODDARD AS SHOWN IN
 FTS. 841/67

CRFB 841/64

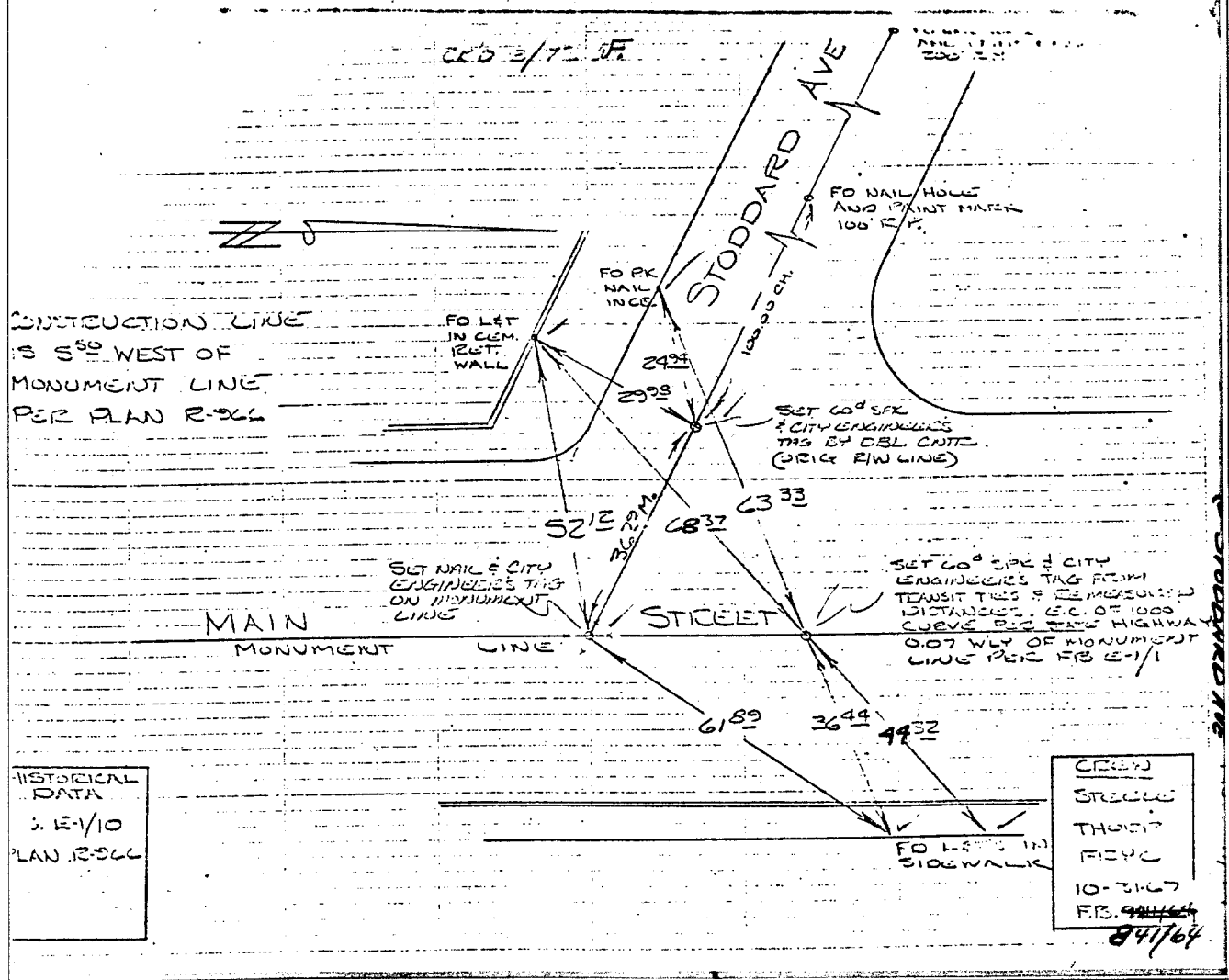

- ✕ FD. Ramset Nail on T/C
- FD. LD. & TK. on T/C
- FD. "C" Nail on T/C
- Set LD. & TK. on T/C

Scale:
 Date:
 Drawn by:
 W.O.:
 F.B.:

OFFICIAL TIE PLAT

CITY OF RIVERSIDE

These ties are for the purpose of perpetuating the found monumentation. No claim is made as to the relationship of the points or lines shown hereon to true boundary locations.

Sheet 1 of 1
 File No.:

14