

61010-1
TR 21010-1



GABEL, COOK & BECKLUND
Environmental • Hydrology • Planning
Civil Engineering • Surveying • Structures
647 North Main Street, Suite 1-B, Riverside, Calif. 92501
Telephone (714) 788-8092

SHEET 8

TIES TR. 21010-1

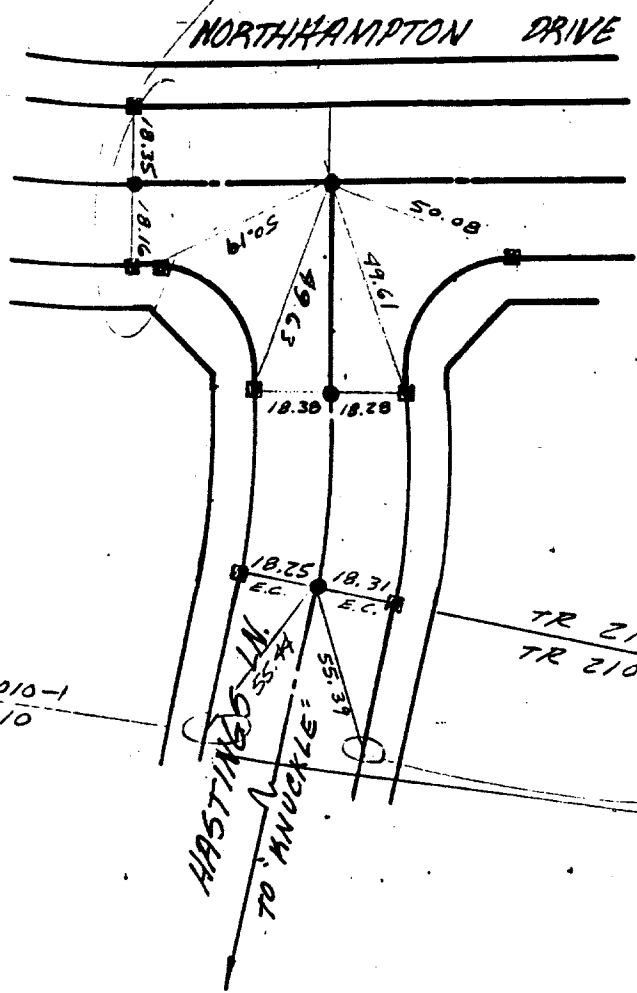

TR 21010-1
TR 21010

TR 21010-1
TR 21010

WHAT WAS
SET
NO

HASTINGS LN.
TO ANVICKLE

© HAS

- INDICATES SET 1" IP-FWASH-RCE 21740
- ▼ INDICATES SET LEAD & TACK

- × FD. Ramset Nail on T/C
- FD. "C" Nail on T/C

- FD. LD. & TK. on T/C
- Set LD. & TK. on T/C

Scale: _____
 Date: _____
 Drawn by: _____
 W.O.: _____
 F.B.: _____

OFFICIAL TIE PLAT
CITY OF RIVERSIDE

These ties are for the purpose of perpetuating the found monumentation. No claim is made as to the relationship of the points or lines shown hereon to true boundary locations.

TR 21010-1

Sheet 1 of 1

File No.:

Street: NORTHAMPTON DR.
5992 TIE
 X-Street: HASTINGS LANE
 OFFICIAL USE ONLY