

SURVEY OF TRACT 20393-3 & TRS NORTHSTAR DR  
 FOR VAN ROELE W.O. No. 12640 Date 12-3-90  
 SURVEY PARTY MARTINEZ, VILLO REF. FB 12092/39 AM.

SURVEY IN UNIFIED NORTH STAR DR. & PROMENADE CIRCLE

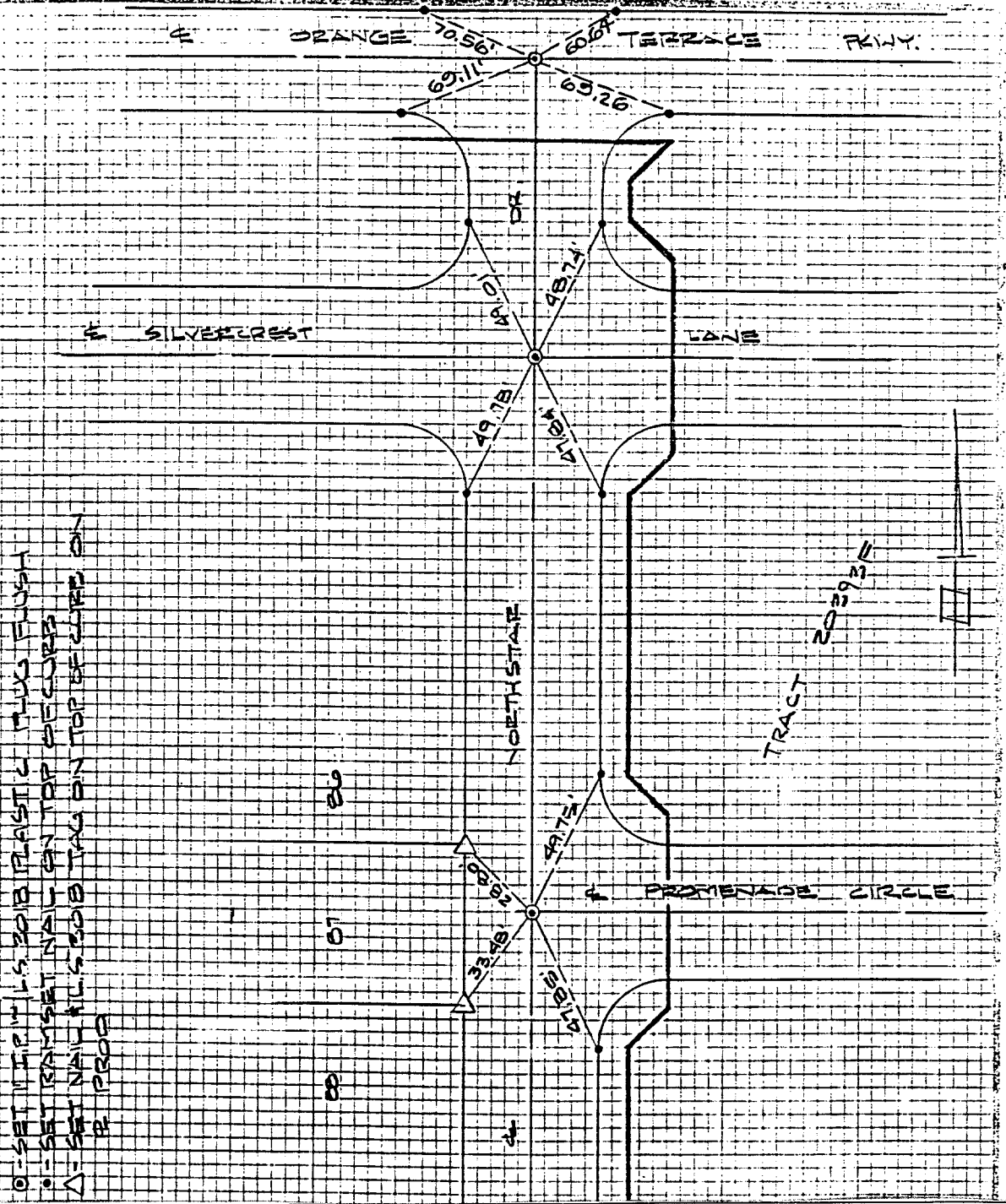

○ SET LD. & TK. ON T/C PLUS FLUSH  
 ● SET RAMSET NAIL ON TOP SURFACE  
 △ SET NAIL ALONG TAG ON TOP SURFACE ON  
 E PROP

- ✕ FD. Ramset Nail on T/C
- FD. LD. & TK. on T/C
- FD. "C" Nail on T/C
- Set LD. & TK. on T/C

Street: NORTH STAR DR  
6002 TIE  
 X-Street: ORANGE TERRACE PKWY  
 OFFICIAL USE ONLY

Scale:  
 Date:  
 Drawn by:  
 W.O.:  
 F.B.:

## OFFICIAL TIE PLAT

### CITY OF RIVERSIDE

*These ties are for the purpose of perpetuating the found monumentation. No claim is made as to the relationship of the points or lines shown hereon to true boundary locations.*

Sheet 1 of 1  
 File No.: