

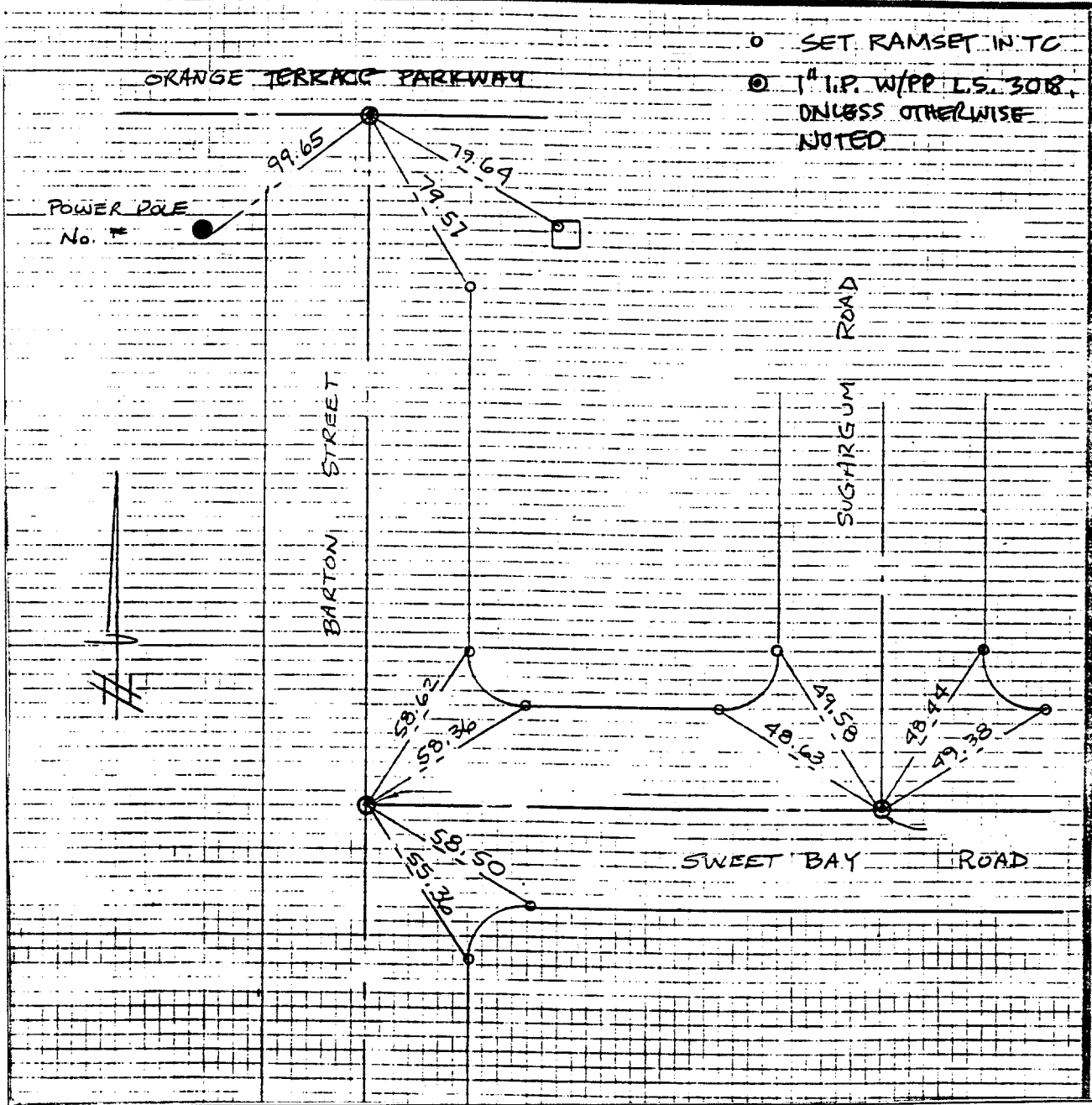

**J.F. Davidson Associates, Inc.**  
 ENGINEERING PLANNING SURVEYING  
 ARCHITECTURE LANDSCAPE ARCHITECTURE

F.B. 11035/106

SURVEY OF TRACT NO 21834-1 & TIES SHEET 5 OF 5 SHEETS  
 FOR PACESETTER W.O. No. 11035 Date 11-14-89  
 SURVEY PARTY MCKEE, HOPKINS, SMITH REF. \_\_\_\_\_ AM. \_\_\_\_\_



- ✕ FD. Ramset Nail on T/C
- FD. LD. & TK. on T/C
- FD. "C" Nail on T/C
- Set LD. & TK. on T/C

Scale: \_\_\_\_\_  
 Date: \_\_\_\_\_  
 Drawn by: \_\_\_\_\_  
 W.O.: 11035  
 F.B.: 11035/106

## OFFICIAL TIE PLAT

### CITY OF RIVERSIDE

*These ties are for the purpose of perpetuating the found monumentation. No claim is made as to the relationship of the points or lines shown hereon to true boundary locations.*

Sheet **5** of **5**  
 File No.: \_\_\_\_\_

Street: ORANGE TERRACE PKWY X-Street: BARTON ST  
 OFFICIAL USE ONLY

6105.71E