

Street: ORANGE TERRACE PKWY (E 1/4) X-Street: HOPSEED DRIVE

6109.71F

OFFICIAL USE ONLY

SURVEY OF E TIES ORANGE TERRACE PARKWAY SHEET 1 OF 5 SHEETS
 FOR _____ W.O. No. _____ Date 8-17-90
 SURVEY PARTY BRIDGES, TENNEY REF. _____ A.M. _____

- 1" I.P. W/PP L.S. 3018, UNLESS OTHERWISE NOTED
- RAMSET NAIL IN TC

SURVEY NO. 1015 ORANGE TERRACE PKWY. & HOPSEED DR.

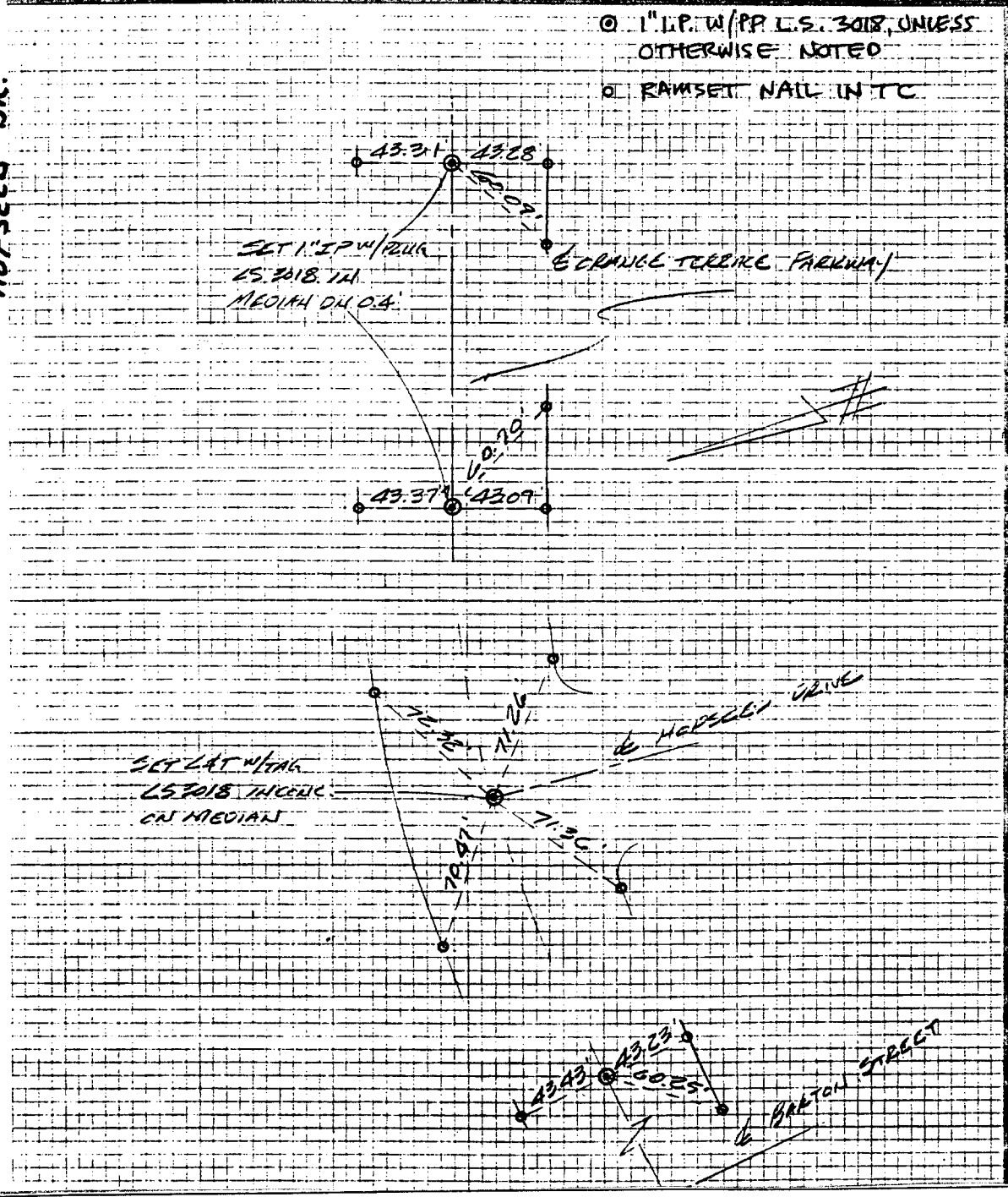

- × FD. Ramset Nail on T/C
- FD. LD. & TK. on T/C
- FD. "C" Nail on T/C
- Set LD. & TK. on T/C

Scale: _____
 Date: 8-17-90
 Drawn by: _____
 W.O.: _____
 F.B.: 10058/445

OFFICIAL TIE PLAT
CITY OF RIVERSIDE

These ties are for the purpose of perpetuating the found monumentation. No claim is made as to the relationship of the points or lines shown hereon to true boundary locations.

TR 22551

Sheet 1 of 5
 File No.: _____