

# TRANSIT TIES

Street:

OTTAWA AVE. #25

X-Street:

LOMA VISTA ST.

OFFICIAL USE ONLY

6161. TIE

**NOTE:**

- ⊙ NOTHING FD. @ SURFACE
- ( ) REC DIST. PER. CRFB 1038/7 550/4A

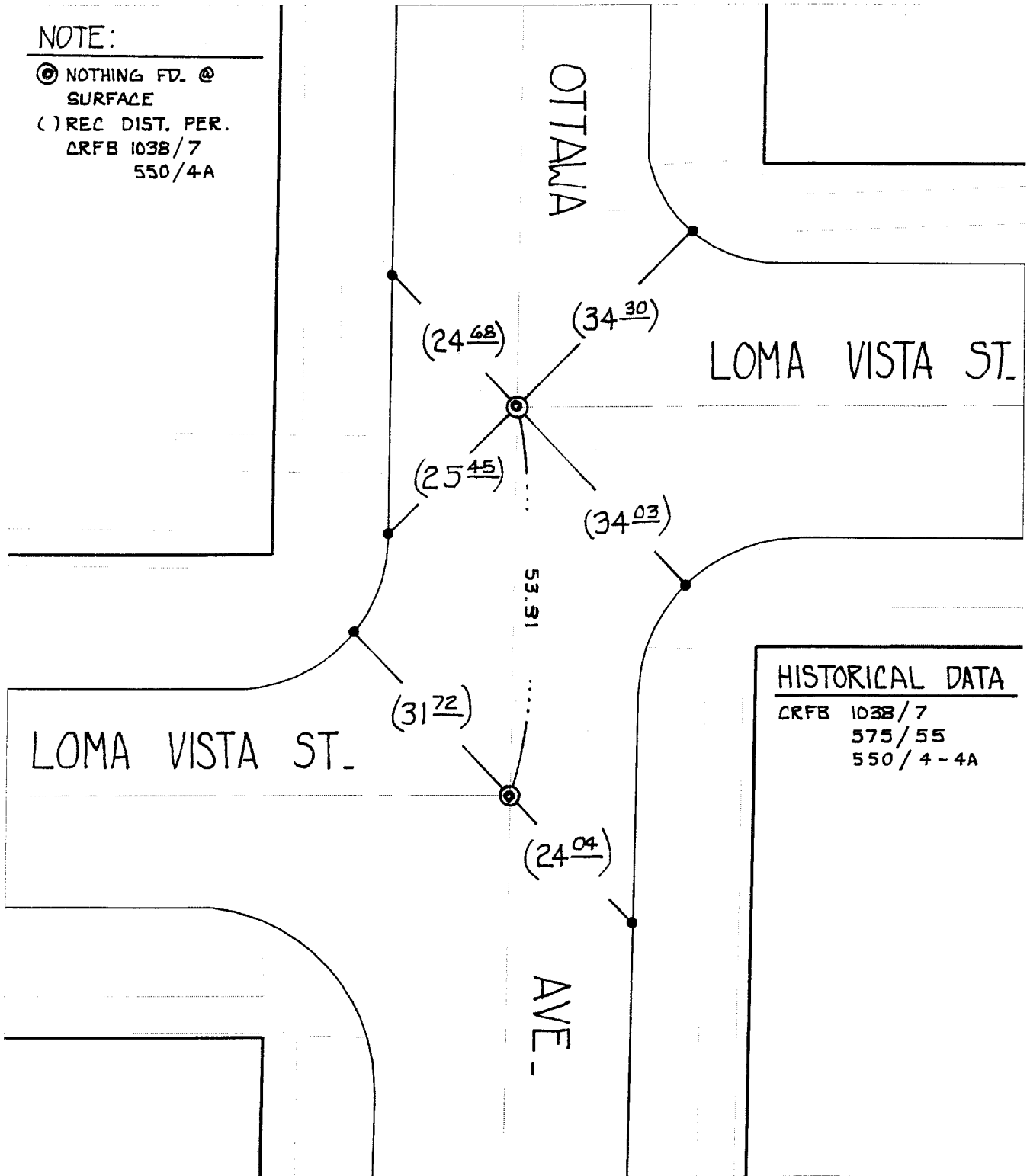

**HISTORICAL DATA**

CRFB 1038/7  
575/55  
550/4-4A

- ⊙ FD. Ramset Nail on T/C
- FD. "C" Nail on T/C

- FD. LD. & TK. on T/C
- Set LD. & TK. on T/C

Scale: 1" = 20'

Date: 08/23/99

Drawn by: L. Harris

W.O.:

F.B.:

## OFFICIAL TIE PLAT CITY OF RIVERSIDE

*These ties are for the purpose of perpetuating the found monumentation. No claim is made as to the relationship of the points or lines shown hereon to true boundary locations.*



Sheet 3 of 4

File No.: