

CASI. TIF

Street: ORANGE ST.

X-Street: Poplar

OFFICIAL USE ONLY

SURVEY OF ORANGE TIE POPLAR ST. INDEX L11 PAGE 85
SURVEYED BY GARCIA-KLUZ-STEPHENS DATE MAR. 8, 1988

HISTORICAL DATA
CEFB 387/24

TRANSIT TIES

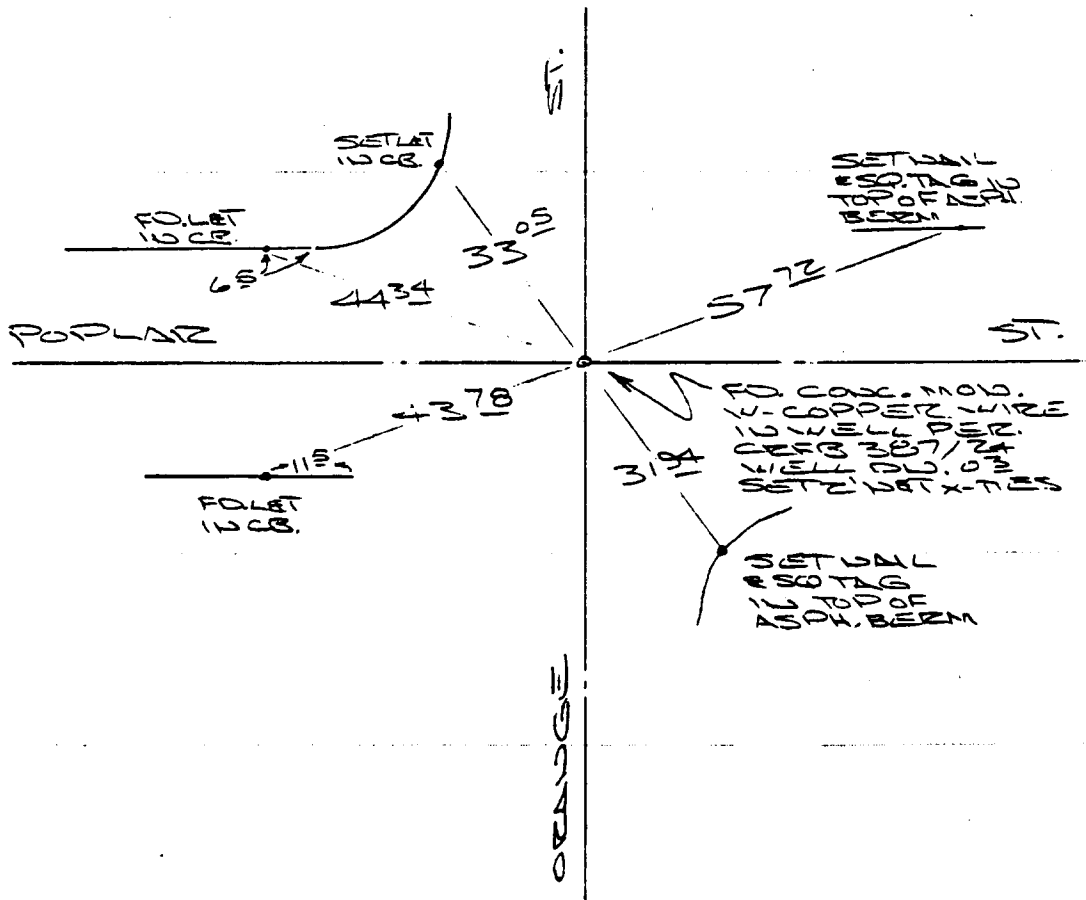

- ✕ FD. Ramset Nail on T/C
- FD. LD. & TK. on T/C
- FD. "C" Nail on T/C
- Set LD. & TK. on T/C

Scale:
Date:
Drawn by:
W.O.:
F.B.:

OFFICIAL TIE PLAT

CITY OF RIVERSIDE

These ties are for the purpose of perpetuating the found monumentation. No claim is made as to the relationship of the points or lines shown hereon to true boundary locations.

Sheet 1 of 1
File No.:

00