

Street:

PORTOLA WAY

6534 FILE

OFFICIAL USE ONLY

X-Street:

LA JOLLA DR.

10-26-56  $\frac{39}{596}$

PORTOLA WAY

TIES

LEAD + TACKS + TIES

LA JOLLA DR

EL CAJON DR

PHOENIX AVE.

PORTOLA

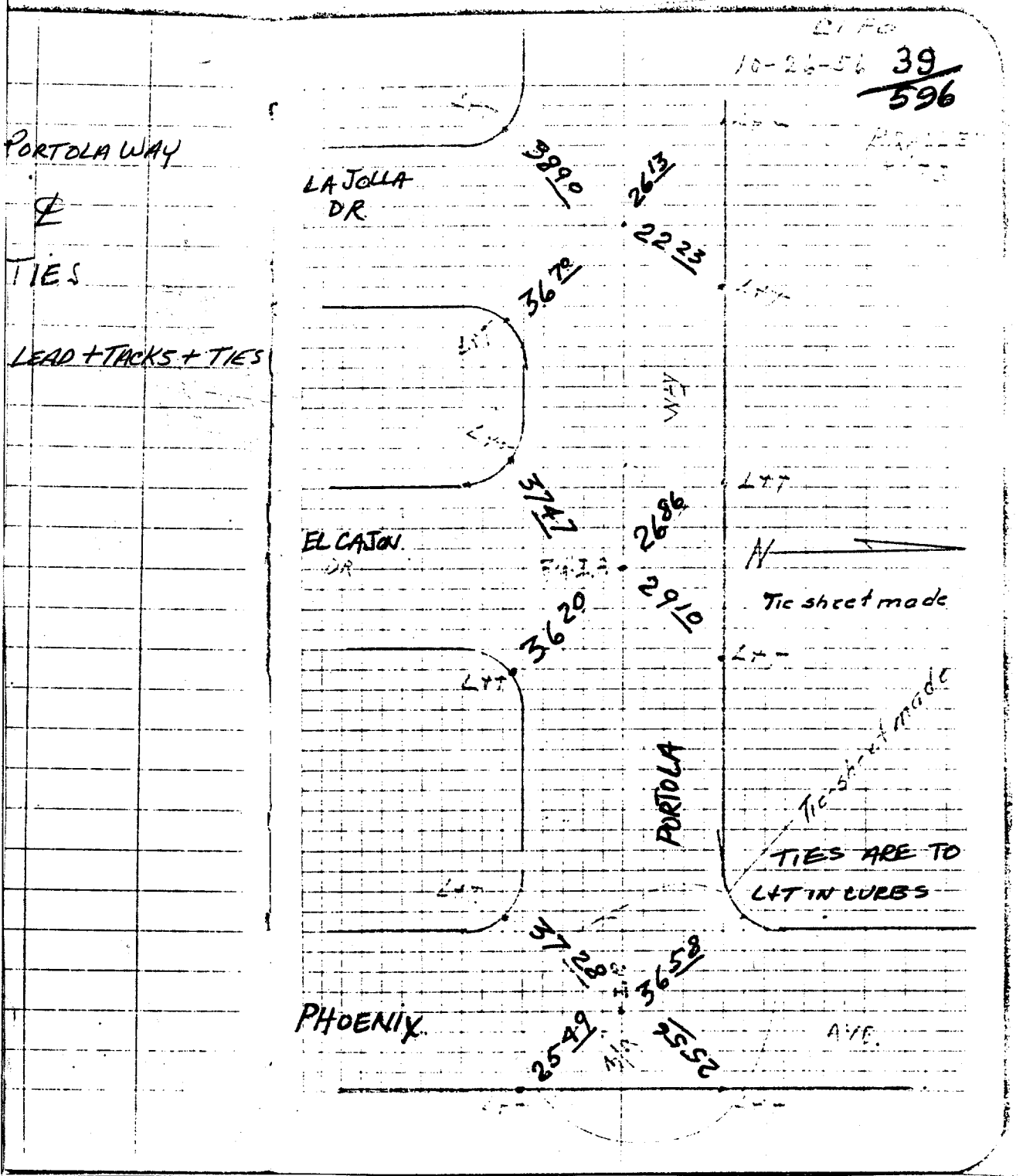

- ✕ FD. Ramset Nail on T/C
- FD. "C" Nail on T/C

- FD. LD. & TK. on T/C
- Set LD. & TK. on T/C

Scale:  
 Date:  
 Drawn by:  
 W.O.:  
 F.B.:

## OFFICIAL TIE PLAT

### CITY OF RIVERSIDE

*These ties are for the purpose of perpetuating the found monumentation. No claim is made as to the relationship of the points or lines shown hereon to true boundary locations.*

Sheet 1 of 1  
 File No.: