

Street:

**PALM AVE**

**6644 TIE**

X-Street:

**LINWOOD**

OFFICIAL USE ONLY

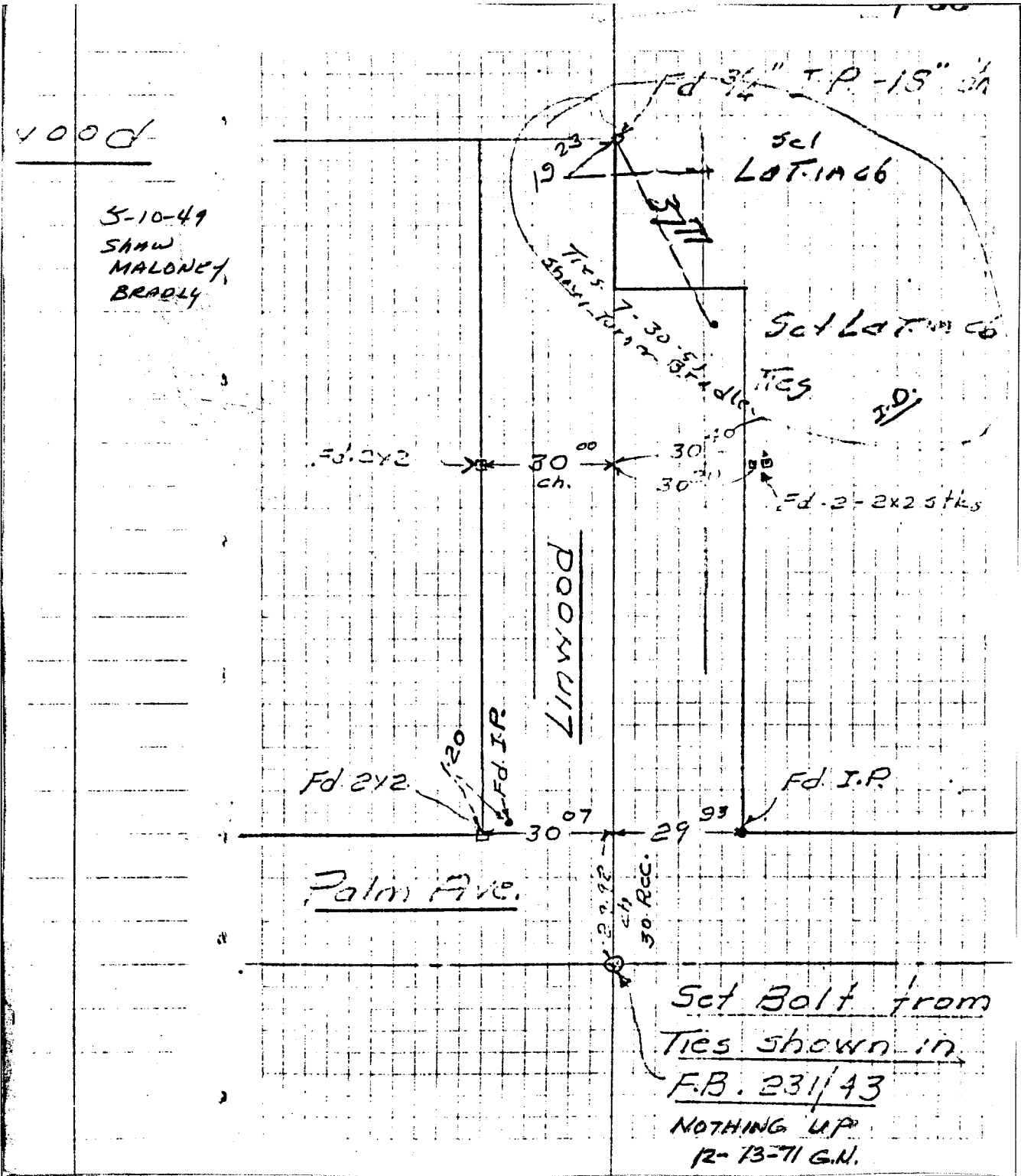

5-10-49  
 SHAW  
 MALONEY  
 BRADLY

Fd. 2x2

WOOD

30<sup>00</sup>  
 ch.

30<sup>00</sup>  
 30<sup>00</sup>

Fd. 2-2x2 stks

30<sup>07</sup>

29<sup>99</sup>

Fd. I.P.

Palm Ave.

Set Bolt from  
 Ties shown in  
 F.B. 231/43  
 NOTHING UP  
 R-73-71 G.N.

✕ FD. Ramset Nail on T/C  
 ■ FD. "C" Nail on T/C

● FD. LD. & TK. on T/C  
 ○ Set LD. & TK. on T/C

Scale:  
 Date:  
 Drawn by:  
 W.O.:  
 F.B.:

**OFFICIAL TIE PLAT**  
**CITY OF RIVERSIDE**

These ties are for the purpose of perpetuating the found monumentation. No claim is made as to the relationship of the points or lines shown hereon to true boundary locations.

Sheet 1 of 1  
 File No.: