

SURVEY OF PENNSYLVANIA AVE @ CANYON CREST DR. INDEX LL35 PAGE 104
 SURVEYED BY LOPEZ - HATCHKISS - TOTTEN T-TIMM DATE JUNE 24, 1993

TRANSIT TIES

REF: LL11/01

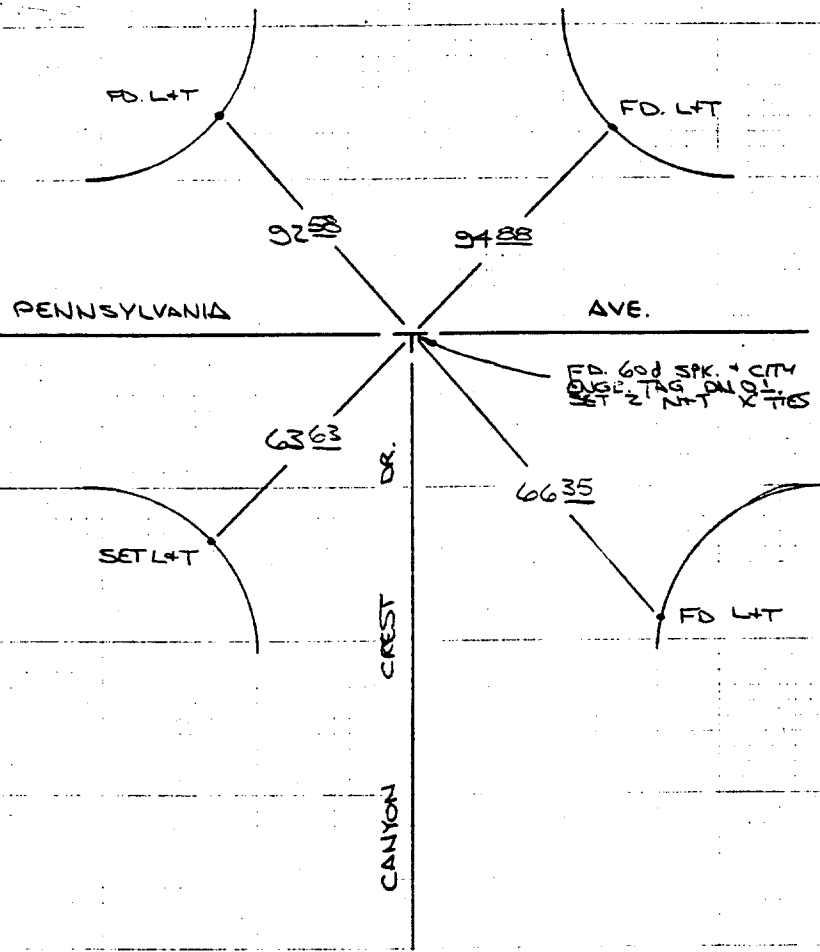

- ✕ FD. Ramset Nail on T/C
- FD. LD. & TK. on T/C
- FD. "C" Nail on T/C
- Set LD. & TK. on T/C

Street: PENNSYLVANIA
6665.71E
 X-Street: CANYON CREST DR.
 OFFICIAL USE ONLY

Scale:
 Date:
 Drawn by:
 W.O.:
 F.B.:

OFFICIAL TIE PLAT

CITY OF RIVERSIDE

These ties are for the purpose of perpetuating the found monumentation. No claim is made as to the relationship of the points or lines shown hereon to true boundary locations.

Sheet 1 of 1
 File No.: