

Street: RAMONA DR. 6772.77E E.C. X-Street: LARCHWOOD & RIVERSIDE
 OFFICIAL USE ONLY

RAMONA DRIVE
 AT
 E.C. bet
 LARCHWOOD AND
 RIVERSIDE

HISTORICAL DATA
 1. FB 256/27
 2. BRENTWOOD PLACE TRACT

TRANSIT TIES
 CREW:
 HUTCHINSON
 THORP
 RUSSELL

DATE:
 JUNE 27, 1968

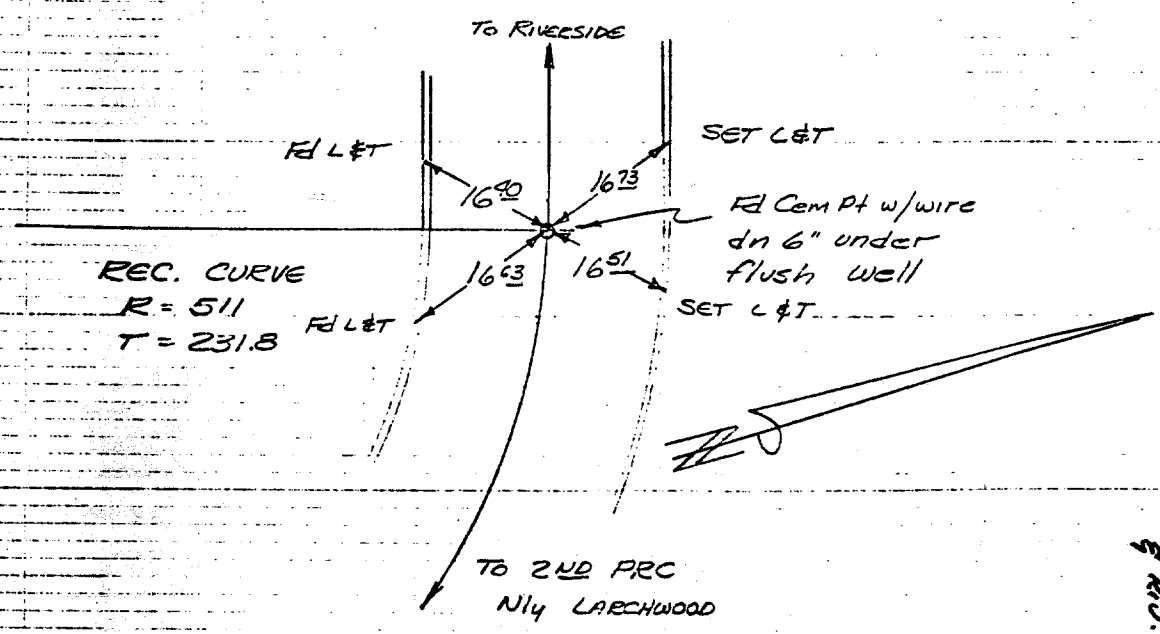

- ✕ FD. Ramset Nail on T/C
- FD. LD. & TK. on T/C
- FD. "C" Nail on T/C
- Set LD. & TK. on T/C

Scale:
 Date:
 Drawn by:
 W.O.:
 F.B.:

OFFICIAL TIE PLAT CITY OF RIVERSIDE

These ties are for the purpose of perpetuating the found monumentation. No claim is made as to the relationship of the points or lines shown hereon to true boundary locations.

Sheet 1 of 1
 File No.: