

6822.TIF

STREET: MISSION INN AVE

OFFICIAL USE ONLY

X-STREET: FAIRMOUNT BLVD

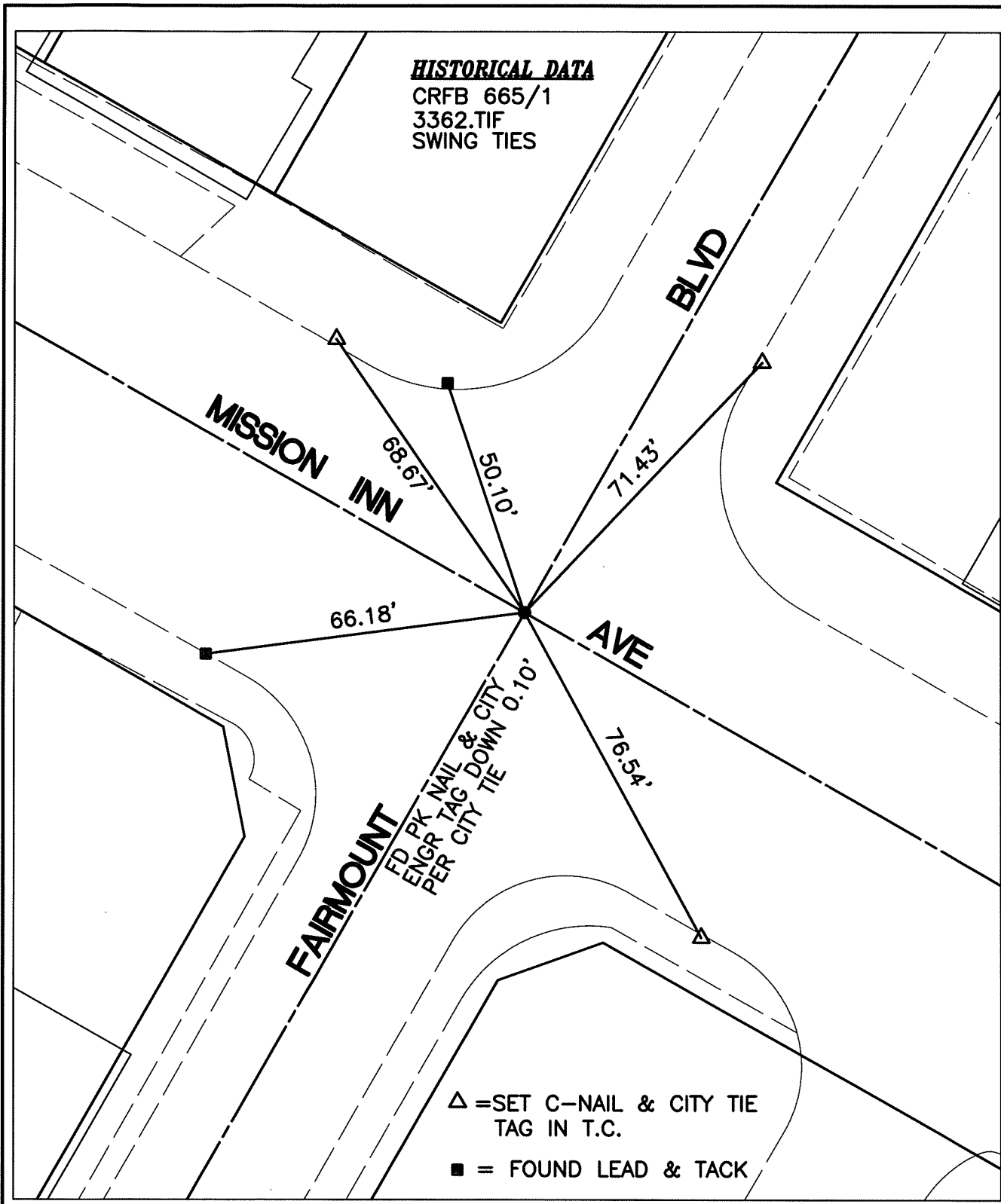

SCALE: 1"=30'

DATE: 7/12/10

DRAWN BY: CURT

F.B.:SEE HISTORICAL DATA

SEC:23 T.2 S.,R. 5W

**OFFICIAL TIE PLAT**  
CITY OF RIVERSIDE

THESE TIES ARE FOR THE PURPOSE OF PERPETUATING THE FOUND MONUMENTATION. NO CLAIM IS MADE AS THE RELATIONSHIP OF THE POINTS OR LINES SHOWN HEREON TO TRUE BOUNDARY LOCATIONS

SHEET 1 OF 1