



J.F. Davidson Associates, Inc.  
ENGINEERING PLANNING SURVEYING  
ARCHITECTURE LANDSCAPE ARCHITECTURE

F.B. 10058/447

SURVEY OF

← TIE ORANGE TERRACE PARKWAY

SHEET 3 OF 5 SHEET

FOR

W.O. No.

Date 8-17-90

SURVEY PARTY

FILMORE, TENNESSEE

REF.

A.M.

- 1" I.P. W/PP L.S. 3018, UNLESS OTHERWISE NOTED
- RAMSET NAIL IN T/C

SANDHILL DR. at SLY ORANGE TERRACE PKWY.

L I N E

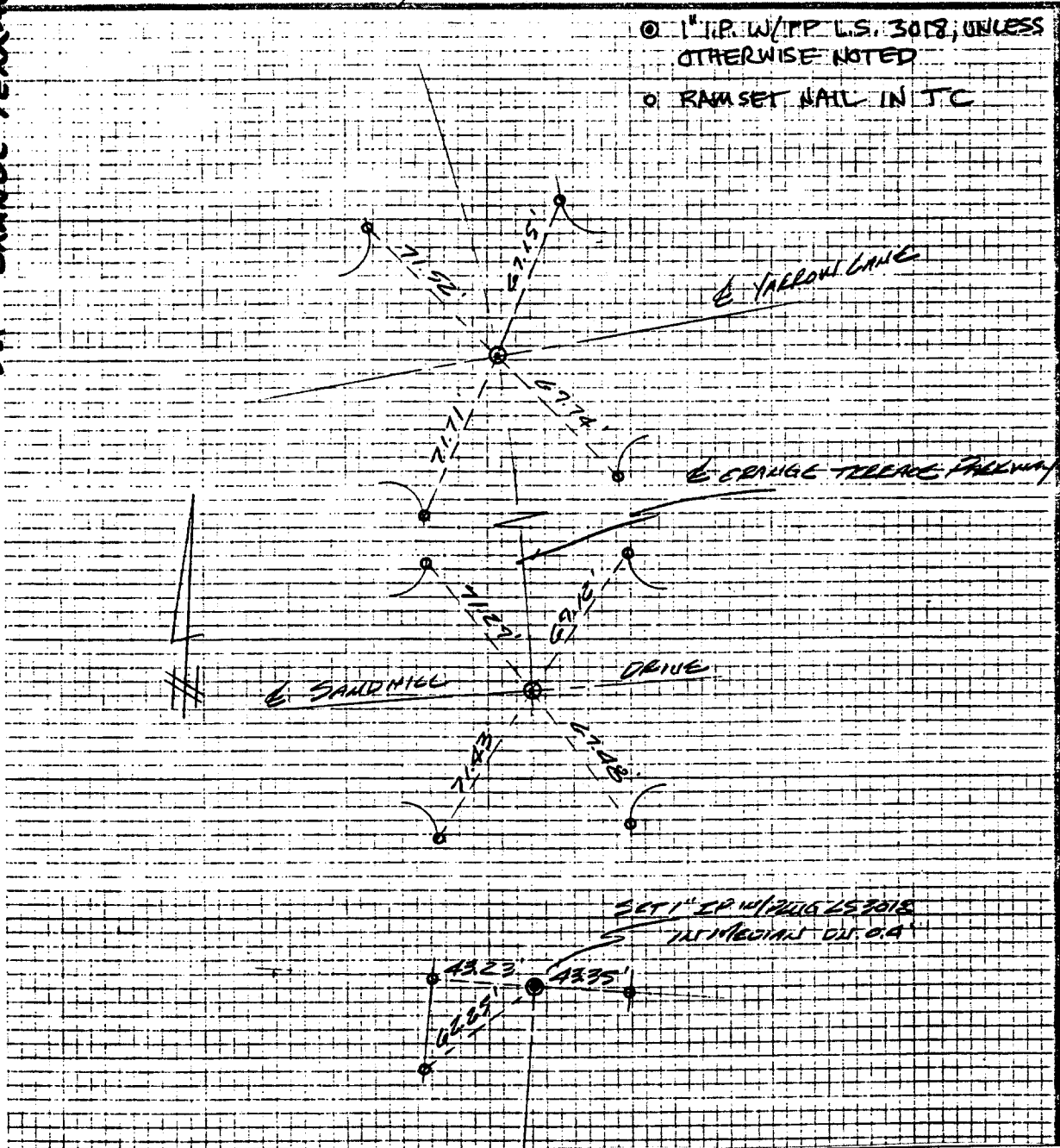

- × FD. Ramset Nail on T/C
- FD. "C" Nail on T/C

- FD. LD. & TK. on T/C
- Set LD. & TK. on T/C

Street: SANDHILL DR. SLY X-Street: ORANGE TERRACE PKWY  
7124.77E OFFICIAL USE ONLY

Scale:

Date:

Drawn by:

W.O.:

F.B.:

## OFFICIAL TIE PLAT

### CITY OF RIVERSIDE

These ties are for the purpose of perpetuating the found monumentation. No claim is made as to the relationship of the points or lines shown hereon to true boundary locations.

TRACT 22551

Sheet 3 of 5

File No.: