

TRACT 21834-1



J.F. Davidson Associates, Inc.
ENGINEERING PLANNING SURVEYING
ARCHITECTURE LANDSCAPE ARCHITECTURE

F.B. 11035/106

SURVEY OF TRACT NO 21834-1 & TIES SHEET 4 OF 6 SHEET
FOR PACESETTER WO. No. 11035 Date 11-14-89
SURVEY PARTY MCKEE, HOPKINS, SMITH REF. AM.

SURVEY NOTES

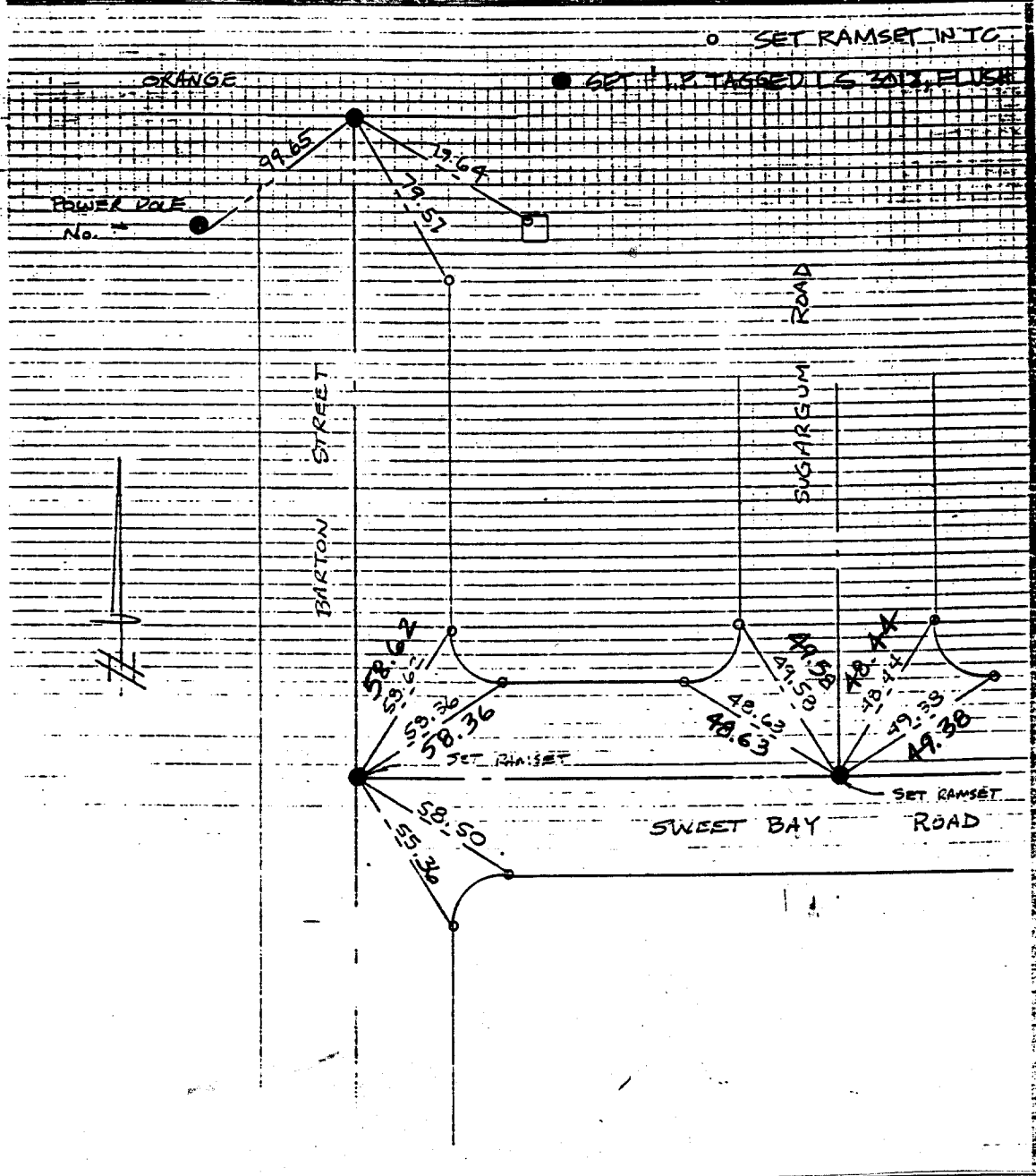

- ✕ FD. Ramset Nail on T/C
- FD. "C" Nail on T/C

- FD. LD. & TK. on T/C
- Set LD. & TK. on T/C

Scale:
Date:
Drawn by:
W.O.:
F.B.:

OFFICIAL TIE PLAT
CITY OF RIVERSIDE

These ties are for the purpose of perpetuating the found monumentation. No claim is made as to the relationship of the points or lines shown hereon to true boundary locations.

Sheet 1 of 1
File No.:

Street: **SWEET BAY RD.**
7567. TIE
X-Street: **BARTON ST.**
OFFICIAL USE ONLY