



J.F. Davidson Associates, Inc.  
ENGINEERING PLANNING SURVEYING  
ARCHITECTURE LANDSCAPE ARCHITECTURE

F.B. 11035/106

SURVEY OF TRACT No 21834-1 & TIES SHEET 5 OF 5 SHEETS  
FOR PACESETTER W.O. No. 11035 Date 11-14-89  
SURVEY PARTY MCKEE, HOPKINS, SMITH REF. \_\_\_\_\_ AM. \_\_\_\_\_

Street: SWEET BAY ROAD  
7562 TIE  
X-Street: SUGAR GUM ROAD  
OFFICIAL USE ONLY

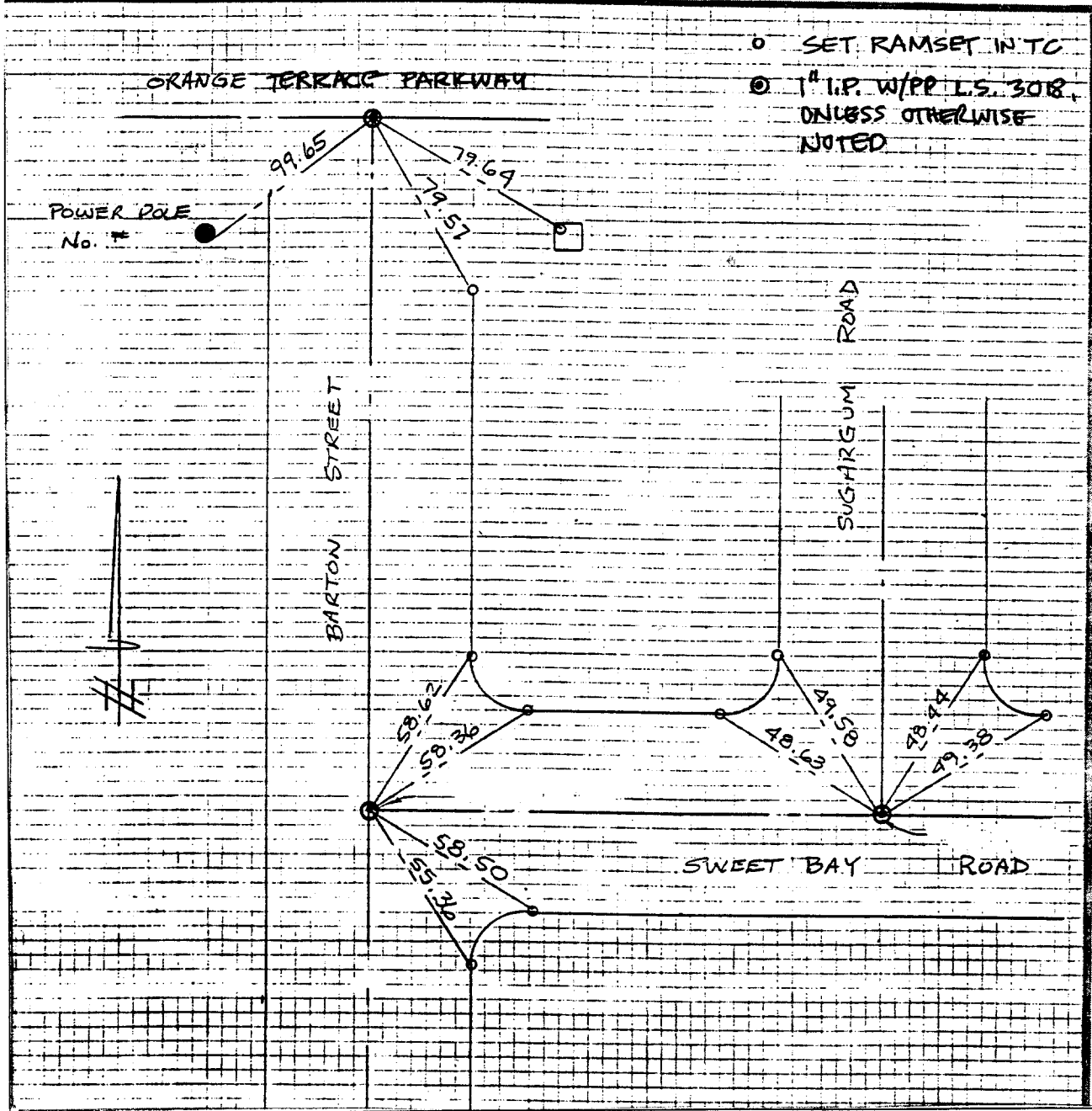

× FD. Ramset Nail on T/C  
 ■ FD. "C" Nail on T/C

● FD. LD. & TK. on T/C  
 ○ Set LD. & TK. on T/C

Scale:

Date:

Drawn by:

W.O.: 11035

F.B.: 11035/106

## OFFICIAL TIE PLAT

### CITY OF RIVERSIDE

*These ties are for the purpose of perpetuating the found monumentation. No claim is made as to the relationship of the points or lines shown hereon to true boundary locations.*

Sheet **5** of **5**

File No.: