

Street: SWEETWATER DR. X-Street: CUL-E-SAC  
7564. TIE OFFICIAL USE ONLY

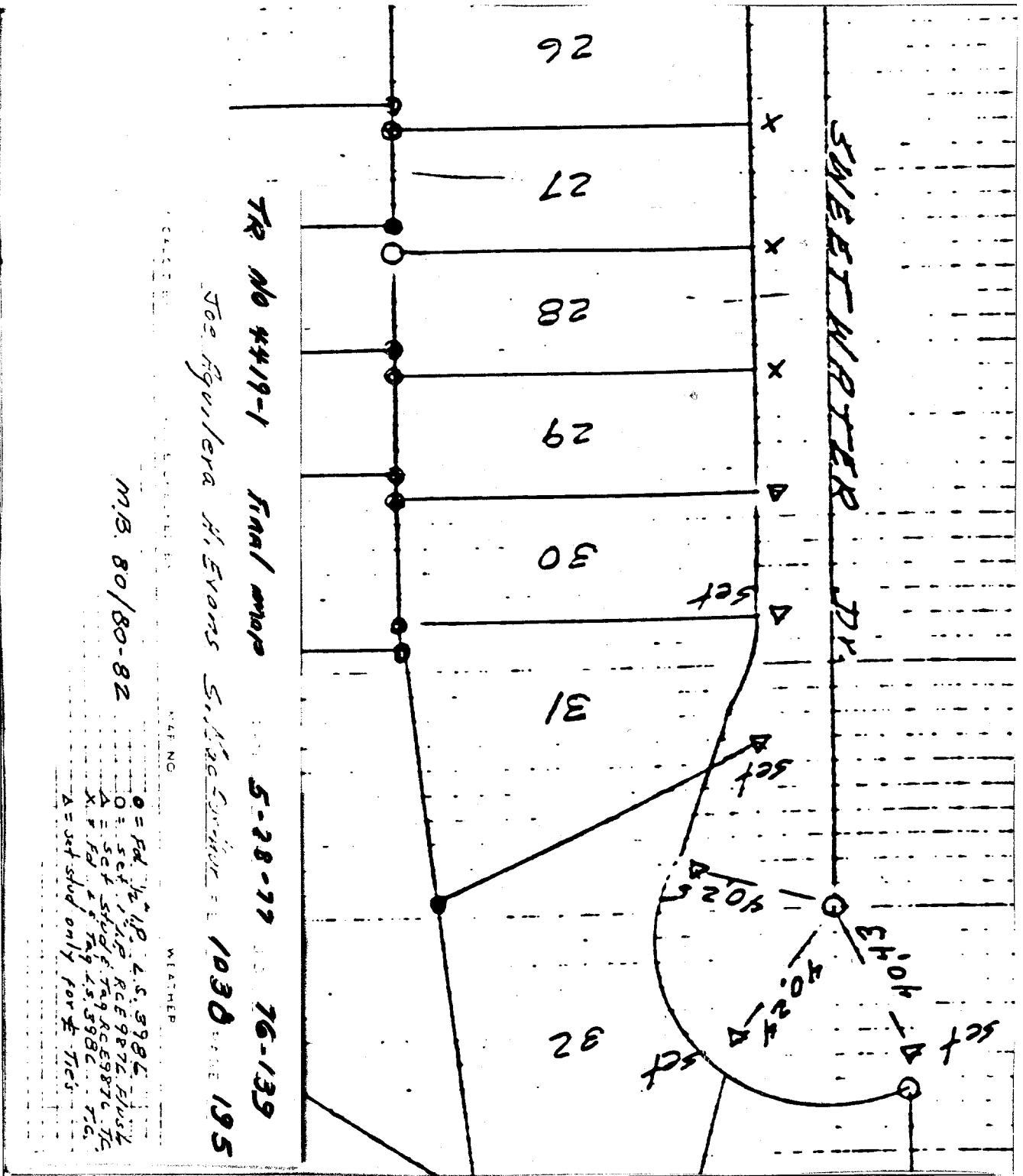

TR No 4419-1 Final map 5-28-77 76-139  
 Joe Aguilar H. Evans S. Mac Jordan 1030 195

M.B. 80/80-82

0 = Pd. 1/2" IR. L.S. 398C  
 O = set 1" IR. R.C.E. 9876. Busk  
 A = set 5/16" IR. 749 R.C.E. 9876 T.C.  
 X = Pd. 1/2" IR. L.S. 398C T.C.  
 A = set stud only for # Ties.

- × FD. Ramset Nail on T/C
- FD. LD. & TK. on T/C
- FD. "C" Nail on T/C
- Set LD. & TK. on T/C

Scale:  
 Date:  
 Drawn by:  
 V.O.:  
 B.:

## OFFICIAL TIE PLAT

### CITY OF RIVERSIDE

*These ties are for the purpose of perpetuating the found monumentation. No claim is made as to the relationship of the points or lines shown hereon to true boundary locations.*

Sheet 1 of 1  
 File No.: