

Street: SPRUCE ST. 7597.71F (BTM) X-Street: ESCONDIDO & KANSAS AVE
 OFFICIAL USE ONLY

HISTORICAL DATA CCRS 640/58 CCRS 715/71		SWING TIES	CREW: STEELE FRYC RUSSELL MAY 26, 1972 CCRS 644/49
---	--	------------	---

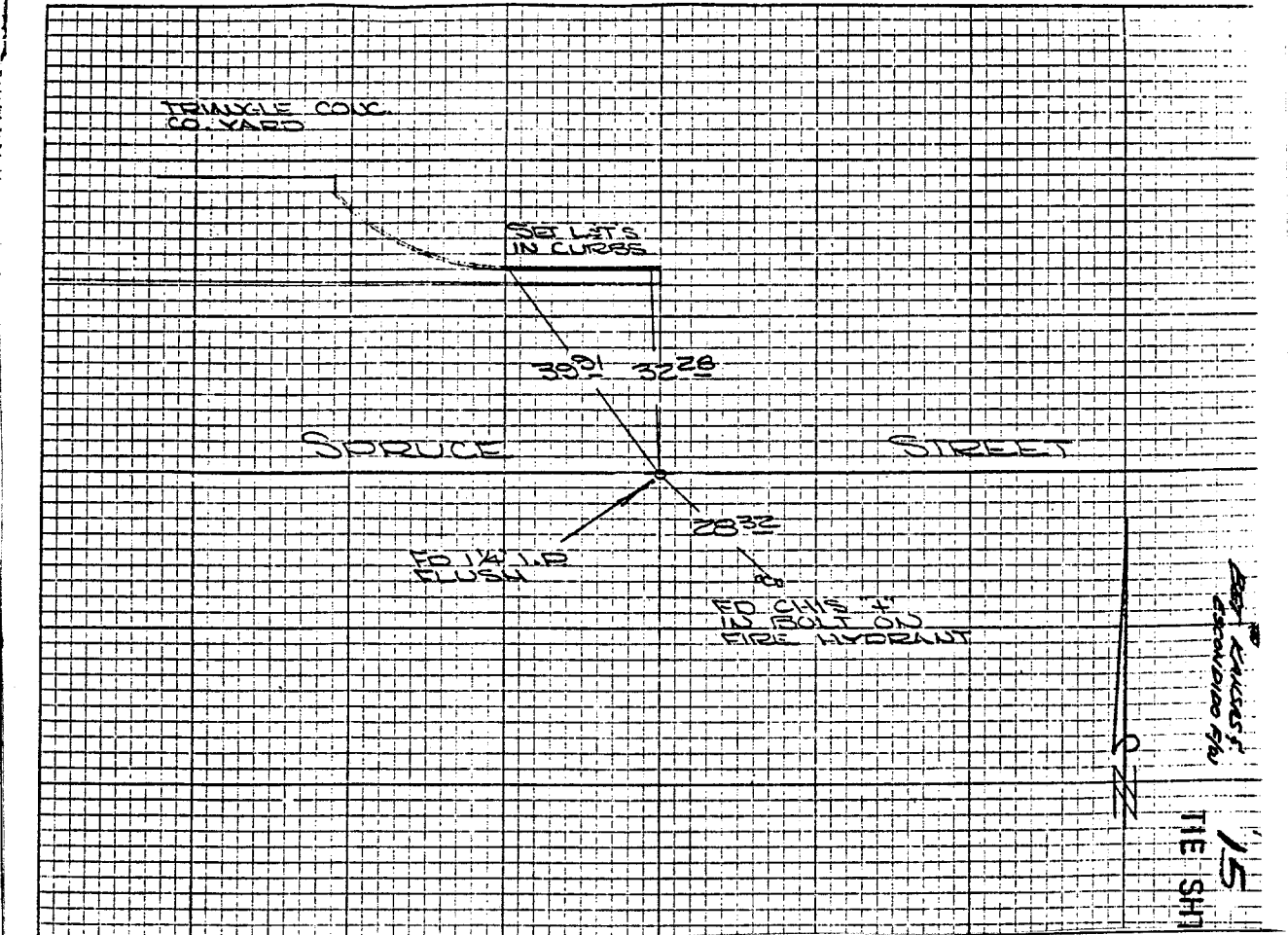

- ✕ FD. Ramset Nail on T/C
- FD. LD. & TK. on T/C
- FD. "C" Nail on T/C
- Set LD. & TK. on T/C

Scale:
 Date: MAY 26 / 1972
 Drawn by:
 W.O.:
 F.B.: 944 / 49

OFFICIAL TIE PLAT
CITY OF RIVERSIDE

These ties are for the purpose of perpetuating the found monumentation. No claim is made as to the relationship of the points or lines shown hereon to true boundary locations.

Sheet 1 of 1
 File No.: