

# TRANSIT & SWING TIES

## HISTORICAL DATA

CRFB 958/25  
 946/30  
 265/78

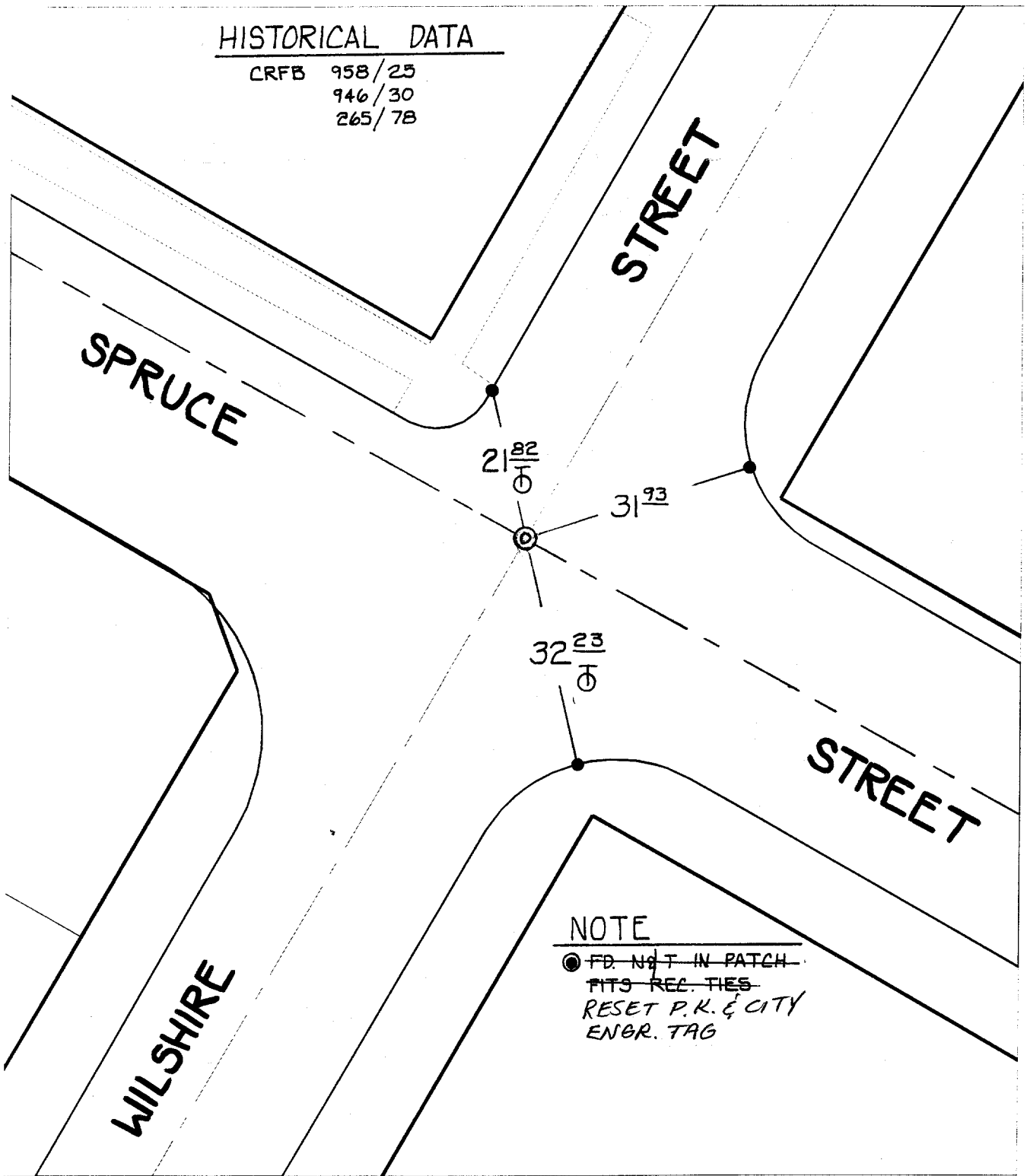

### NOTE

● ~~FD. NOT IN PATCH.~~  
~~FITS REC. TIES.~~  
 RESET P.K. & CITY  
 ENGR. TAG

× FD. Ramset Nail on T/C  
 ■ FD. "C" Nail on T/C

● FD. LD. & TK. on T/C  
 ○ Set LD. & TK. on T/C

Street:  
 7631. TIF

SPRUCE STREET

OFFICIAL USE ONLY  
 X-Street:

WILSHIRE STREET

30

Scale: 1" = 20'

Date: 01/21/00

Drawn by: SURVEY

W.O.:

F.B.:

## OFFICIAL TIE PLAT CITY OF RIVERSIDE

*These ties are for the purpose of perpetuating the found monumentation. No claim is made as to the relationship of the points or lines shown hereon to true boundary locations.*



Sheet 1 of 1

File No.: 30