

Street: STREETER AVE
7643.T/C

X-Street: EL MOLINO AVE
 OFFICIAL USE ONLY

HISTORICAL DATA		TRANSIT TIES		FIELD CREW	
F.B. 696/59				FRYC	
				NEW	
				RUSSELL	
				DEC. 10, 1971	
				F.B. 951/13	

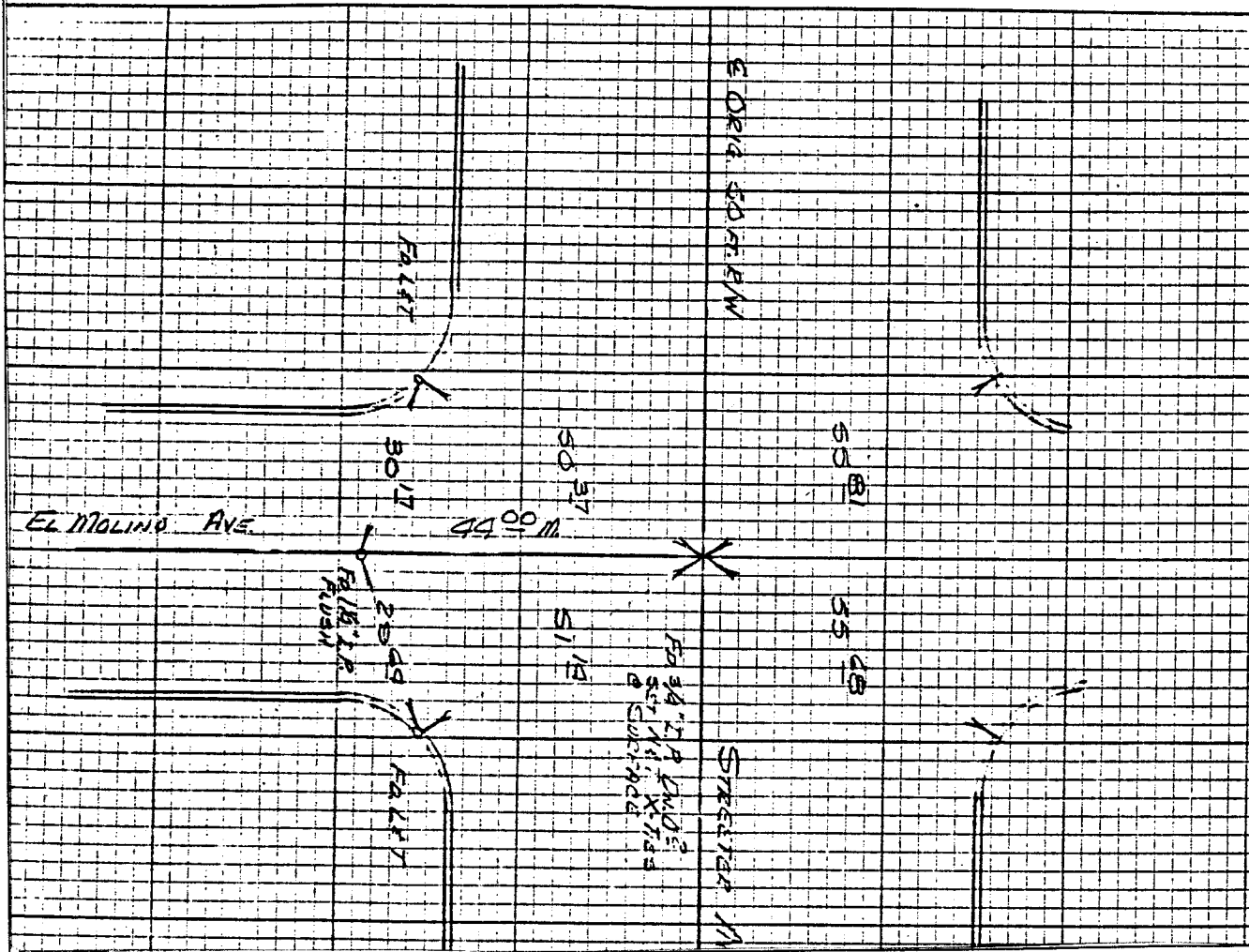

- ✕ FD. Ramset Nail on T/C
- FD. LD. & TK. on T/C
- FD. "C" Nail on T/C
- Set LD. & TK. on T/C

Scale:
 Date:
 Drawn by:
 W.O.:
 F.B.: 951/13

OFFICIAL TIE PLAT

CITY OF RIVERSIDE

These ties are for the purpose of perpetuating the found monumentation. No claim is made as to the relationship of the points or lines shown hereon to true boundary locations.

Sheet 1 of 1
 File No.: