

Street: TOMLINSON AVE  
7790.77E

X-Street: WELLS AVE  
 OFFICIAL USE ONLY

HISTORICAL DATA Co. F.B. 783/4 <b>CO. F.B. 783/4</b>		SWING TIES	FIELD CREW FRYE NEW RUSSELL Oct. 13, 1971 F.B. 921/77
--	--	------------	--

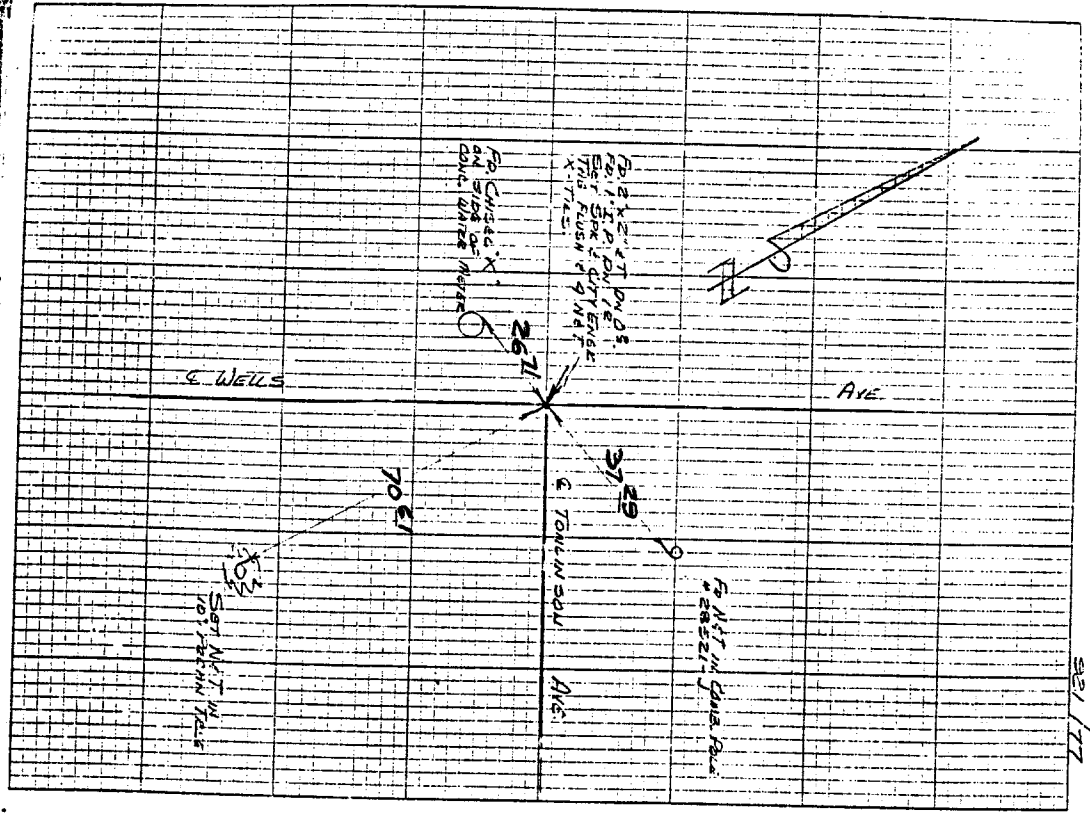

- ✕ FD. Ramset Nail on T/C
- FD. LD. & TK. on T/C
- FD. "C" Nail on T/C
- Set LD. & TK. on T/C

Scale:  
 Date: Oct 13, 1971  
 Drawn by:  
 W.O.:  
 F.B.: 921/77

## OFFICIAL TIE PLAT

### CITY OF RIVERSIDE

*These ties are for the purpose of perpetuating the found monumentation. No claim is made as to the relationship of the points or lines shown hereon to true boundary locations.*

Sheet 1 of 1  
 File No.: