

Street: TYLER ST.
 7912, T1E
 X-Street: BONITA AVE
 OFFICIAL USE ONLY

2-18-64
 HUBBARD
 STEELE
 WRECCO

TYLER AVE
 of 1300' ties
 CENTER AVE to HOLE.

CRFB
 806/9

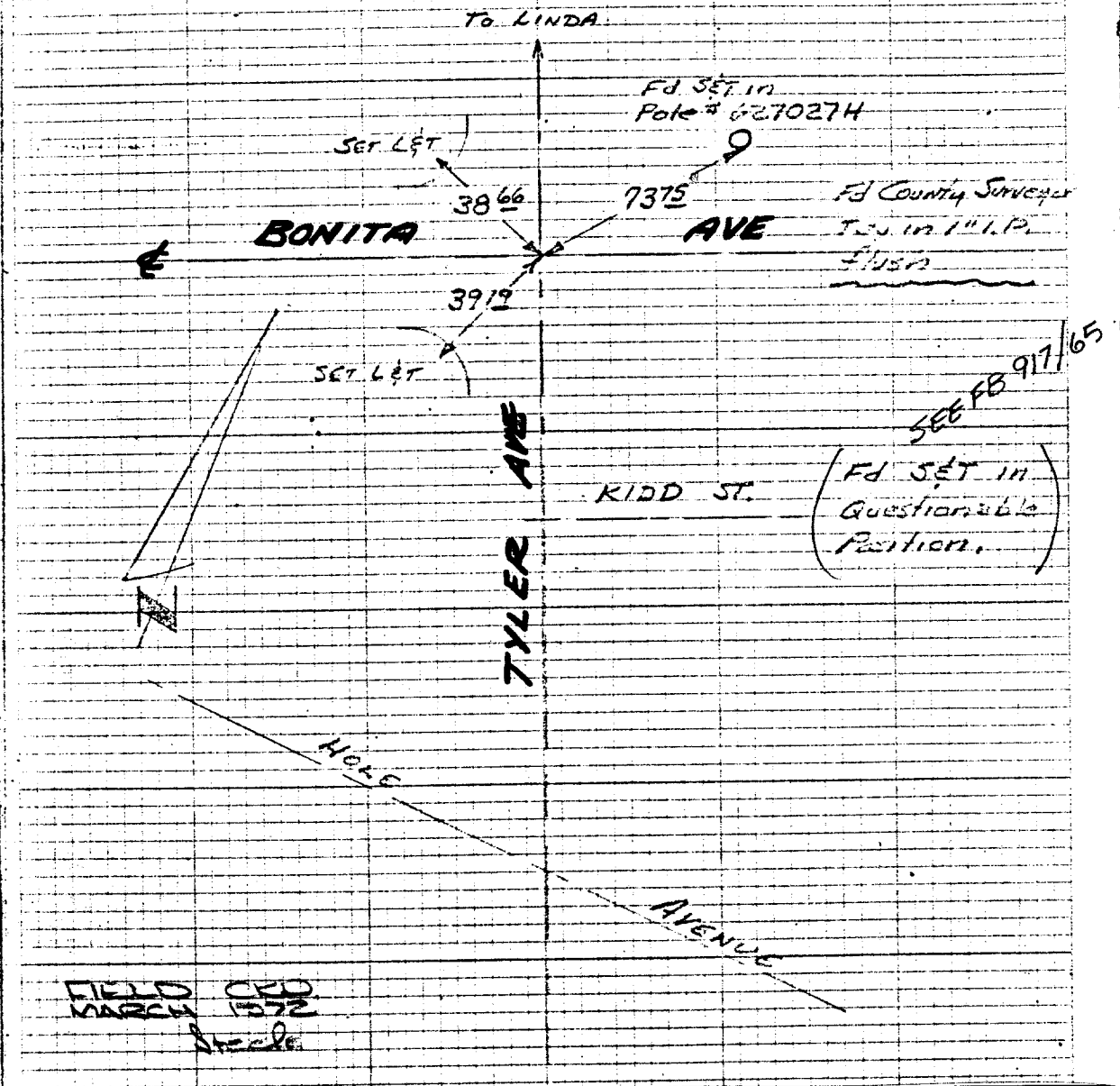

FIELD
 MARCH 1972
 CRFB
 STEELE

- ✕ FD. Ramset Nail on T/C
- FD. LD. & TK. on T/C
- FD. "C" Nail on T/C
- Set LD. & TK. on T/C

Scale:
 Date:
 Drawn by:
 W.O.:
 F.B.:

OFFICIAL TIE PLAT CITY OF RIVERSIDE

These ties are for the purpose of perpetuating the found monumentation. No claim is made as to the relationship of the points or lines shown hereon to true boundary locations.

Sheet 1 of 1
 File No.: