

# SWING TIE

HISTORICAL DATA  
 - J.F.D. Assoc. TIE SHT  
 DATED 4/66 FOR TR 2880  
 - MB 54/41-43

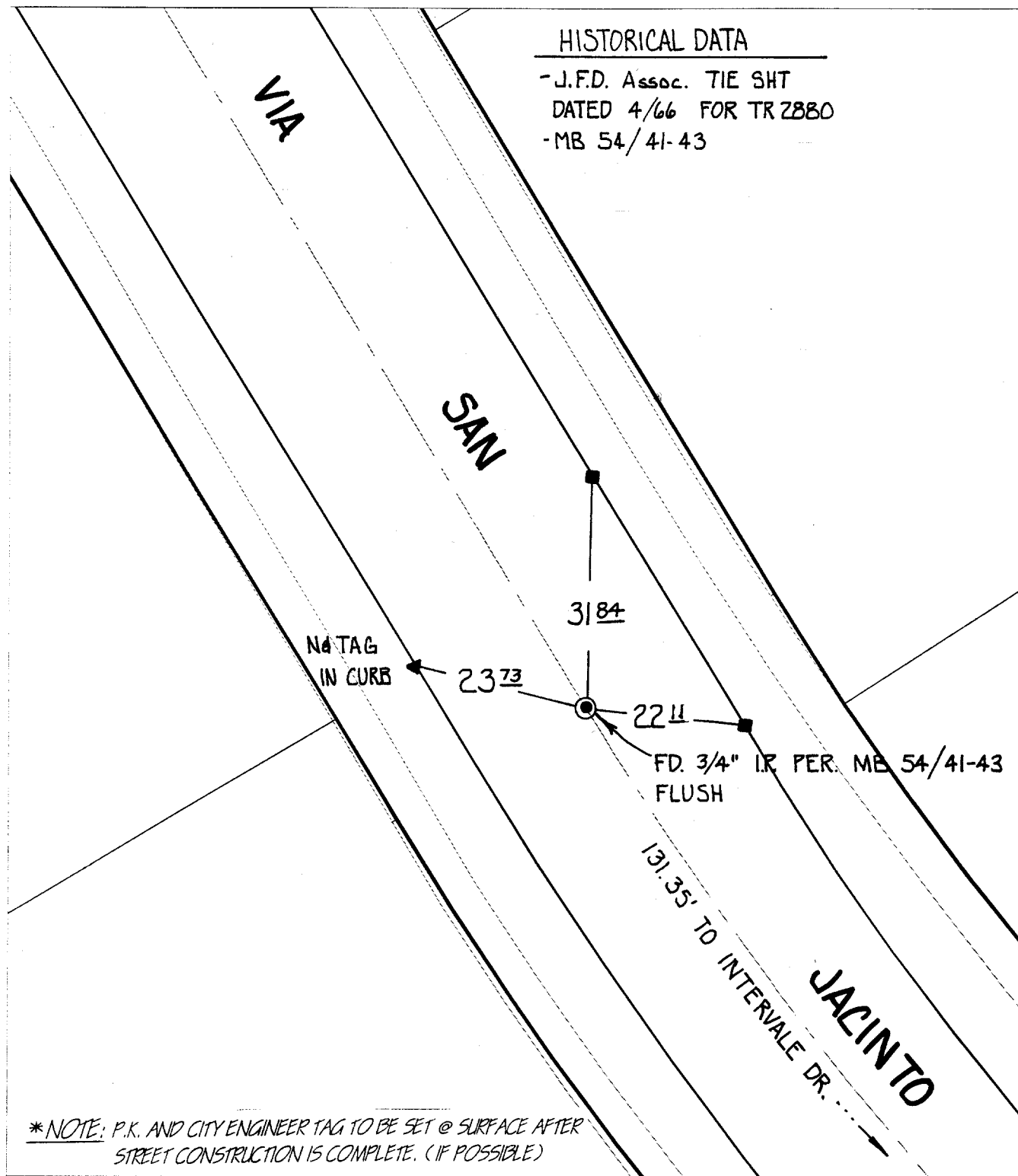

\*NOTE: P.K. AND CITY ENGINEER TAG TO BE SET @ SURFACE AFTER STREET CONSTRUCTION IS COMPLETE. (IF POSSIBLE)

- ✕ FD. Ramset Nail on T/C
- FD. "C" Nail on T/C
- FD. LD. & TK. on T/C
- Set LD. & TK. on T/C

Street: VIA SAN JACINTO  
**8144 TIF**  
 X-Street: EC NW/INTERVALE DR.  
 OFFICIAL USE ONLY

Scale: 1" = 20'  
 Date: 06/14/00  
 Drawn by: SURVEY  
 W.O.:  
 F.B.:

## OFFICIAL TIE PLAT CITY OF RIVERSIDE

*These ties are for the purpose of perpetuating the found monumentation. No claim is made as to the relationship of the points or lines shown hereon to true boundary locations.*



Sheet 1 of 1  
 File No.: