

SURVEY NOTES

Street: VOLTAIRE DRIVE X-Street: SHAKESPEARE
8270.71E OFFICIAL USE ONLY

SURVEY OF Final Mon's (4 Ties) J. F. DAVIDSON ASSOCIATES
 FOR Voltaire Dr TR 20312-1 CIVIL ENGINEERS • SURVEYORS • PLANNERS
 SURVEY PARTY I. Boyd M. Clover W.O.N. 9219 F.B. 9219/612
 REF. DATE 11-19-87 A.M.

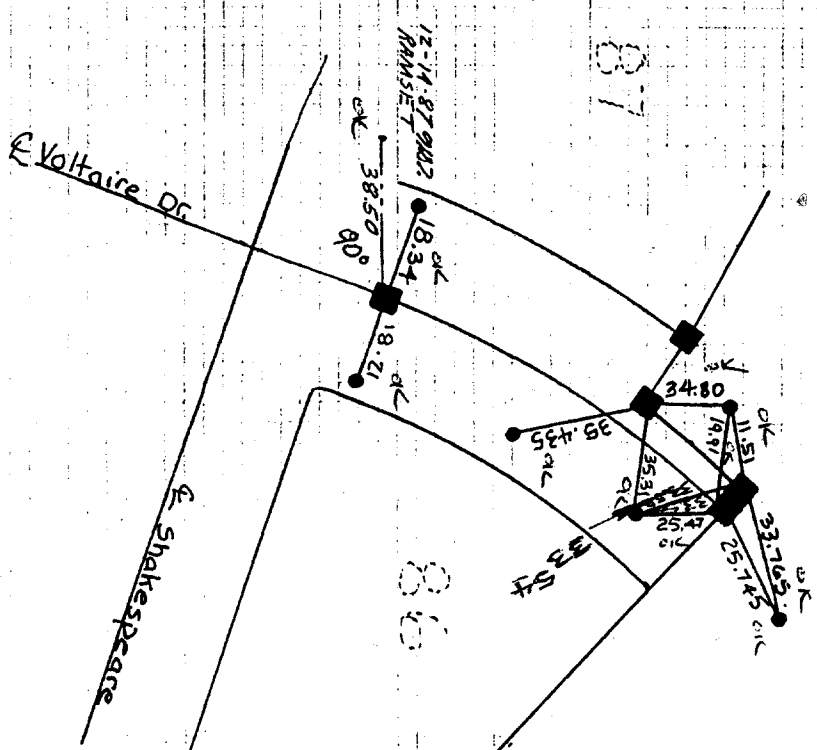

● — indicates set of nail in T/C
 — indicates set of TIF w/plus
 LS 3018 flush
 FD. AS ORDERED



- ✕ FD. Ramset Nail on T/C
- FD. LD. & TK. on T/C
- FD. "C" Nail on T/C
- Set LD. & TK. on T/C

OFFICIAL TIE PLAT CITY OF RIVERSIDE

These ties are for the purpose of perpetuating the found monumentation. No claim is made as to the relationship of the points or lines shown hereon to true boundary locations.

Scale: _____
 Date: _____
 Drawn by: _____
 W.O.: _____
 F.B.: _____

Sheet 1 of 1
 File No.: _____