

Street: VICTORIA AVE
8298.71E

X-Street: GIBSON
OFFICIAL USE ONLY

Swing Ties @ Victoria Ave.

HISTORICAL DATA
FB 221/5
FB 437/27

Field Party
James Y
Grandinette
Russell
FB 878/20
3-13-69

GIBSON @ VICTORIA CREB 878/20
MAR 13, 69

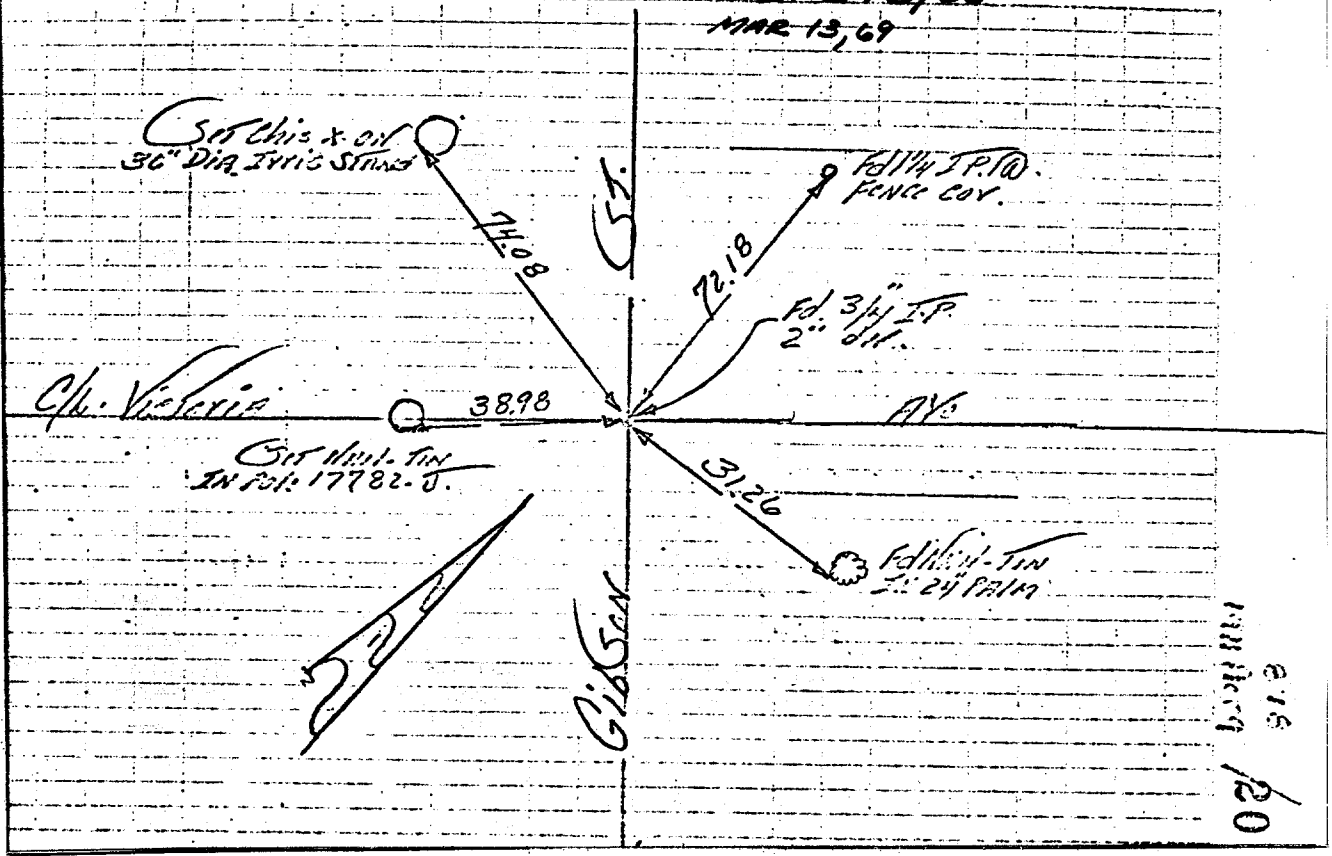

- ✕ FD. Ramset Nail on T/C
- FD. LD. & TK. on T/C
- FD. "C" Nail on T/C
- Set LD. & TK. on T/C

Scale:
Date:
Drawn by:
W.O.:
F.B.: 878/20

OFFICIAL TIE PLAT

CITY OF RIVERSIDE

These ties are for the purpose of perpetuating the found monumentation. No claim is made as to the relationship of the points or lines shown hereon to true boundary locations.

Sheet 1 of 1
File No.: