

Street: **VICTORIA AVE**
8348 T/F

X-Street: **WASHINGTON ST**
 OFFICIAL USE ONLY

WASHINGTON
 AT VICTORIA

HISTORICAL DATA
 LOS RANCHITOS SUB
 MB 26/23
 PLAZA HOMER
 MB 26/23
 FB 739/7
 FB 729/8
 FB 850/12
 FB 851/3
 FB 851/3

NOTE: USE 1/4" FOR ALL
 SURVEYS EXCEPT
 THOSE SITUATED
 WITHIN LOS RANCHITOS
 SUB MB 26/23 USE
 COORD. MDN FG-A FOR
 THIS EXCEPTION. SEE
 FB 739/7 FOR TIES
 9-22-68 BS.

CREW
 STEVENS
 MORGAN
 FREY
 9-22-68
 FB 851/3

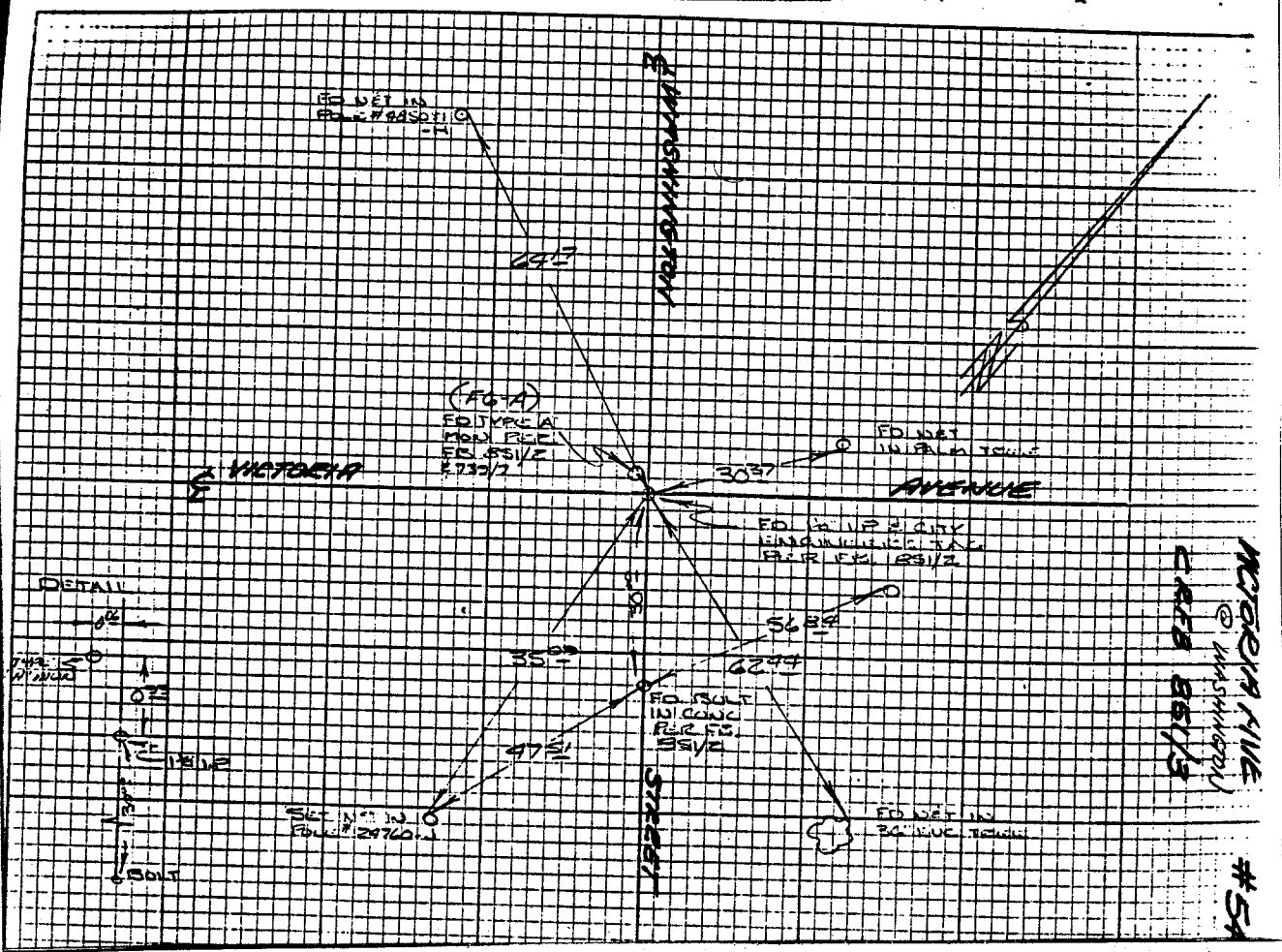

- ✕ FD. Ramset Nail on T/C
- FD. LD. & TK. on T/C
- FD. "C" Nail on T/C
- Set LD. & TK. on T/C

Scale:
 Date: 9, 22, 68
 Drawn by:
 W.O.:
 F.B.: 851/3

OFFICIAL TIE PLAT CITY OF RIVERSIDE

These ties are for the purpose of perpetuating the found
 monumentation. No claim is made as to the relationship of
 the points or lines shown hereon to true boundary locations.

Sheet 1 of 1
 File No.: