

Street: **ARLINGTON AVE**
8368 TIE
 OFFICIAL USE ONLY
 X-Street: **YELLOWSTONE DR.**

Arlington at Yellowstone

F.B. 931-47

Plant
 Corp.
 11/13/51
 March 17, 1971

Transit ties

Historical Data
 The F.B. 1951
 F.B. 514/54
 F.B. 501/59

○ - Indicates set lead & tack
 TOP OF CURB
 ● - Indicates found lead & tack
 TOP OF CURB

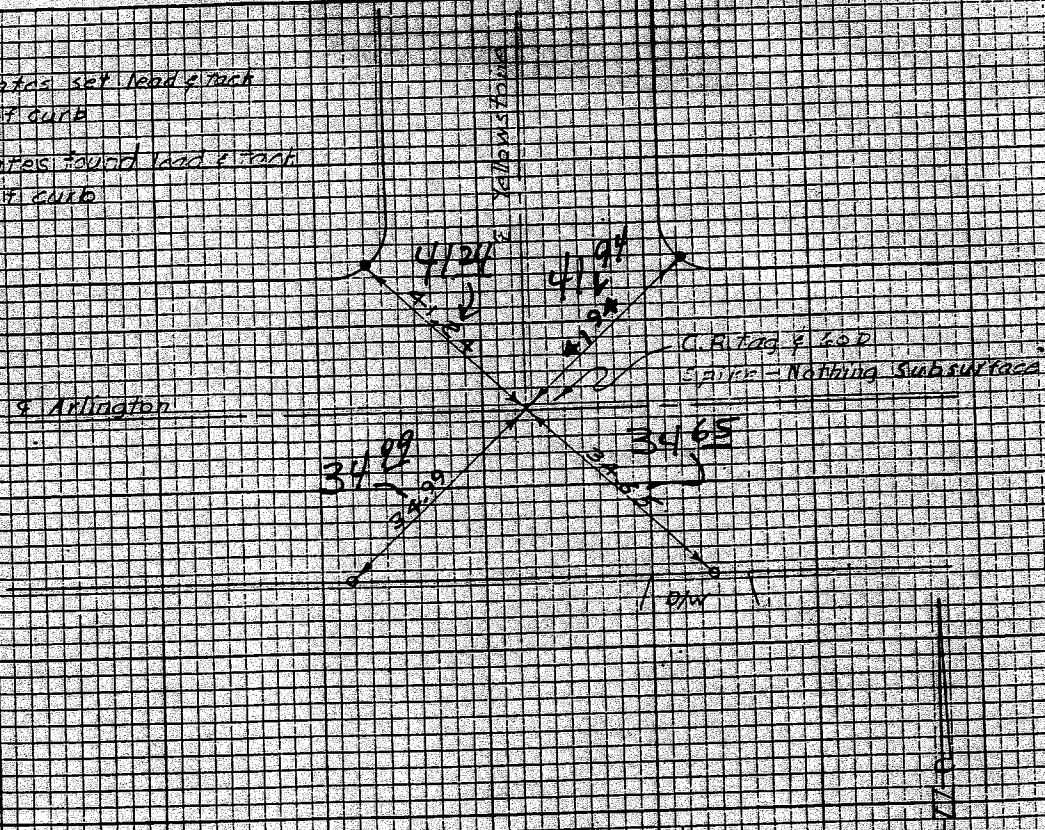

✕ FD. Ramset Nail on T/C
 ■ FD. "C" Nail on T/C

● FD. LD. & TK. on T/C
 ○ Set LD. & TK. on T/C

Scale:
 Date:
 Drawn by:
 W.O.:
 F.B.:

OFFICIAL TIE PLAT
CITY OF RIVERSIDE

These ties are for the purpose of perpetuating the found monumentation. No claim is made as to the relationship of the points or lines shown hereon to true boundary locations.

Sheet 1 of 1
 File No.: