

# TRANSIT TIES

Street: **C-8420.TIF**  
**FOURTEENTH STREET**  
**X-Street: OLIVEWOOD & LIME**  
**OFFICIAL USE ONLY**

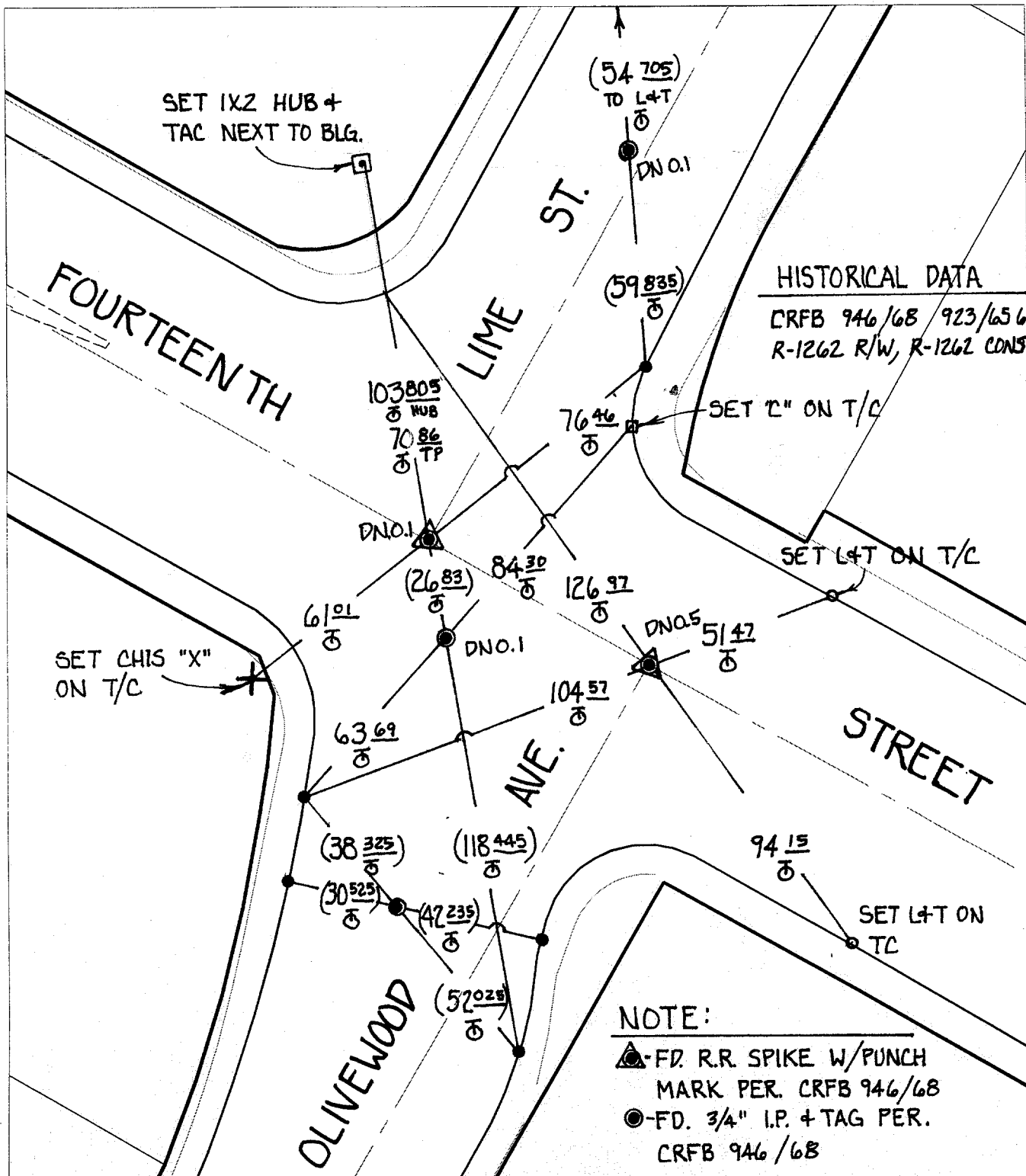

**HISTORICAL DATA**  
 CRFB 946/68 / 923/65 66,  
 R-1262 R/W, R-1262 CONST.

**NOTE:**  
 ▲ - FD. R.R. SPIKE W/PUNCH MARK PER. CRFB 946/68  
 ● - FD. 3/4" I.P. + TAG PER. CRFB 946/68

- ✕ FD. Ramset Nail on T/C    ● FD. LD. & TK. on T/C    P.K. and City Engineer tag to be set @ surface after street construction is complete. (If possible)
- FD. "C" Nail on T/C    ○ Set LD. & TK. on T/C

Scale: 1" = 40'  
 Date: 11/28/00  
 Drawn by: SURVEY  
 W.O.:  
 F.B.:

**OFFICIAL TIE PLAT**  
**CITY OF RIVERSIDE**

*These ties are for the purpose of perpetuating the found monumentation. No claim is made as to the relationship of the points or lines shown hereon to true boundary locations.*

Sheet 1 of 1  
 File No.: