

# SWING TIES

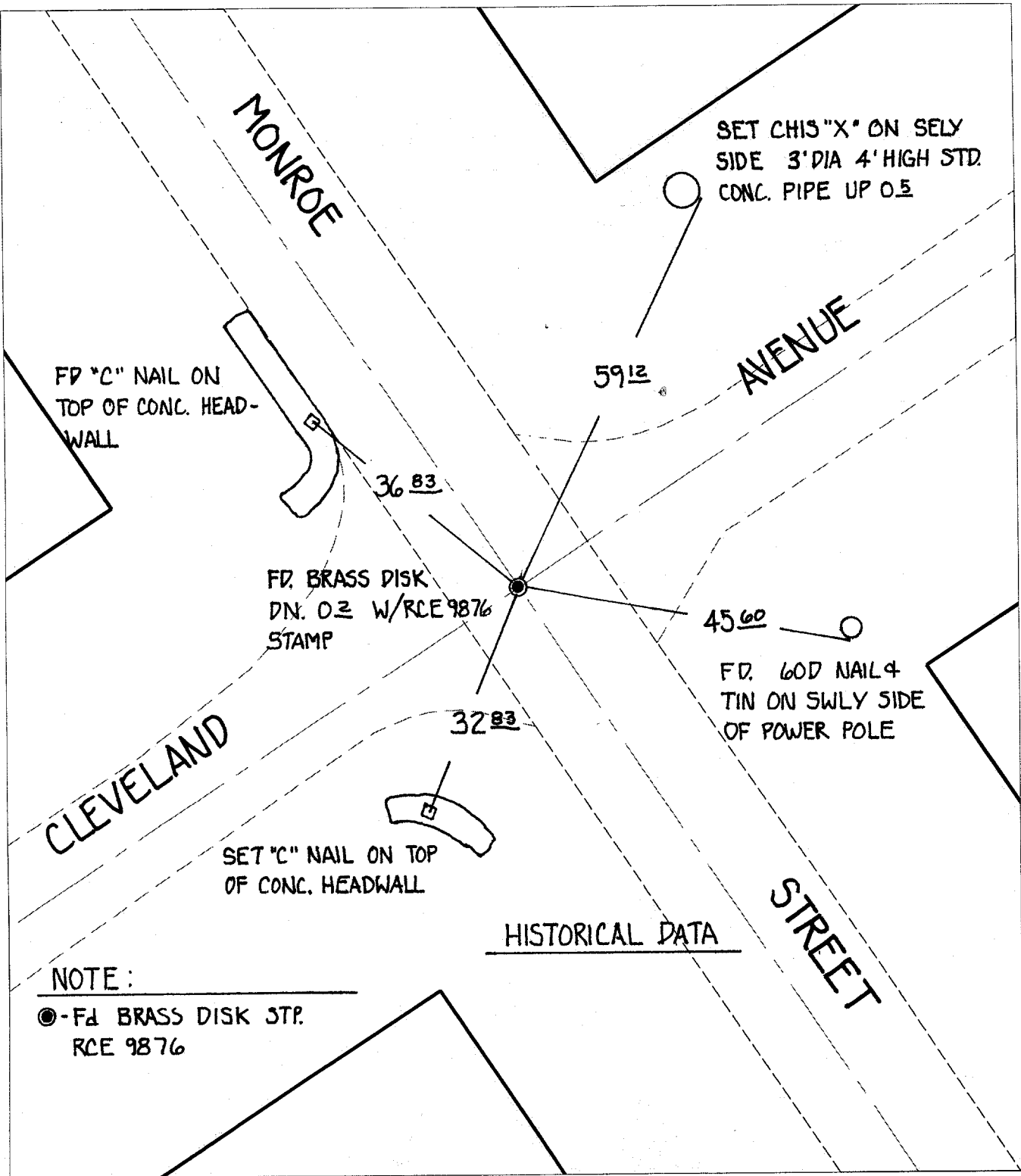

Street: 8421 TIF  
 MONROE STREET  
 X-Street: CLEVELAND AVENUE  
 OFFICIAL USE ONLY

**NOTE:**

● - FD BRASS DISK STP. RCE 9876

- ✕ FD. Ramset Nail on T/C
- FD. LD. & TK. on T/C
- FD. "C" Nail on T/C
- Set LD. & TK. on T/C

*P.K. and City Engineer tag to be set @ surface after street construction is complete. (If possible)*

Scale: 1" = 20'

Date: 12/29/00

Drawn by: SURVEY

W.O.:

F.B.:

## OFFICIAL TIE PLAT

### CITY OF RIVERSIDE



*These ties are for the purpose of perpetuating the found monumentation. No claim is made as to the relationship of the points or lines shown hereon to true boundary locations.*

Sheet 1 of 1

File No.: