

SWING TIES

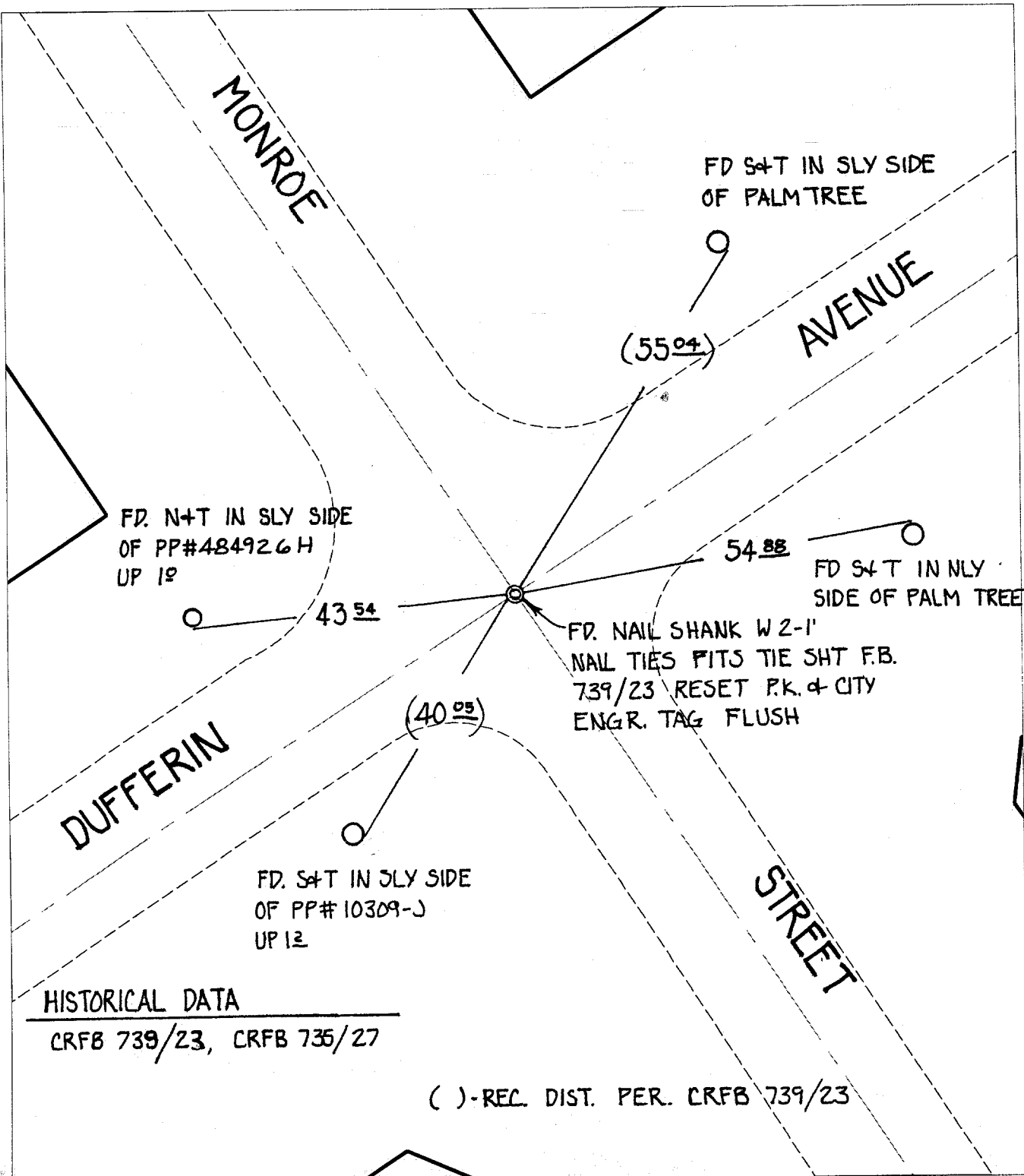

Street: **8462 TIF** MONROE STREET
 X-Street: DUFFERIN AVENUE
 OFFICIAL USE ONLY

HISTORICAL DATA

CRFB 739/23, CRFB 735/27

() - REC. DIST. PER. CRFB 739/23

- ✕ FD. Ramset Nail on T/C ● FD. LD. & TK. on T/C P.K. and City Engineer tag to be set @ surface after street construction is complete. (If possible)
- FD. "C" Nail on T/C ○ Set LD. & TK. on T/C

Scale: 1" = 20'
 Date: 10/16/00
 Drawn by: SURVEY
 W.O.:
 F.B.:

OFFICIAL TIE PLAT CITY OF RIVERSIDE

These ties are for the purpose of perpetuating the found monumentation. No claim is made as to the relationship of the points or lines shown hereon to true boundary locations.



Sheet 1 of 1
 File No.: