

HISTORICAL DATA

MB 4/56
FB 222/6
FB 403/45/46
FB 718/20
FB 752/21
MB 9/2 SECO

TRANSIT: 9 SWING TIES

CRFB 1007/9

IVY ST.
BET MYRTLE
AND ROCKLEDGE

JULY 22 1977

THORP
MONTAGUE
GARCIA

Street: **IVY ST.**
8571. TIF

X-Street: **ELY OF ROCKLEDGE DR.**
OFFICIAL USE ONLY

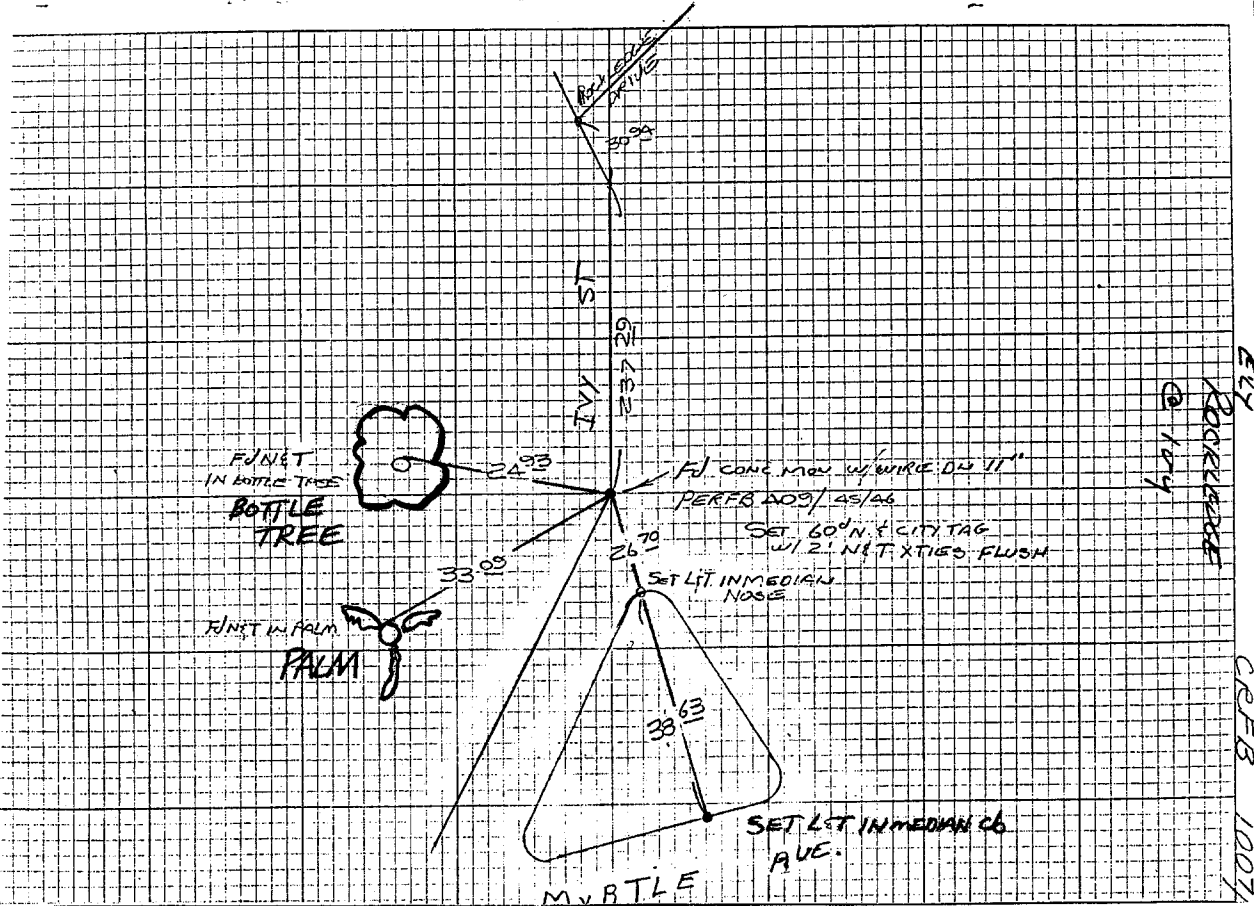

× FD. Ramset Nail on T/C
■ FD. "C" Nail on T/C

● FD. LD. & TK. on T/C
○ Set LD. & TK. on T/C

Scale:

Date:

Drawn by:

W.O.:

F.B.:

OFFICIAL TIE PLAT

CITY OF RIVERSIDE

These ties are for the purpose of perpetuating the found monumentation. No claim is made as to the relationship of the points or lines shown hereon to true boundary locations.

Sheet 1 of 1

File No.: