

Street: WESTERLY DRIVE 8667 TIE X-Street: SILVERCREST LANE
 OFFICIAL USE ONLY

SURVEY NOTES WESTERLY DR. & SILVERCREST LK.

TRACT 20393-3



J.F. Davidson Associates, Inc.
 ARCHITECTURE ENGINEERING PLANNING SURVEYING
 LANDSCAPE ARCHITECTURE

FB. 1/20/71

SURVEY OF 4 TIES
 FOR Tie 20393-3 Valley Drive WO. No. 91-12040 Date 4.30.73
 SURVEY PARTY BARBARA THELWELL REF. AM.
SHEET 2 OF 4 SHEETS

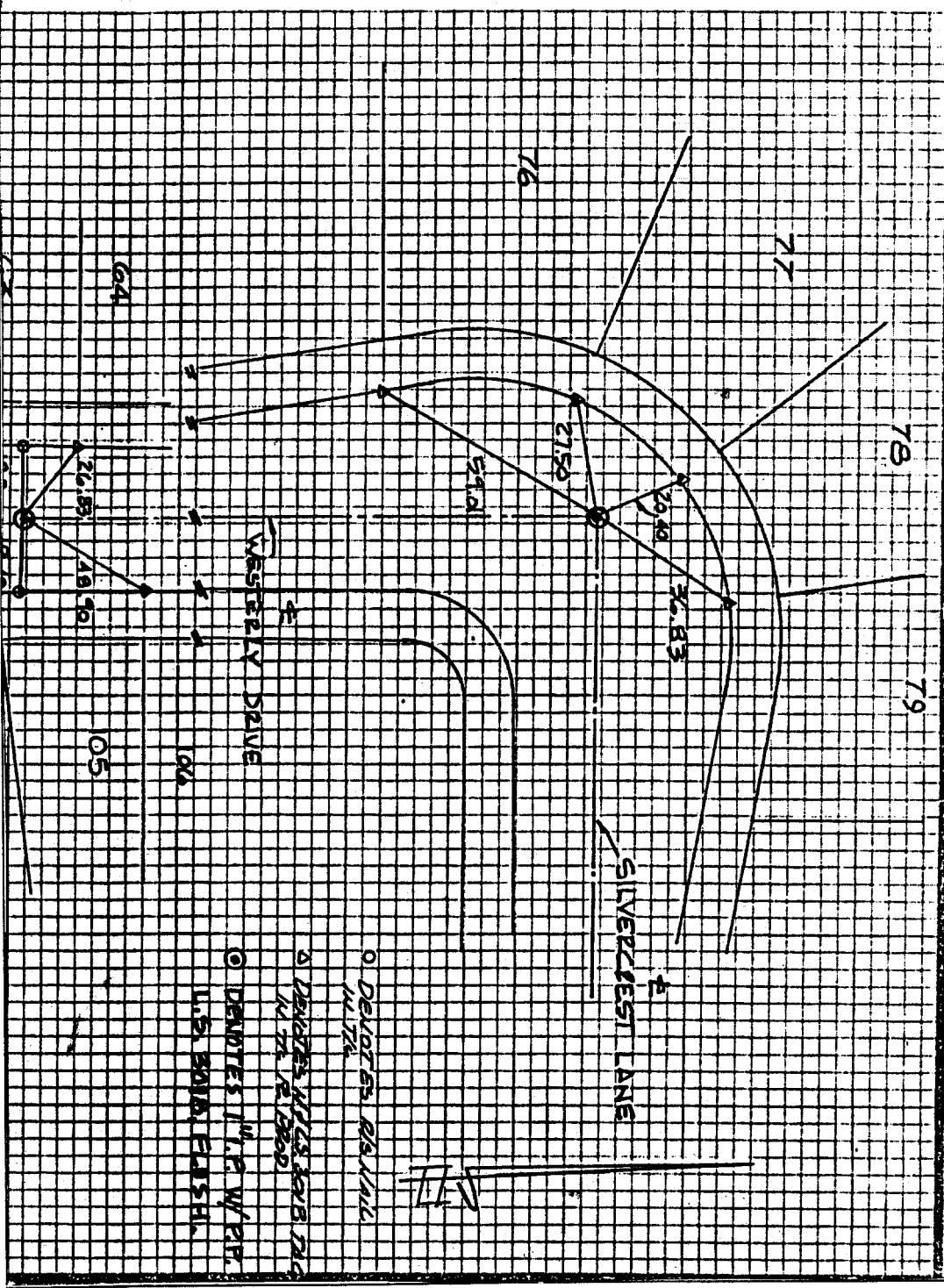

- ✕ FD. Ramset Nail on T/C
- FD. LD. & TK. on T/C
- FD. "C" Nail on T/C
- Set LD. & TK. on T/C

Scale:
 Date:
 Drawn by:
 W.O.:
 F.B.:

OFFICIAL TIE PLAT
 CITY OF RIVERSIDE

These ties are for the purpose of perpetuating the found monumentation. No claim is made as to the relationship of the points or lines shown hereon to true boundary locations.

Sheet 1 of 1
 File No.: