

Street: WEST PORT ST.  
**8703 TIF**  
 X-Street:  
 OFFICIAL USE ONLY

SURVEY NOTES & TIES

J.F. DAVIDSON ASSOCIATES

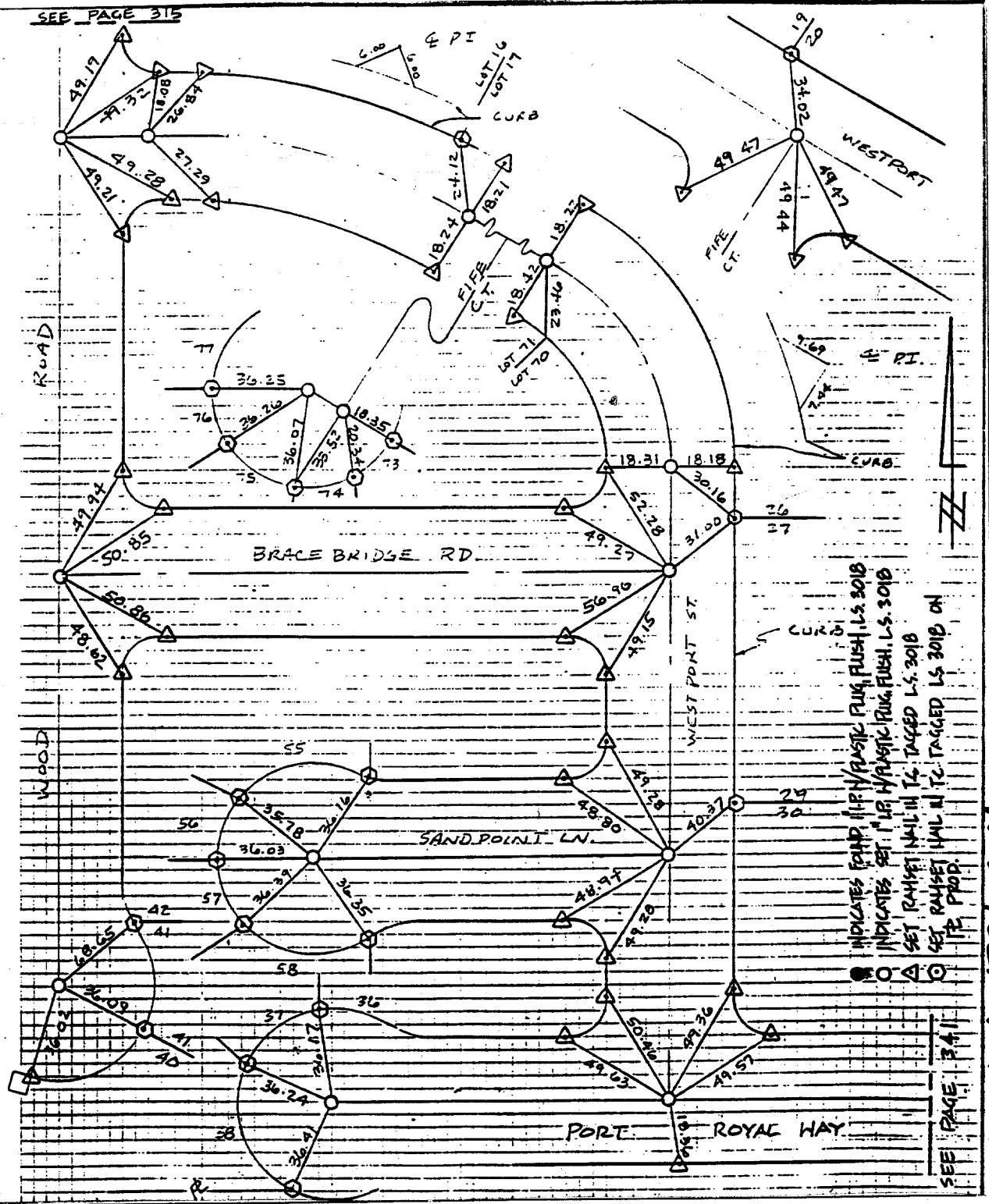

INDICATES FOUND IRON/BRASS PLUG FLUSH L.S. 3018  
 INDICATES SET IRON/BRASS PLUG FLUSH L.S. 3018  
 SET RAMSET NAIL IN T.C. TAGGED L.S. 3018 ON  
 SET RAMSET NAIL IN T.C. TAGGED L.S. 3018 ON  
 TIF PROP.

SEE PAGE 341

- × FD. Ramset Nail on T/C
- FD. LD. & TK. on T/C
- FD. "C" Nail on T/C
- Set LD. & TK. on T/C

Scale:  
 Date:  
 Drawn by:  
 W.O.:  
 F.B.: 9767/377

**OFFICIAL TIE PLAT**  
**CITY OF RIVERSIDE**

*These ties are for the purpose of perpetuating the found monumentation. No claim is made as to the relationship of the points or lines shown hereon to true boundary locations.*

TRACT 214 03-3

Sheet 1 of 1  
 File No.: