

SURVEY OF E TIES TR. 21875

SHEET 1 OF 1 SHEET

FOR HUBBARD

W.O. No. 11371

Date 1-13-91

SURVEY PARTY FRAYZ

REF.

A.M.

Street: WHISTLER WAY
8734 TIE

OFFICIAL USE ONLY

X-Street: B.C., E.C., & CUL-DE-SAC

SURVEY NOTES

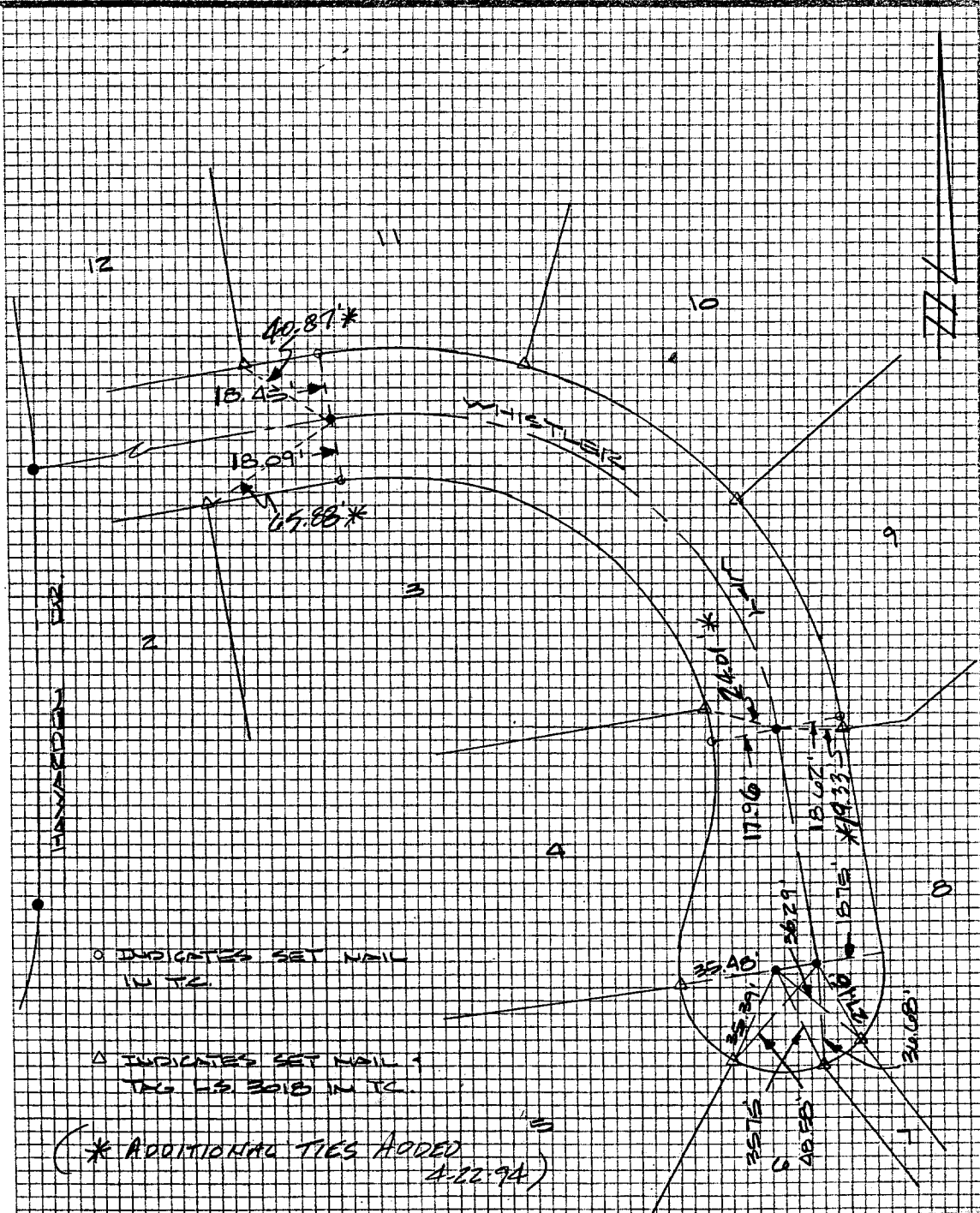

○ INDICATES SET NAIL IN TC

△ INDICATES SET NAIL IN TC LS 3018 IN TC

(* ADDITIONAL TIES ADDED 4-22-94)

× FD. Ramset Nail on T/C
■ FD. "C" Nail on T/C

● FD. LD. & TK. on T/C
○ Set LD. & TK. on T/C

Scale:

Date:

Drawn by:

W.O.:

F.B.:

OFFICIAL TIE PLAT

CITY OF RIVERSIDE

These ties are for the purpose of perpetuating the found monumentation. No claim is made as to the relationship of the points or lines shown hereon to true boundary locations.

Sheet 1 of 1

File No.: